

SC-SSE041028-128-WW-24

# ULTRA-NARROW NEON

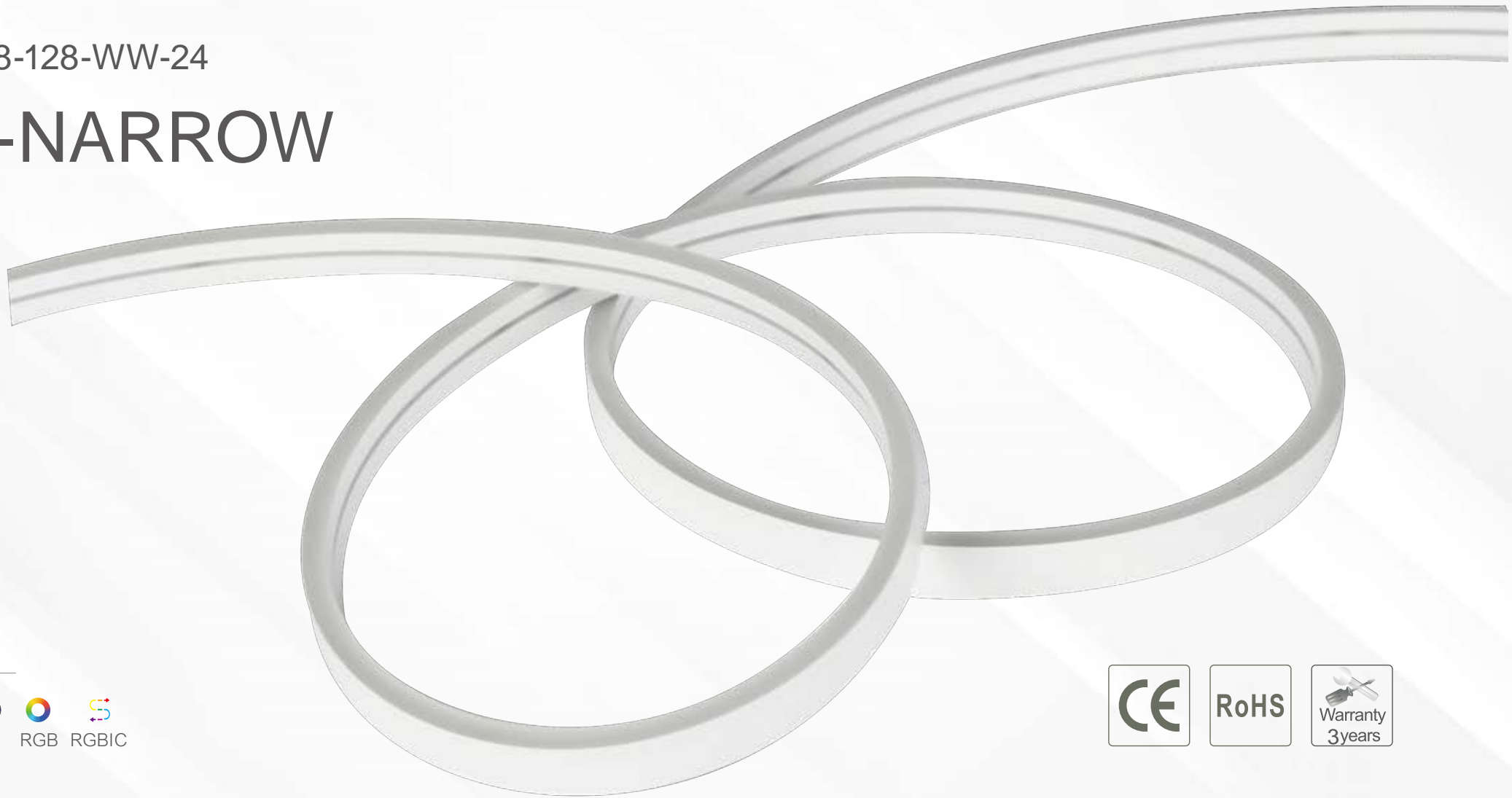

Available colors



## Ultra-narrow

Dimension: 4×10mm, suitable for ultra-narrow spaces

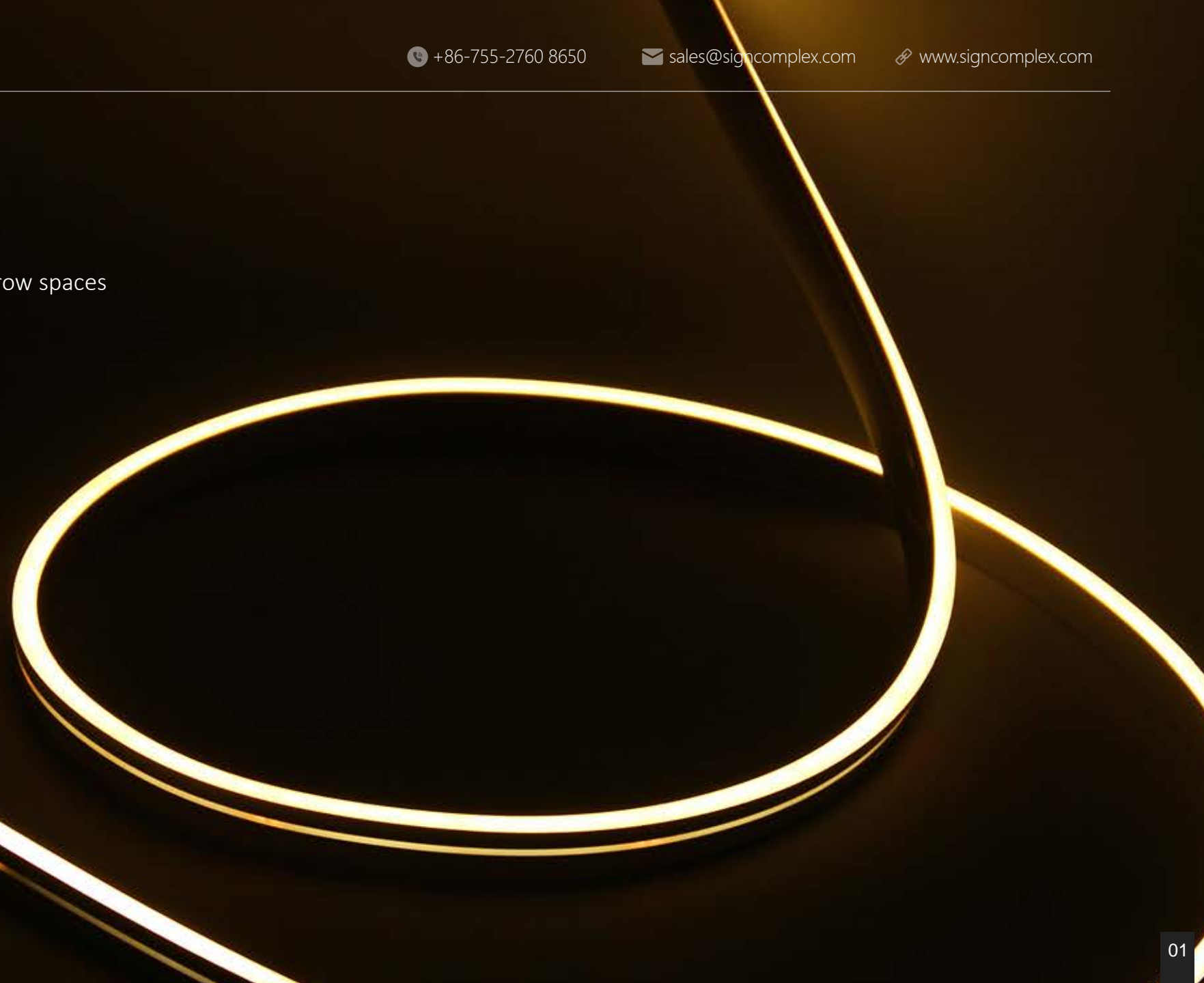
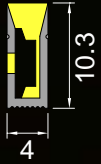

## Soft Light

---

Various LEDs are available, more uniform luminescence.  
No light dot can be seen even in close distance, soft light.

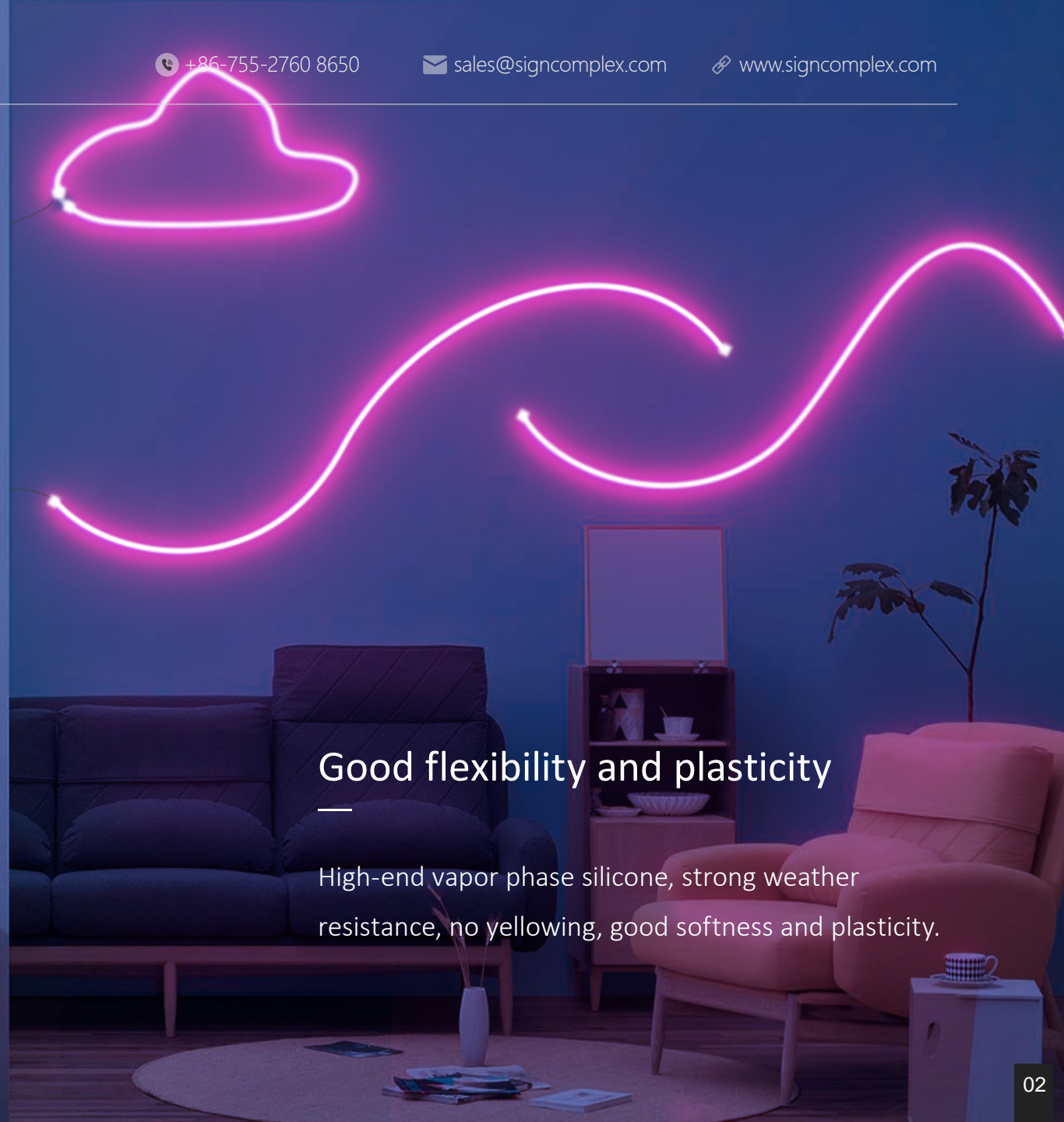

## Good flexibility and plasticity

---

High-end vapor phase silicone, strong weather resistance, no yellowing, good softness and plasticity.

## Waterproof and safer application

---

The product has passed CE, RoHS and other certifications, good waterproof effect, safer application.

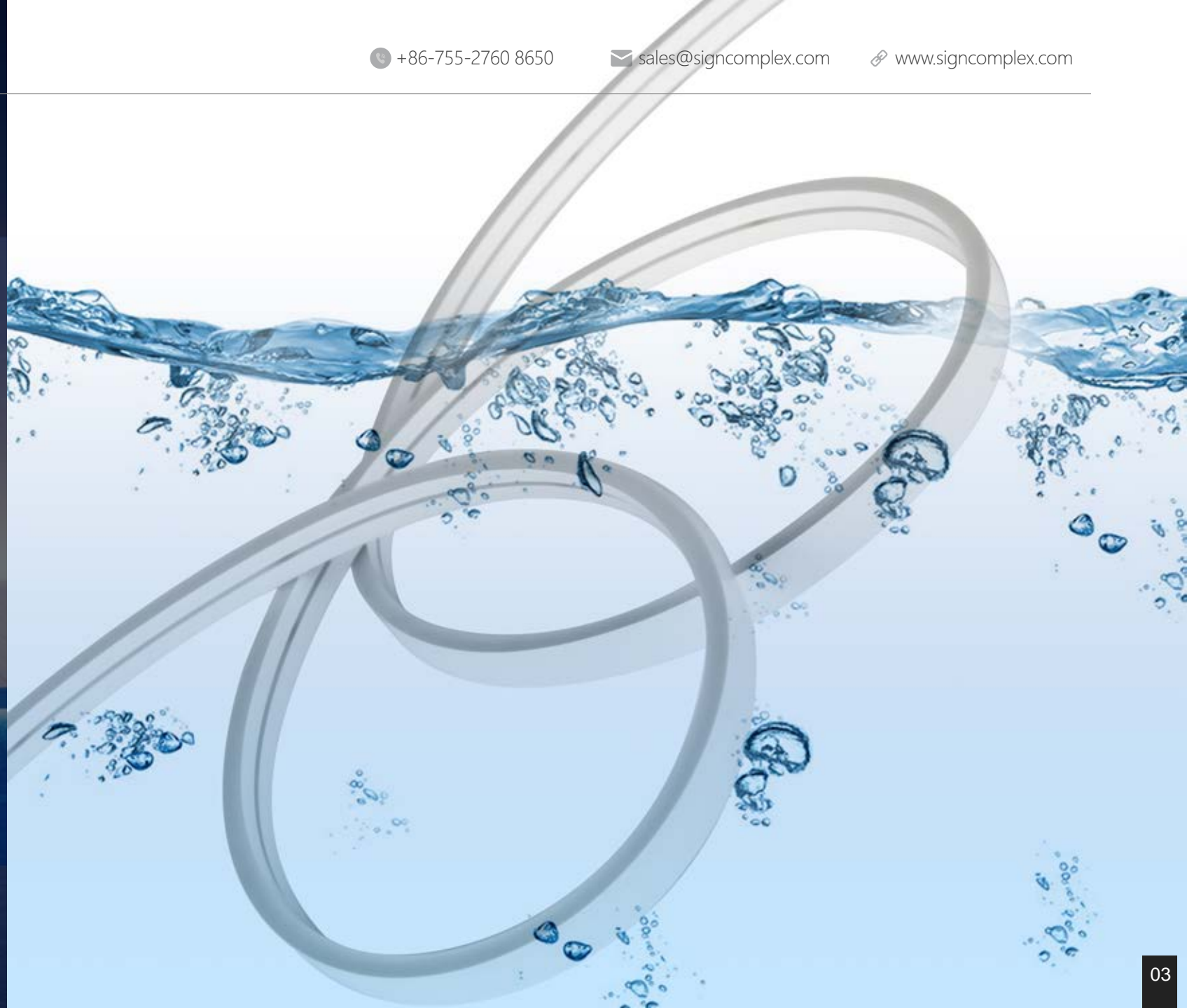



## Application

Widely used in hotels, shopping malls, furniture, cabinets, bookshelves, as decorative lighting, direct lighting or indirect lighting.

# PARAMETER

Model	Wave Length & CCT Range(for LED only)		Luminous Flux (lm/M)	CRI	LED Type	LED Qty. (PCS/M)	Rated Watt (w/m)	DC Voltage (V)	Max.Length (M)	Min.Length (mm)	PCB Width	IP	Beam angle (degree)
SC-XX-128-XX-24	WW	2800-3200K	257	80	2835	128	7.7	24	5	62.5	6	65	120
	NW	3800-4500K	299										
	W	6000-6500K	333										
	R	620-630nm	\	\									
	G	515-530nm											
	G	460-470nm											

## ACCESSORIES

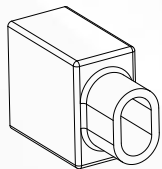

**End cap with hole**  
2pcs/5M

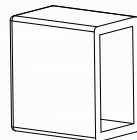

**End cap without hole**  
2pcs/5M

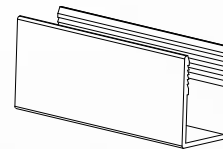

**Mounting clip**  
20pcs/5M

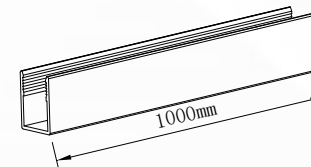

**Mounting Channel**  
optional

## DIMENSIONS (unit: mm)

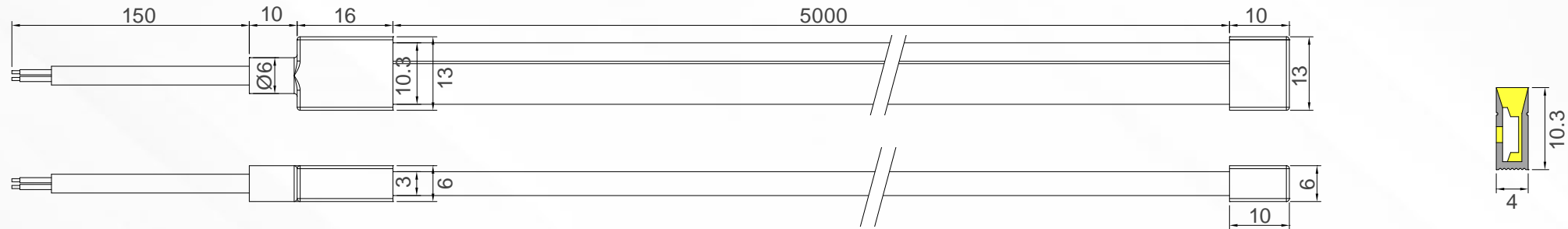

## INSTALLATION DIAGRAM

### Installation operation

1. Fix the clip in the place where the neon flex installed, as shown in Figure 1.

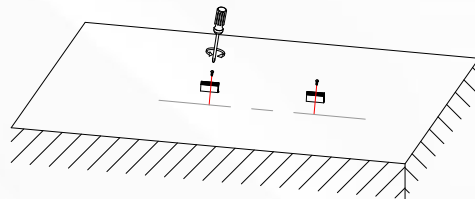

Figure 1

2. Install the neon flex into the clip, the installation is complete, as shown in Figure 2.

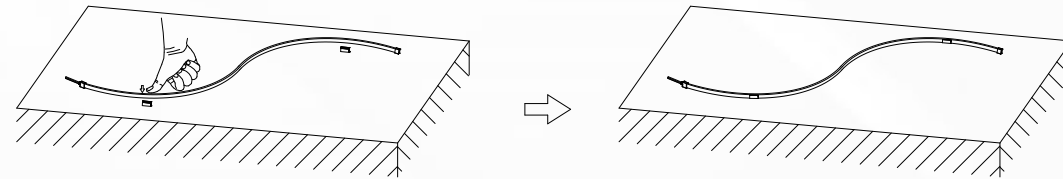

Figure 2

## Installation operation

1. Cut along the cutting line with scissors, as shown in Figure 3.

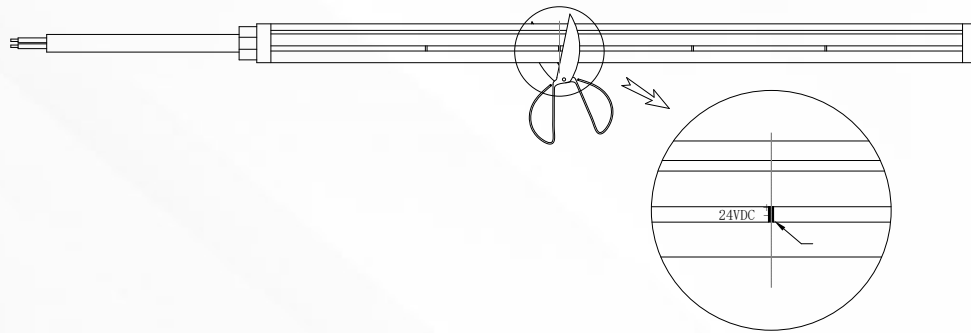

Figure 3

2. The plug will be filled with glue, and put the neon flex into the plug, the installation is complete, as shown in Figure 4.

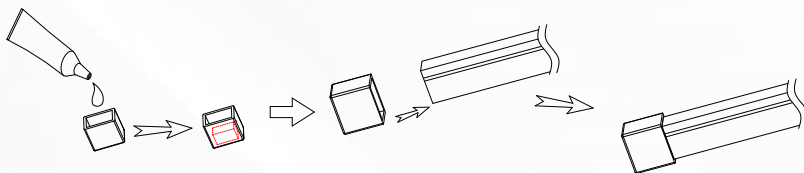

Figure 4

3. Cut off the adhesive on the back of the PCB to reveal the welding points, as shown in Figure 5.

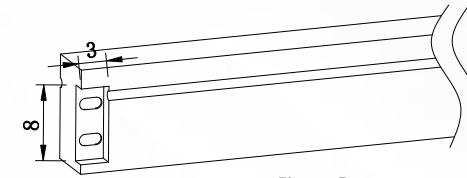

Figure 5

4. Use the soldering iron to solder the wire, as shown in Figure 6.

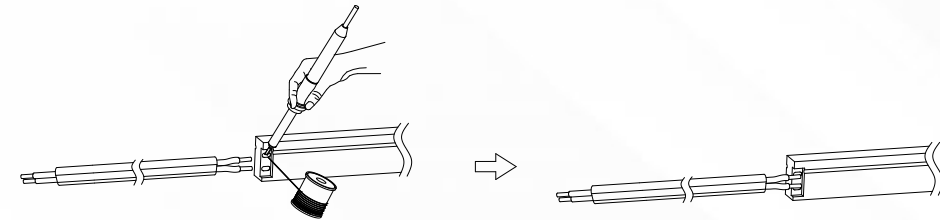

Figure 6

5. Put the plug encased into the line, and repeat Figure 4 gluing steps, and then insert the neon flex into the plug, the installation is complete, as shown in Figure 7.

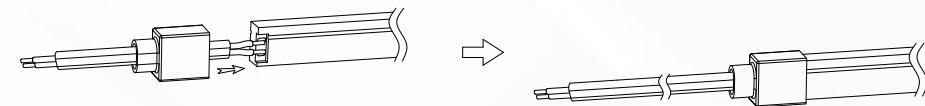
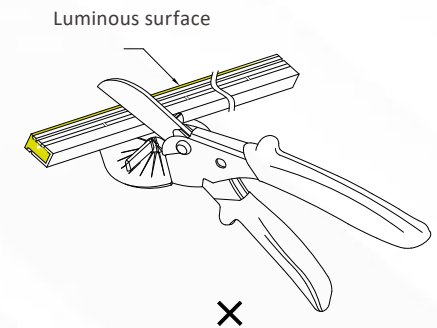
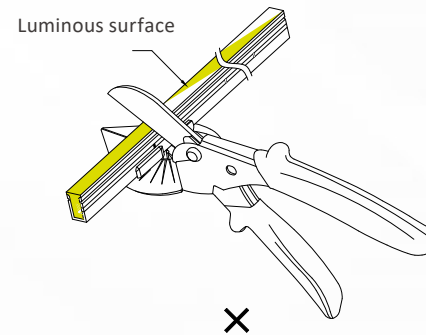
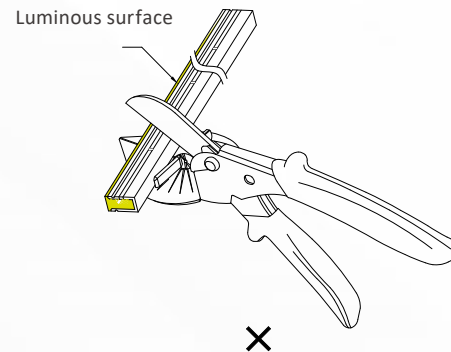
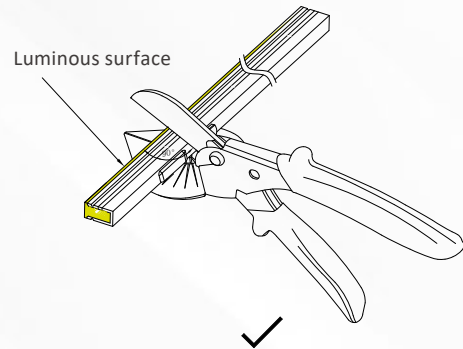
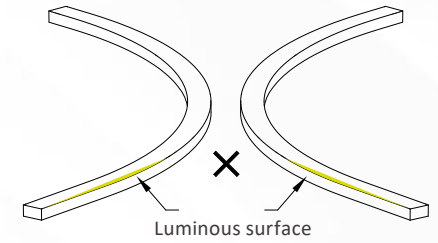
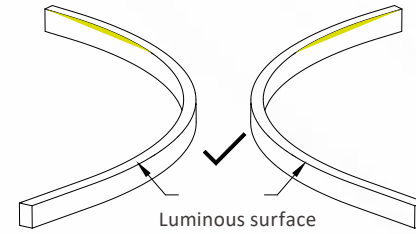
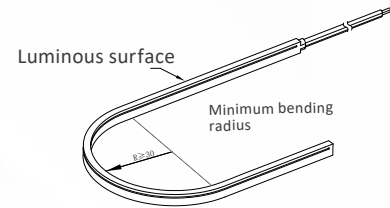
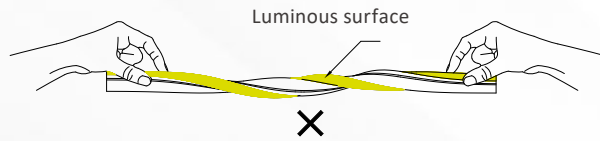

Figure 7



### Bending direction and bending radius



## PACKAGING INFORMATION

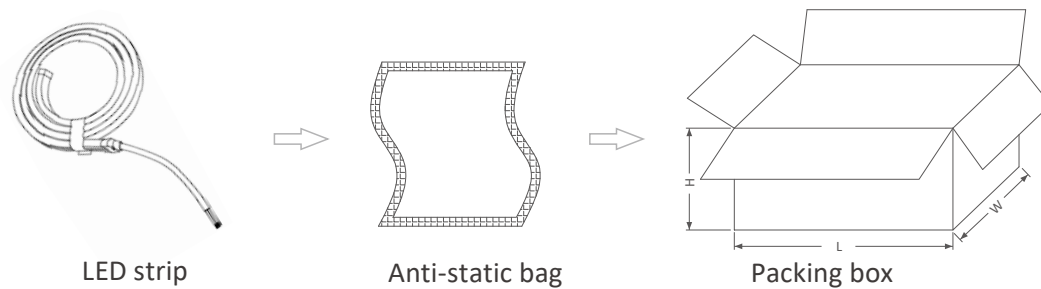

LED strip	Anti-static bag		Packing Box	
Part Number	Gross Weight per Reel	QTY per Carton	Gross Weight	Size(cm/inch)
SC-SSE041028-128-WW-24	0.098KG	50	13.25KG	59cm*32.5cm*21.1cm 23.23"*12.79"*8.3"

## INSTALLATION REQUIREMENT



- ⦿ The LED strip and accessories can't be squeezed or folded.
- ⦿ PCB conductive parts can't be damaged when installation.
- ⦿ Installation must conform to electrical safety standard. The LED strip can only be installed by professionals.
- ⦿ Ensure power supply transform operating load with transformer.
- ⦿ When install on metal or conductor surface, insulation protection need to be provided to the contact area.
- ⦿ Observe positive and negative polarity, ensure correct connection to avoid damaging LED strip.
- ⦿ When installation, please prevent static electricity.
- ⦿ The product need anti-corrosion environment, such as, avoiding damp, water drop or other adverse elements.