

SC-2835-08-TS0818W-XX-160-24-10-IP67

SIDE-EMITTING NEON

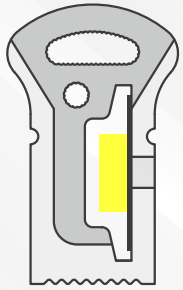

Available colors



Transparent
Cutting Line



Three-color silicone

Using high quality eco-friendly silicone brings high light transmission performance

Side-emitting

Side-emitting, Super flexible bending performance. Bending radius: $R \geq 30$

$R \geq 30$

Soft Light

More uniform luminescence. No light dot can be seen even in close distance, soft light.



Side emitting

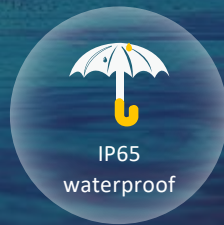

IP65 waterproof



UV Resistant



Easy installation

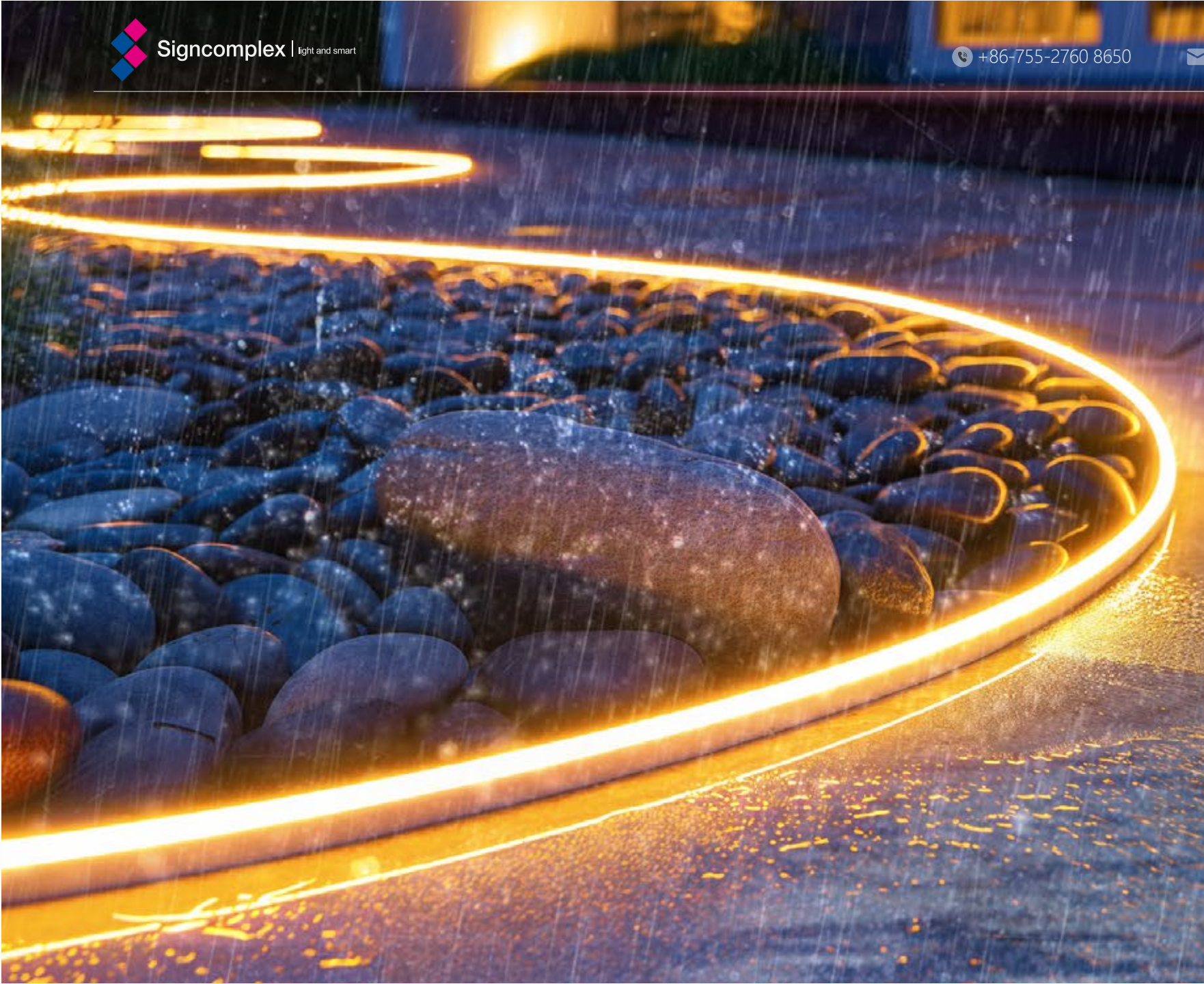

IP65 Waterproof



Application

Widely used in hotels, shopping malls, furniture, cabinets, bookshelves, as decorative lighting, direct lighting or indirect lighting.

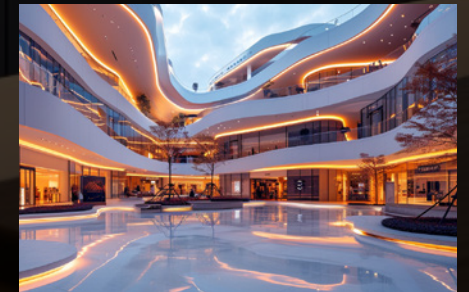

PARAMETER

Model	Wave Length & CCT Range(for LED only)	Luminous Flux (lm/M)	CRI	LED Type	LED Qty. (PCS/M)	Rated Watt (w/m)	DC Voltage (V)	Max.Length (M)	Min.Length (mm)	PCB Width (mm)	IP	Beam angle (degree)	
SC-2835-08-TS0818W-XX-160-24-10-IP67	WW	2800-3200K	399	2835	160	9.6	24	5	50	10	65	160	
	NW	3800-4500K	426										80
	W	6000-6500K	480										
	R	620-630nm											
	G	515-530nm	\										\
	B	460-470nm											

DIMENSIONS (unit: mm/inch)

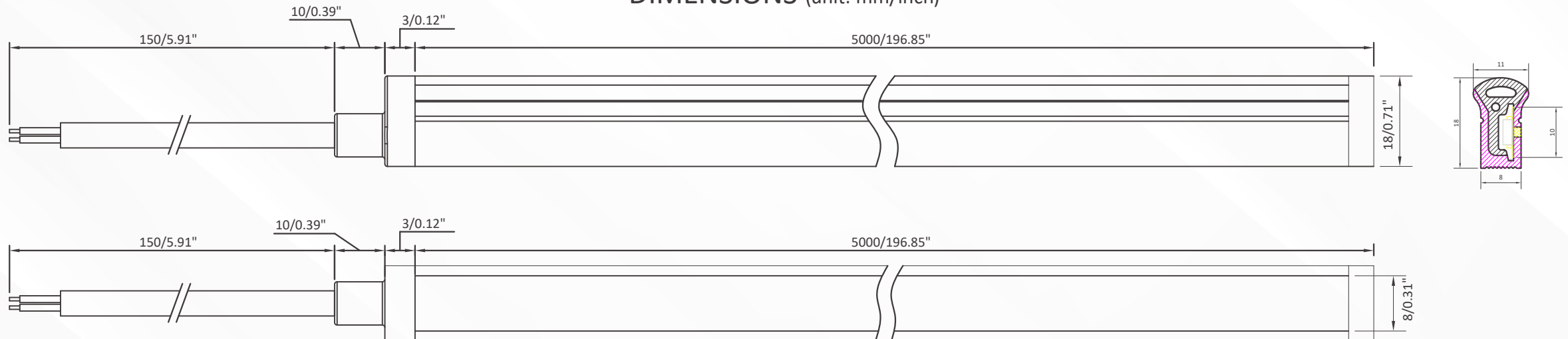

INSTALLATION OPERATION

ACCESSORIES



End cap with hole
2pcs/5M



End cap without hole
2pcs/5M

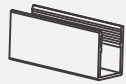

Mounting clip
20pcs/5M

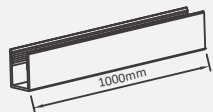

Mounting Channel
optional

1. Cut along the cutting line with scissors, as shown in Figure 1.

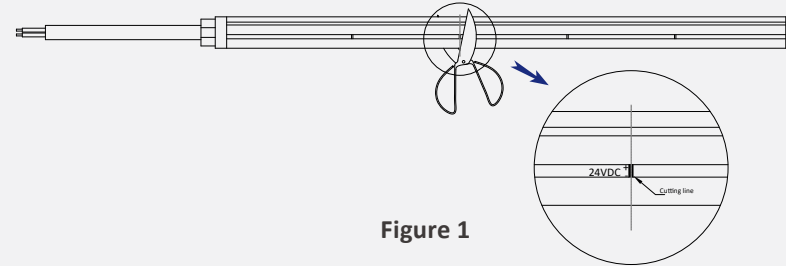

Figure 1

2. Fill the plug with glue, and put the neon flex into the plug, installation completed, as shown in Figure 2.

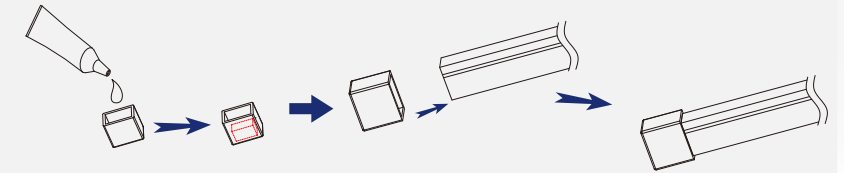

Figure 2

3. Cut off the adhesive on the back of the PCB to reveal the welding points, as shown in Figure 3.



Figure 3

4. Use the soldering iron to solder the wire, as shown in Figure 4.

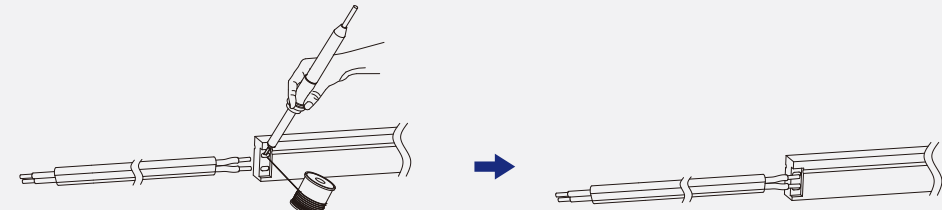

Figure 4

5. Put the wire encased into the plug, and repeat Figure 2 gluing steps, and then insert the neon flex into the plug, installation completed, as shown in Figure 5.



Figure 5

INSTALLATION DIAGRAM

Installation operation

1. Fix the clip in the place where the neon flex installed, as shown in Figure 1.

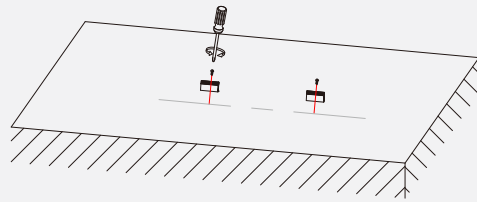

Figure 1

2. Install the neon flex into the clip, the installation is complete, as shown in Figure 2.

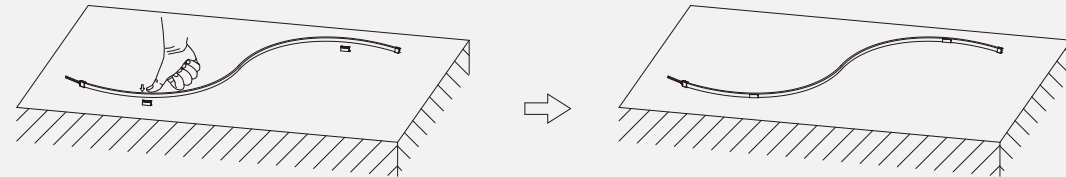
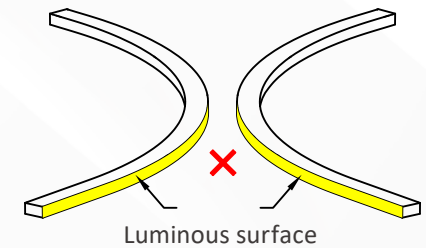
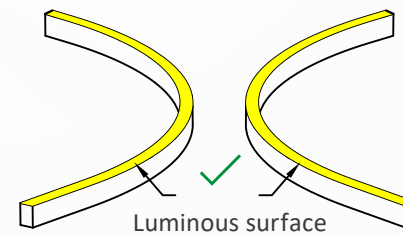
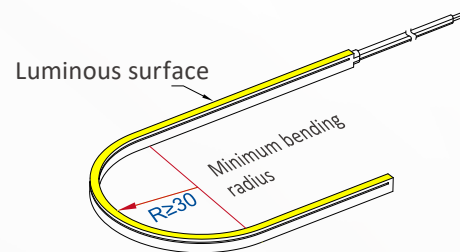
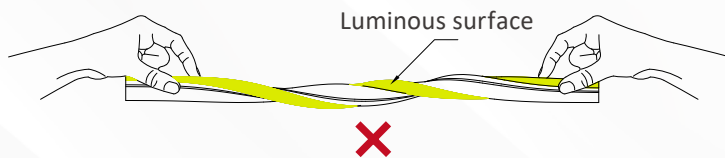
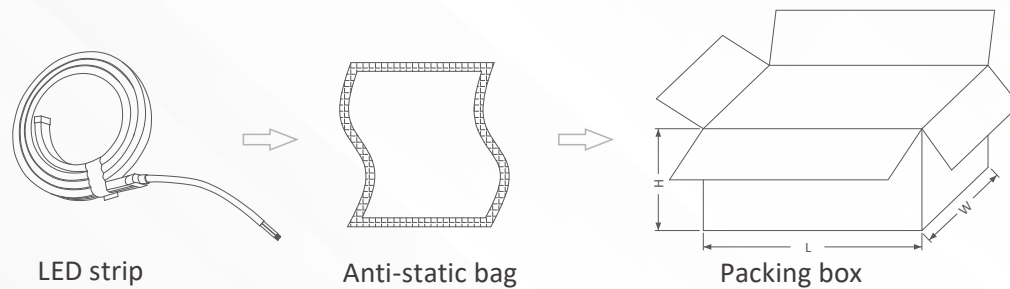

Figure 2

Bending direction and bending radius



PACKAGING INFORMATION



LED strip	Anti-static bag		Packing Box	
Part Number	Gross Weight per Reel	QTY per Carton	Gross Weight	Size(cm/inch)
SC-2835-08-TS0818W-XX-160-24-10-IP67	0.728KG	40	19.6KG	59cm*32.5cm*21.1cm 23.33"*12.79"*8.3"

INSTALLATION REQUIREMENT



- ⦿ The LED strip and accessories can't be squeezed or folded.
- ⦿ PCB conductive parts can't be damaged when installation.
- ⦿ Installation must conform to electrical safety standard. The LED strip can only be installed by professionals.
- ⦿ Ensure power supply transform operating load with transformer.
- ⦿ When install on metal or conductor surface, insulation protection need to be provided to the contact area.
- ⦿ Observe positive and negative polarity, ensure correct connection to avoid damaging LED strip.
- ⦿ When installation, please prevent static electricity.
- ⦿ The product need anti-corrosion environment, such as, avoiding damp, water drop or other adverse elements.