

SC-2219-06-JS0307W-XX-12-240-4-IP65

SIDE-EMITTING NEON

Available colors



S I D E - E M I T T I N G N E O N

Three-color silicone

Using high quality eco-friendly silicone brings high light transmission performance

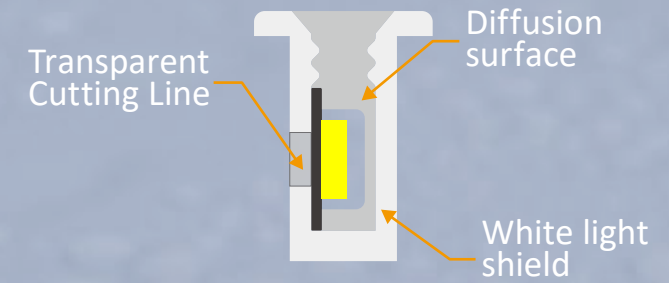

Ultra-narrow:
3x7mm

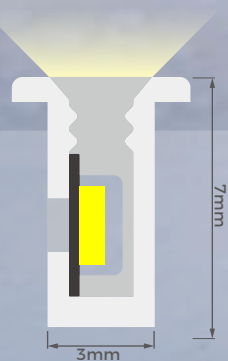

Soft Light

More uniform luminescence. No light dot can be seen even in close distance, soft light.

Side-emitting

Side-emitting, Super flexible bending performance. Bending radius: $R \geq 30$



Recessed installation

Side-emitting limit size, compact design,
anti-bending



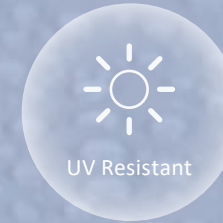

IP65 Waterproof

IP65 waterproof grade, good waterproof effect, safer application

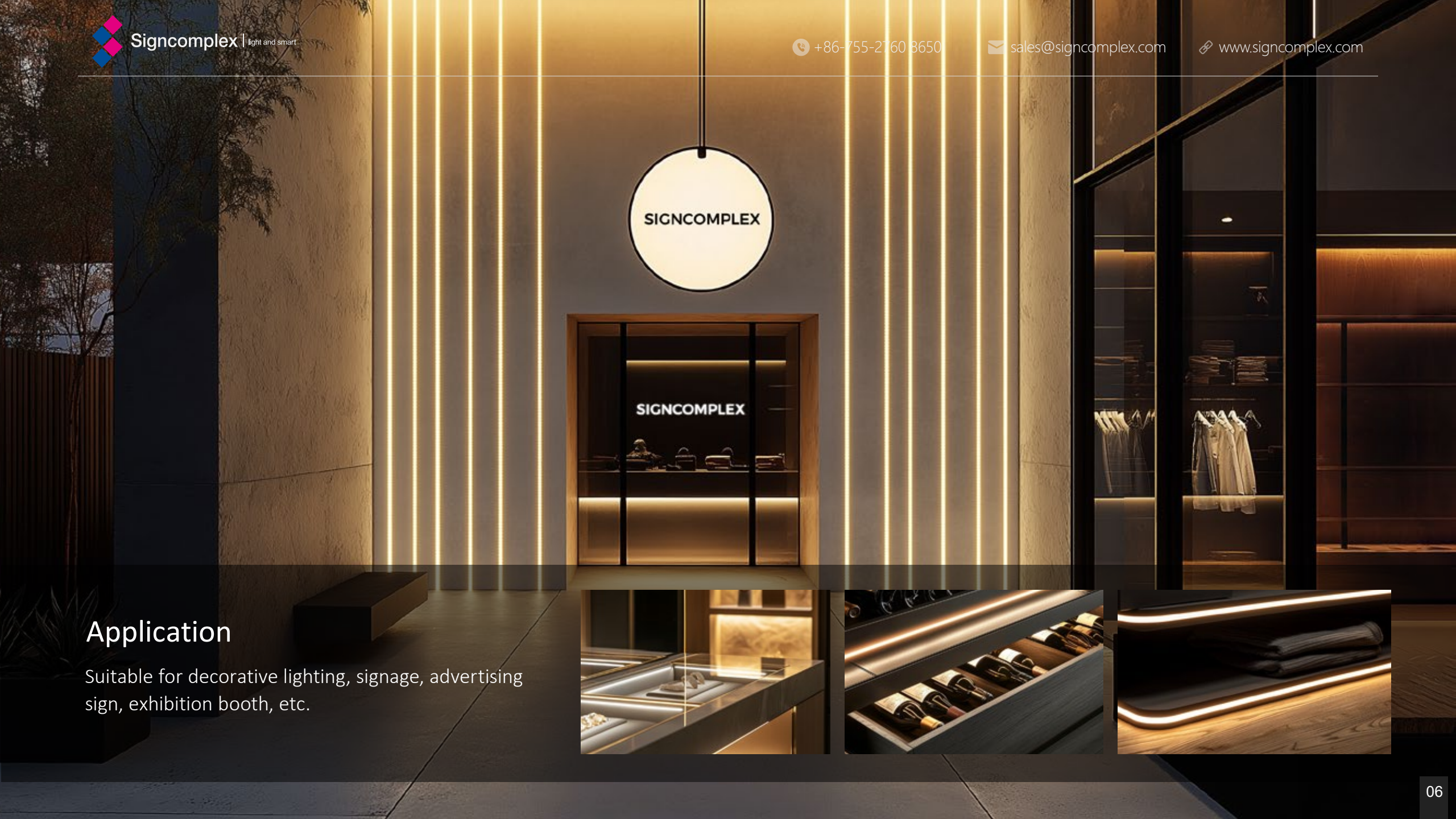

Application

Suitable for decorative lighting, signage, advertising sign, exhibition booth, etc.



PARAMETER

Model	Wave Length & CCT Range(for LED only)		Luminous Flux (lm/M)	CRI	LED Type	LED Qty. (PCS/M)	Rated Watt (W/M)	DC Voltage (V)	Max.Length (M)	Min.Length (mm)	PCB Width (mm)	IP	Beam angle (degree)
SC-2219-06-JS0307W -XX-12-240-4-IP65	WW	2800-3200K	432	80	2219	240	6	24	5	25	4	65	120
	NW	3800-4500K	432										
	W	6000-6500K	449										
	R	620-630nm	\	\									
	G	515-530nm											
	B	460-470nm											

DIMENSIONS (unit: mm/inch)

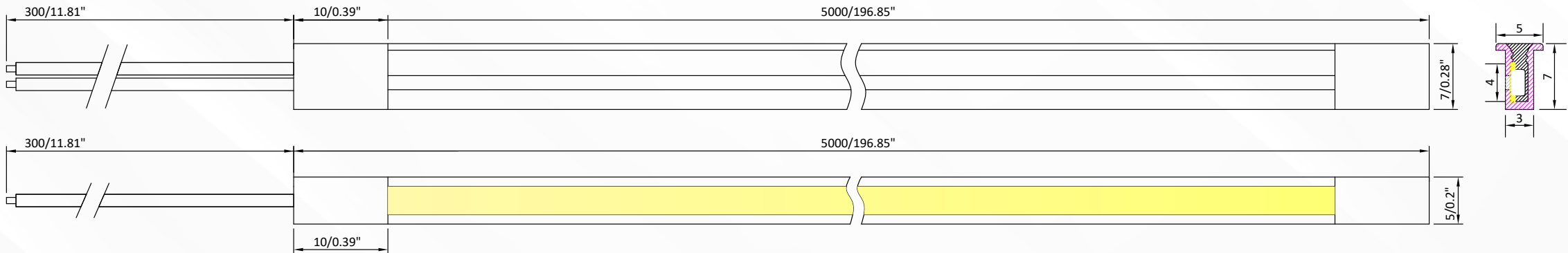

INSTALLATION OPERATION

ACCESSORIES

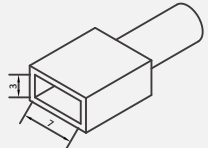

End cap with hole
2pcs/5M

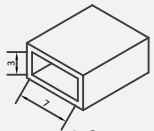

End cap without hole
2pcs/5M

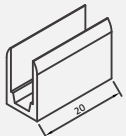

Mounting clip
20pcs/5M

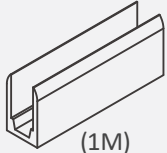

Mounting Channel
(1M)
optional

1. Cut along the cutting line with scissors, as shown in Figure 1.

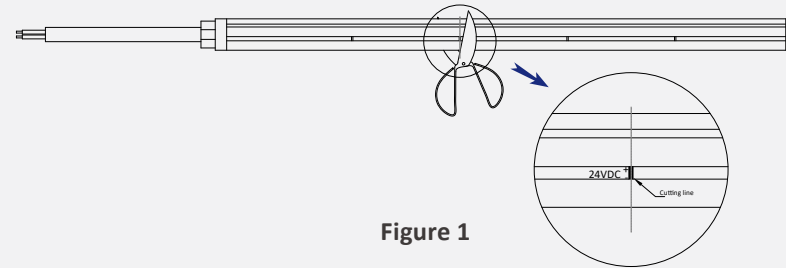

Figure 1

2. Fill the plug with glue, and put the neon flex into the plug, installation completed, as shown in Figure 2.

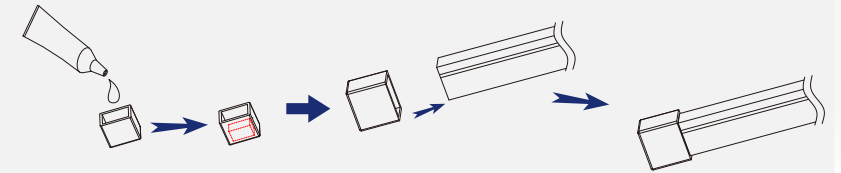

Figure 2

3. Cut off the adhesive on the back of the PCB to reveal the welding points, as shown in Figure 3.



Figure 3

4. Use the soldering iron to solder the wire, as shown in Figure 4.

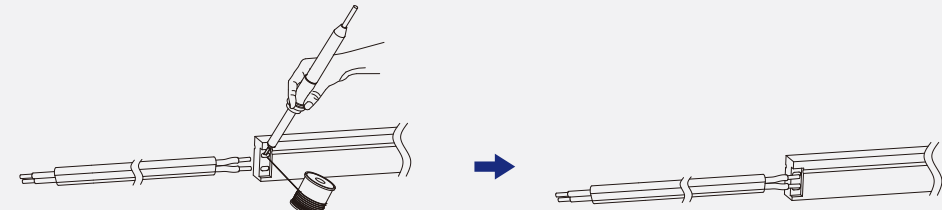

Figure 4

5. Put the wire encased into the plug, and repeat Figure 2 gluing steps, and then insert the neon flex into the plug, installation completed, as shown in Figure 5.



Figure 5

INSTALLATION DIAGRAM

Installation operation

1. Fix the clip in the place where the neon flex installed, as shown in Figure 1.

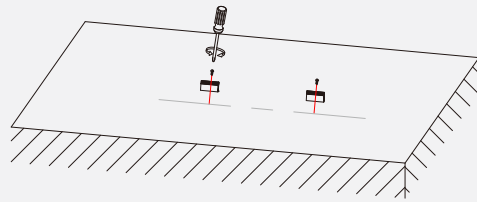

Figure 1

2. Install the neon flex into the clip, the installation is complete, as shown in Figure 2.

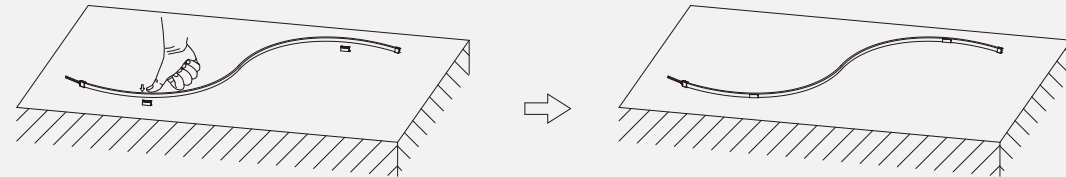
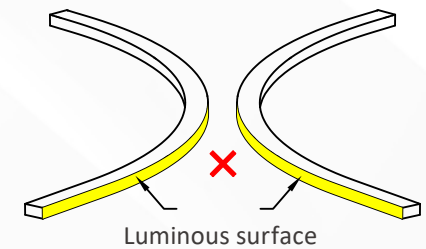
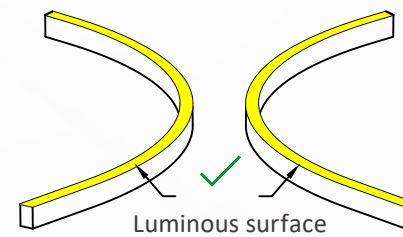
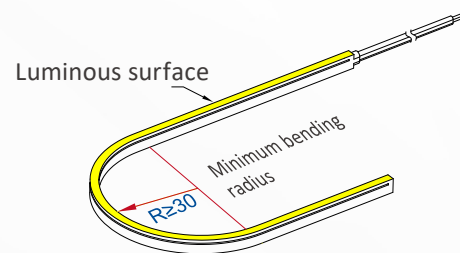
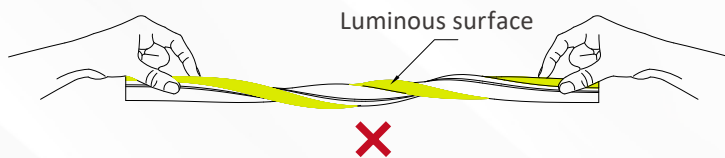
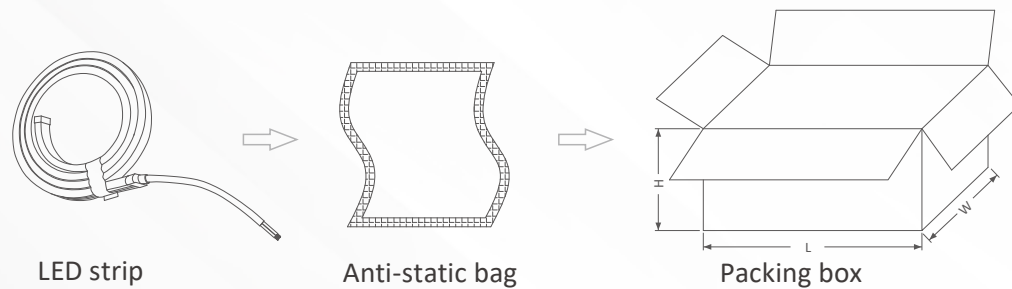

Figure 2

Bending direction and bending radius



PACKAGING INFORMATION



LED strip	Anti-static bag		Packing Box	
Part Number	Gross Weight per Reel	QTY per Carton	Gross Weight	Size(cm/inch)
SC-2219-06-JS0307W-XX-12-240-4-IP65	0.21KG	100	21KG	59cm*32.5cm*21.1cm 23.33"*12.79"*8.3"

INSTALLATION REQUIREMENT



- ⦿ The LED strip and accessories can't be squeezed or folded.
- ⦿ PCB conductive parts can't be damaged when installation.
- ⦿ Installation must conform to electrical safety standard. The LED strip can only be installed by professionals.
- ⦿ Ensure power supply transform operating load with transformer.
- ⦿ When install on metal or conductor surface, insulation protection need to be provided to the contact area.
- ⦿ Observe positive and negative polarity, ensure correct connection to avoid damaging LED strip.
- ⦿ When installation, please prevent static electricity.
- ⦿ The product need anti-corrosion environment, such as, avoiding damp, water drop or other adverse elements.