



Smart LED Slim Panel Light

-WiFi Controlled Version



16 Million Colors



Warm White to Daylight



works with
amazon alexa



works with
Google Assistant

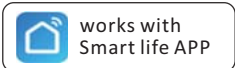

works with
Smart life APP



works with
Siri Shortcuts





Application

Meets kinds of needs in applications such as kitchen, living room, bedroom, bathroom, workplace, common areas, outside soffits and other hard to reach spaces.

Features

- **【Various colors】** The smart panel light supports warm white and cool white from 2700K to 6500K, and R,G,B mixed colors,totally can provide 16 million different colors.
- **【APP Intelligent Control】** ①Download the “Smart life” application to connect and enjoy intelligent control. ②Only compatible with 2.4 GHz Wi-Fi. ③The LED Ceiling Light are intelligently grouped and controlled through the APP. ④Create a personal timetable and the downlight will switch automatically. ⑤Share to other devices in the APP, and share control LED lights between different devices.
- **【Voice Control】** Compatible with Alexa and Google Assistant. Use simple conversations to control your lights and release your hands.
- **【Music & Mic Snyc】** ①The LED recessed lights can change the color with the beat of the music or the sound of the game. ②This function is only applicable to APP, no built-in microphone or speaker.
- **【High Quality】** ultra-thin body, no flicker, silent, 10%-100% smooth dimming, instant start.
- **【Easy Installation-No Can Required】** Cut a hole in ceiling with 1:1 hole template; Connect the J-box to the cable; Use spring clip to fix it on the ceiling. Note: It is not compatible with the DIMMER switch, which will shorten the service life.

The Design for Lamp

- Great spring elasticity, **6N-8N** force.

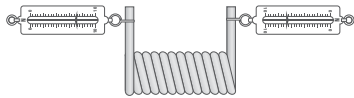

- Waterproof ring for use in wet location. 

- super slim lamp body 0.45 inch for round version.

- Acrylic light guide, laser dotting, **no yellowing**, long life span.

- Adopt edge-lit tech, visual uniformity, **CRI up to 90.**

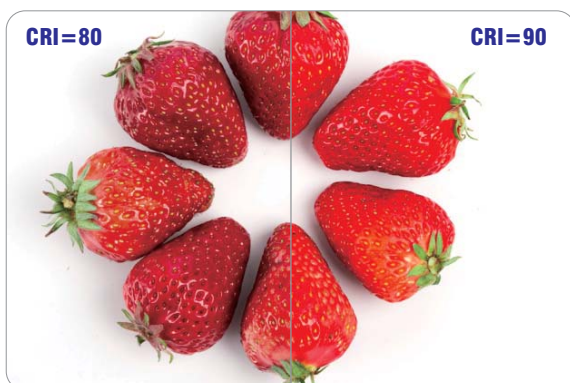

- Connector with strain relief design.



- The Cable is High fire rating FT1, temperature resistance up to 105°C.



The Design for Power Supply

- Buckle design of junction box, easy to open.
- Big wiring space, J-box VOL **7.6 in³** , maximum of (5)NO 12 AWG or (7) NO 14 AWG Conductors.
- 3 connectors available each lamp for AWG 12to AWG 20 Cable.
- Strain relief design at outlet.
- Reserve screw holes for easy fixing on any ceiling.

Specifications

6寸 (RGB+CCT)

Model	Color	Power (W)	CCT	Light efficiency	Luminous flux (±10%)	CRI	Input Voltage	Max.input current	Output Voltage	Max.output current	PF	Dimming type	Dimming range	LED type	LED Qty.	Wavelength	Cutout size													
SC-DL12-D06-WF01-01R	White	12W	5700K	71LM/W	850LM	>90	100-130 VAC	0.15A	33V	0.4A	>0.9	WIFI	10-100%	2835/0.5W	30 PCS	625-740nm	ø6"3/8 / ø162													
	Warm white		2700K	65LM/W	780LM																									
	Red	1.5W	2.25W																											
	Green	3014/0.04W																										492-577nm		
	Blue																												3014/0.06W	440-475nm
	RGB																													

4寸 (RGB+CCT)

Model	Color	Power (W)	CCT	Light efficiency	Luminous flux (±10%)	CRI	Input Voltage	Max.input current	Output Voltage	Max.output current	PF	Dimming type	Dimming range	LED type	LED Qty.	Wavelength	Cutout size													
SC-DL09-D04-WF01-01R	White	9W	5700K	65LM/W	585LM	>90	100-130 VAC	0.15A	33V	0.4A	>0.9	WIFI	10-100%	2835/0.5W	20 PCS	625-740nm	ø4"1/4 / ø108													
	Warm white		2700K	60LM/W	540LM																									
	Red	1.0W	1.5W																											
	Green	3014/0.04W																										492-577nm		
	Blue																												3014/0.06W	440-475nm
	RGB																													

Dimensions (unit: inch)

Round 4 inch

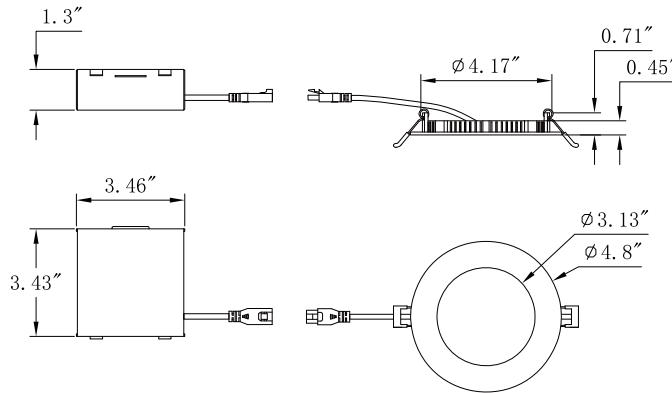

Round 6 inch

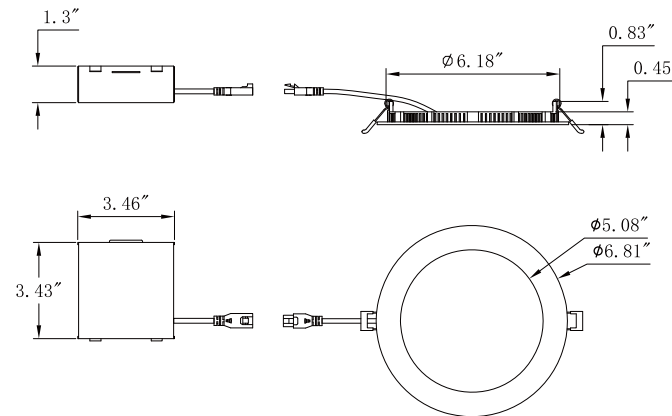

Installation drawing

LED round panel light can perfect replace traditional down light, Low light pollution, excellent protection from eyestrain.

1. Turn off the main power circuit.
2. Cut a hole in the ceiling in the desired location using the template provided.
3. Remove the knockout(s) on the side(s) of the box.
4. Run the electrical wire from the power source through the knockout(s).

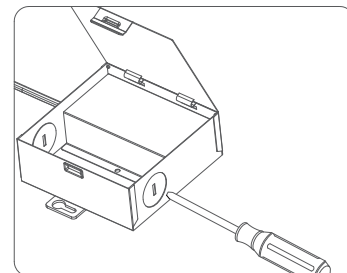
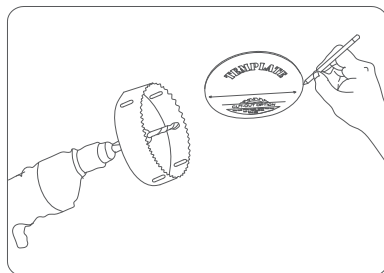

5. Connect the supply wires to the driver's wires using the connector nuts provided.
6. Tuck the connected wires inside the junction box and close the box.

7. Connect the junction box to the slim down light, tighten the connectors by hand. The slot of the male/female connectors need to aligned before inserted.

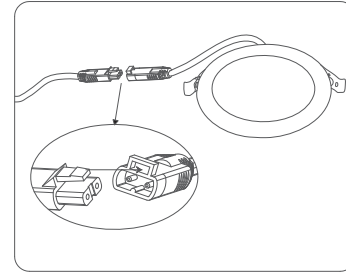
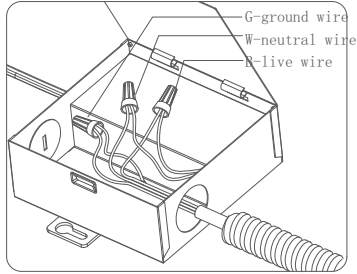

8. Insert the junction box through the hole in the ceiling.

9. Push the spring clips and insert the lamp into the hole in the ceiling.

10. Turn on the power of down lights and test the light.

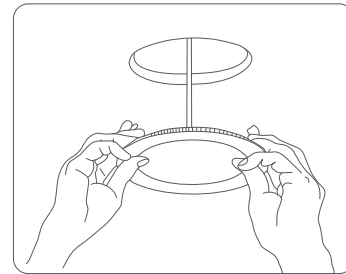
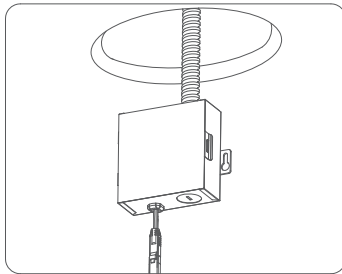

Installation requirements

- 1. Power off before installation;
- 2. Drill proper hole into the ceiling according to product model;
- 3. Connect AC wire;

- 4. Embed the light into ceiling hole;
- 5. Light up and test, installation finish.

Packaging information

Information \ Size	4 Inch Round	6 Inch Round
Net weight/CTN	0.38Kg	0.53Kg
Gross weight/CTN	15.9Kg	11.2Kg
Inner size/Inch	5.91x5.91x2.76	7.87x7.87x2.76
Carton size/Inch	28.35x12.60x12.60	16.54x14.76x16.54
	1pcs/inner box, 40 pcs/carton	1pcs/inner box, 20 pcs/carton



Notice



- Please read the specification first, to make sure the service environment matches the condition in the specification before using.
- Please confirm the applicable power supply before using.
- Make sure the switch of product is off before connect to the power supply to prevent electric shock.
- Operation against rules may damage your property even harm to your personal safety.
- Preliminarily estimate required quantity of LED panel lights, then according to the power rating of single panel light to figure out the total power and design power supply plan.
- Dangerous high voltage, Non-professionals are not allowed to maintain the products.
- If the exterior flexible cable or wire is damaged, it must exchange by the supplier, its agent or other similar qualified personnels to avoid dangers.



Yijia Industrial Park, Fuqian Road, Guanlan
Town, LongHua, Shenzhen, Guangdong, China

Tel:+86-755-27608650
Fax:+86-755-27608651
www.signcomplex.com
sales@signcomplex.com