

SC-SSE061528-128-WW-24

SIDE-EMITTING NEON

Available colors



Super Bright

Large light-emitting surface, uniform and soft light.

Soft Light

Various LEDs are available, more uniform luminescence.
No light dot can be seen even in close distance, soft light.

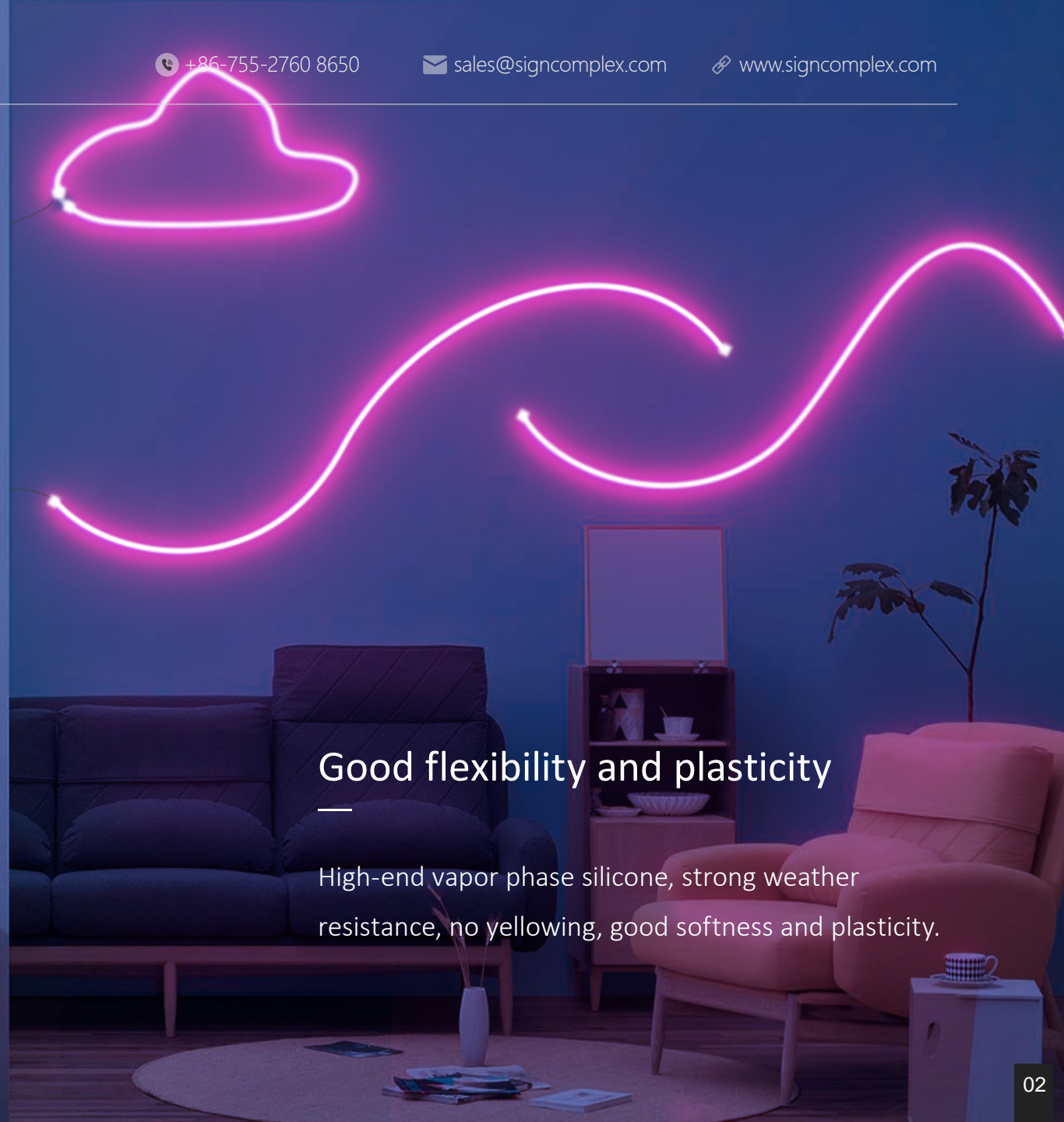

Good flexibility and plasticity

High-end vapor phase silicone, strong weather resistance, no yellowing, good softness and plasticity.

Waterproof and safer application

The product has passed CE, RoHS and other certifications, good waterproof effect, safer application.



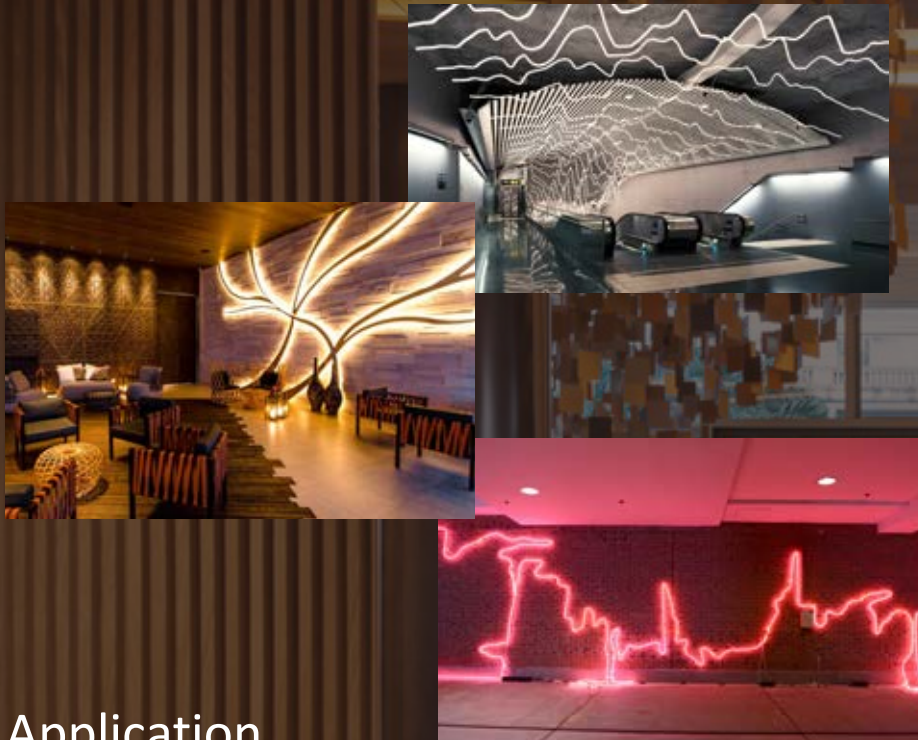

Application

Widely used in hotels, shopping malls, furniture, cabinets, bookshelves, as decorative lighting, direct lighting or indirect lighting.

PARAMETER

Model	Wave Length & CCT Range(for LED only)		Luminous Flux (lm/M)	CRI	LED Type	LED Qty. (PCS/M)	Rated Watt (w/m)	DC Voltage (V)	Max.Length (M)	Min.Length (mm)	PCB Width	IP	Beam angle (degree)
SC-XX-128-XX-24	WW	2800-3200K	473	80	2835	128	7.7	24	5	62.5	8	65	160
	NW	3800-4500K	442										
	W	6000-6500K	551										
	R	620-630nm	\	\									
	G	515-530nm											
	G	460-470nm											

ACCESSORIES

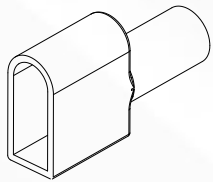

End cap with hole
2pcs/5M

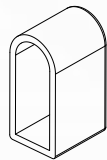

End cap without hole
2pcs/5M

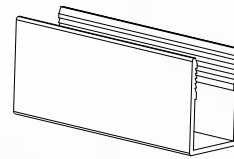

Mounting clip
20pcs/5M

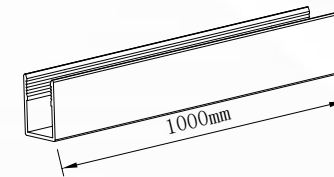

Mounting Channel
optional

DIMENSIONS (unit: mm)

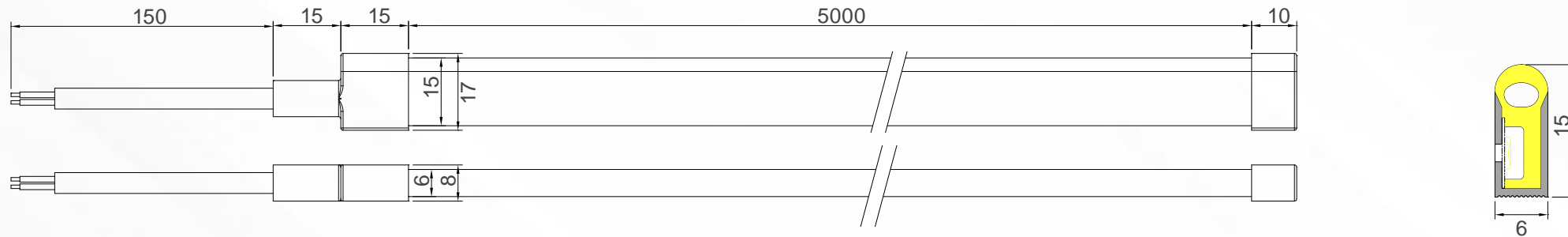

INSTALLATION DIAGRAM

Installation operation

1. Fix the clip in the place where the neon flex installed, as shown in Figure 1.

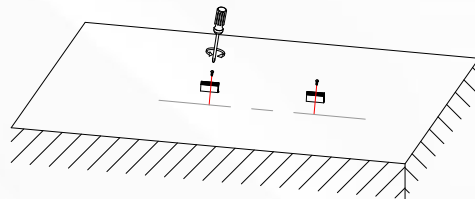

Figure 1

2. Install the neon flex into the clip, the installation is complete, as shown in Figure 2.

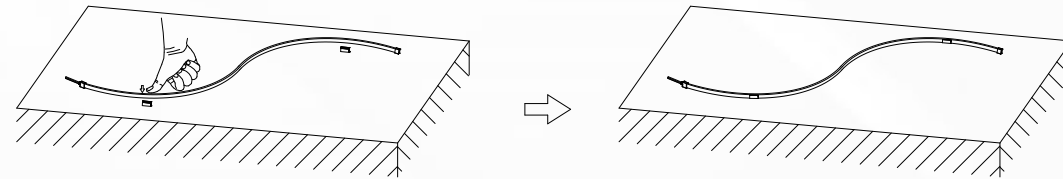

Figure 2

Installation operation

1. Cut along the cutting line with scissors, as shown in Figure 3.

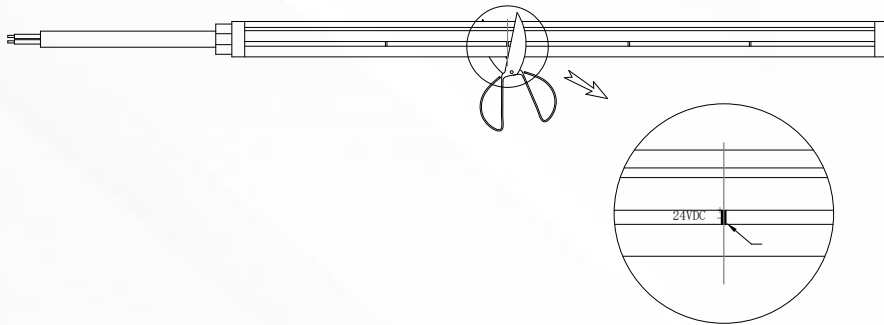

Figure 3

2. The plug will be filled with glue, and put the neon flex into the plug, the installation is complete, as shown in Figure 4.

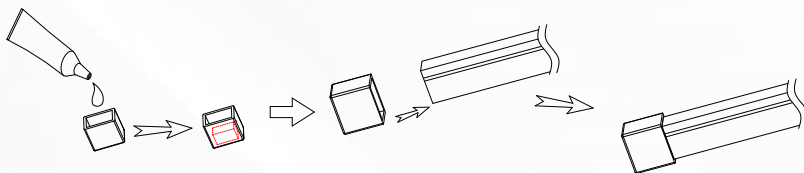

Figure 4

3. Cut off the adhesive on the back of the PCB to reveal the welding points, as shown in Figure 5.

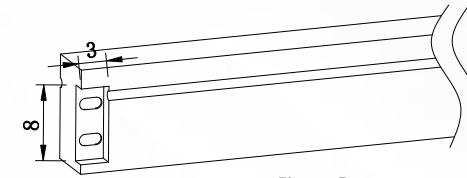

Figure 5

4. Use the soldering iron to solder the wire, as shown in Figure 6.

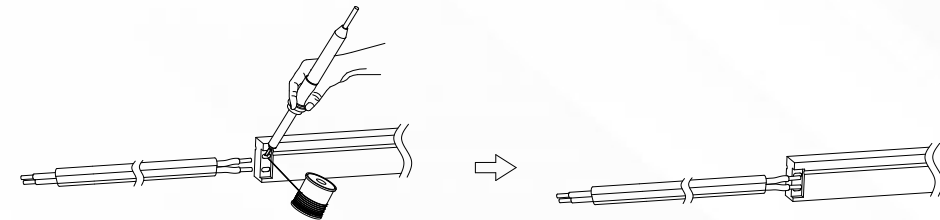

Figure 6

5. Put the plug encased into the line, and repeat Figure 4 gluing steps, and then insert the neon flex into the plug, the installation is complete, as shown in Figure 7.

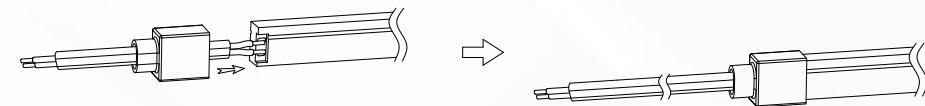
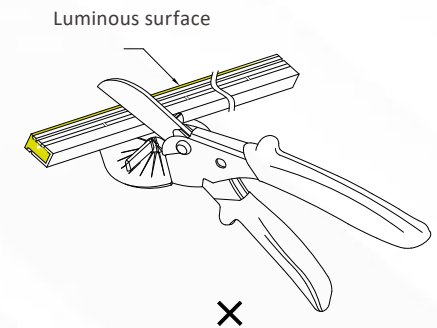
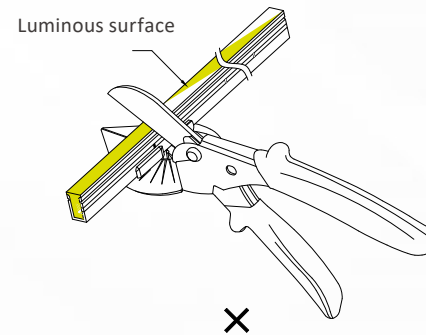
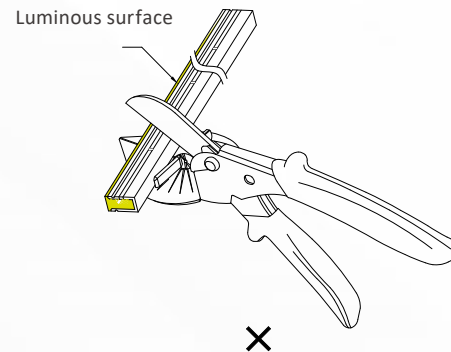
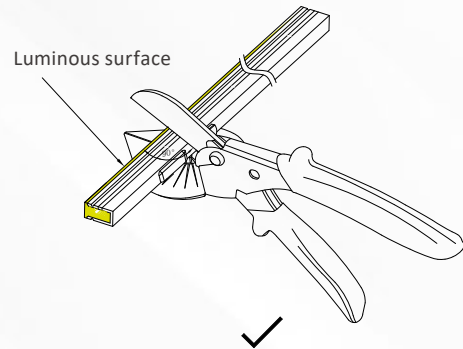
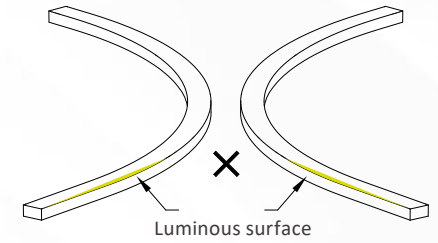
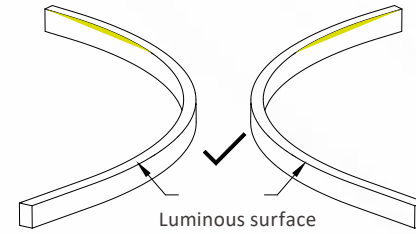
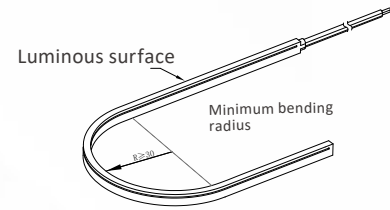
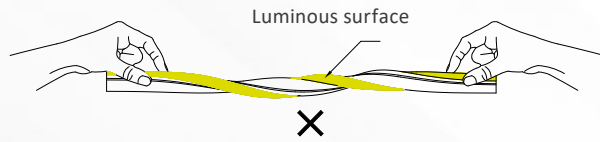
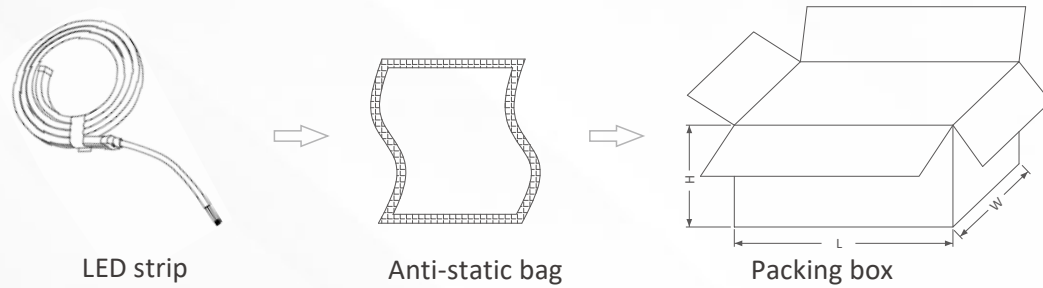

Figure 7

Bending direction and bending radius



PACKAGING INFORMATION



LED strip		Anti-static bag		Packing Box	
Part Number	Gross Weight per Reel	QTY per Carton	Gross Weight	Size(cm/inch)	
SC-SSE061528-128-WW-24	0.121KG	40	15.65KG	59cm*32.5cm*21.1cm 23.23"*12.79"*8.3"	

INSTALLATION

REQUIREMENT



- ⦿ The LED strip and accessories can't be squeezed or folded.
- ⦿ PCB conductive parts can't be damaged when installation.
- ⦿ Installation must conform to electrical safety standard. The LED strip can only be installed by professionals.
- ⦿ Ensure power supply transform operating load with transformer.
- ⦿ When install on metal or conductor surface, insulation protection need to be provided to the contact area.
- ⦿ Observe positive and negative polarity, ensure correct connection to avoid damaging LED strip.
- ⦿ When installation, please prevent static electricity.
- ⦿ The product need anti-corrosion environment, such as, avoiding damp, water drop or other adverse elements.