

SC-TSE101028-128-WW-24V

**EMBEDDED &  
WITH EDGE  
NEON**

Available colors

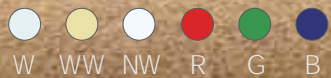

## "Wing" structure design

Seamless, perfect edge closing, with  
"wing" structure design.

A 3D cutaway diagram of a wood joint. The image shows two wooden planks meeting at a joint. The joint is a complex interlocking design where the top surface of one plank fits into a recessed channel of the other. The wood grain is clearly visible on all surfaces. The joint is shown in a perspective view, highlighting the precision of the fit. The background is black, making the light-colored wood stand out.

## Perfect edge closing

No profile or clip are required for perfect embedded installation.  
No installation gap caused by slotting accuracy.

## Good flexibility and plasticity

High-end vapor phase silicone, strong weather resistance, no yellowing, good softness and plasticity.



## Application

Widely used in hotels, shopping malls, furniture, cabinets, bookshelves, as decorative lighting, direct lighting or indirect lighting.

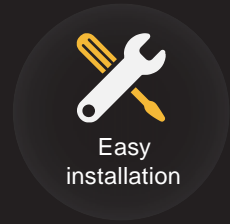

## PARAMETER

Model	Wave Length & CCT Range(for LED only)	Luminous Flux (lm/M)	CRI	LED Type	LED Qty. (PCS/M)	Rated Watt (w/m)	DC Voltage (V)	Max. Length (M)	Min. Cut Length (mm)	PCB Width	IP	Beam Angle (degree)	
SC-TSE101028-128-WW-24V	WW	2800-3200K	732	2835	128	7.6	24	5	50	6	65	113	
	NW	3800-4500K	750										82
	W	6000-6500K	775										
	R	620-630nm											
	G	515-530nm	\										\
	B	460-470nm											

# DIMENSIONS (unit: mm/inch)

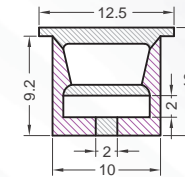
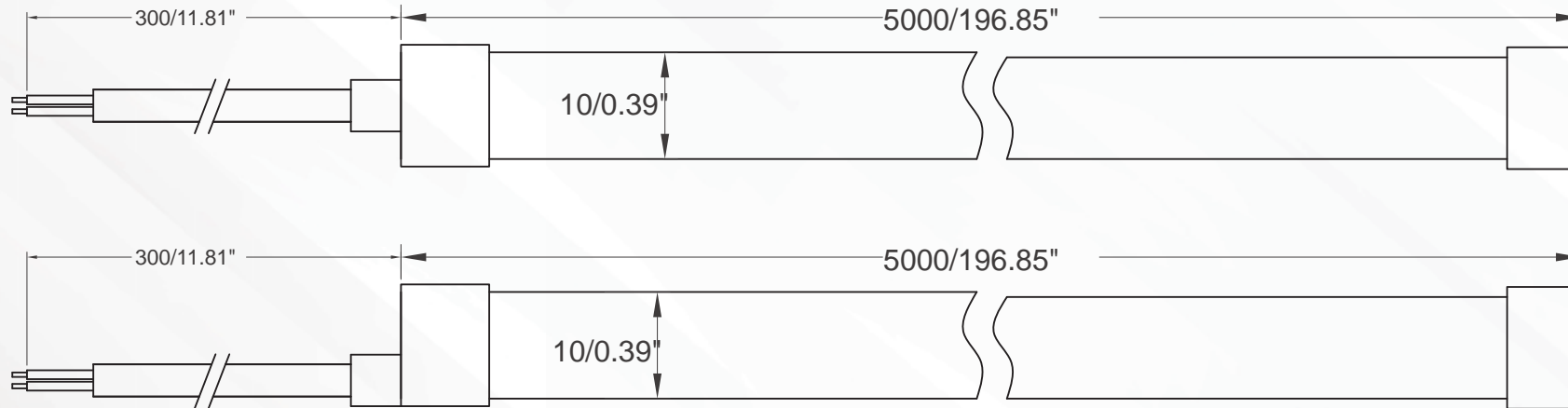

## ACCESSORIES

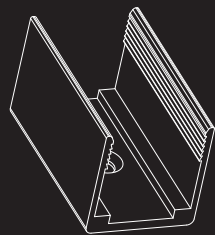

**Mounting clip**  
20pcs/5M

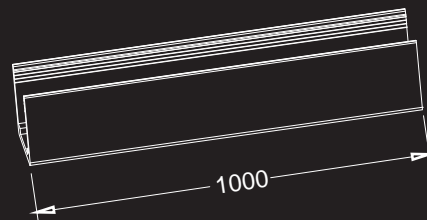

**Mounting channel**  
optional

# INSTALLATION DIAGRAM

1. Cut along the cutting line with scissors, as shown in Figure 1.

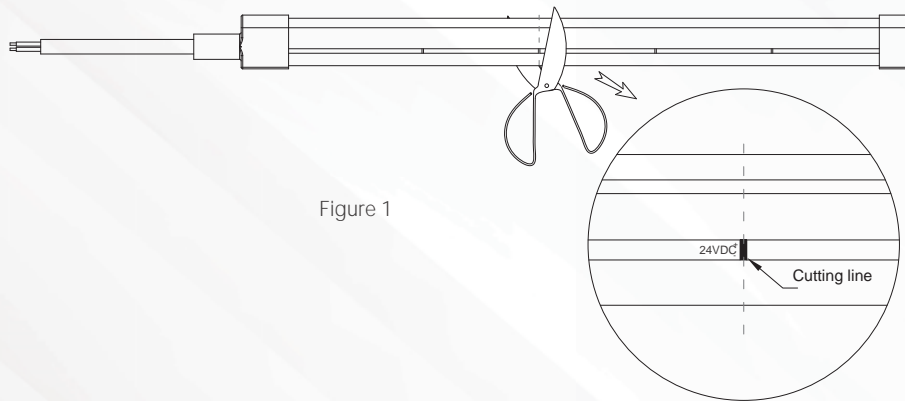

Figure 1

2. The plug will be filled with glue, and put the neon flex into the plug, the installation is complete, as shown in Figure 2.

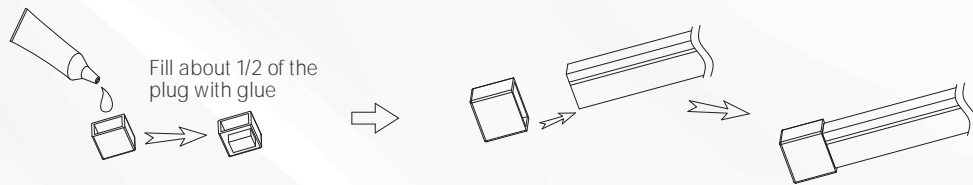

Figure 2

3. Cut off the adhesive on the back of the PCB to reveal the welding points, as shown in Figure 3.



Figure 3

4. Use the soldering iron to solder the wire, as shown in Figure 6.

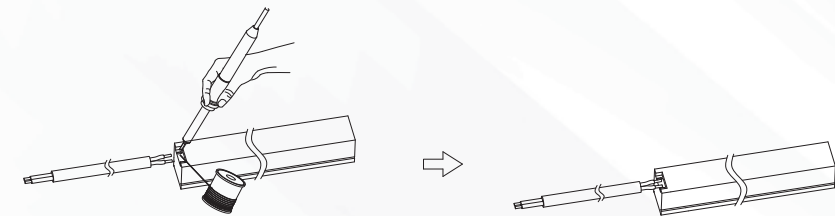

Figure 6

5. Put the plug encased into the line, and repeat Figure 4 gluing steps, and then insert the neon flex into the plug, the installation is complete, as shown in Figure 7.



Figure 7



## Bending direction and bending radius

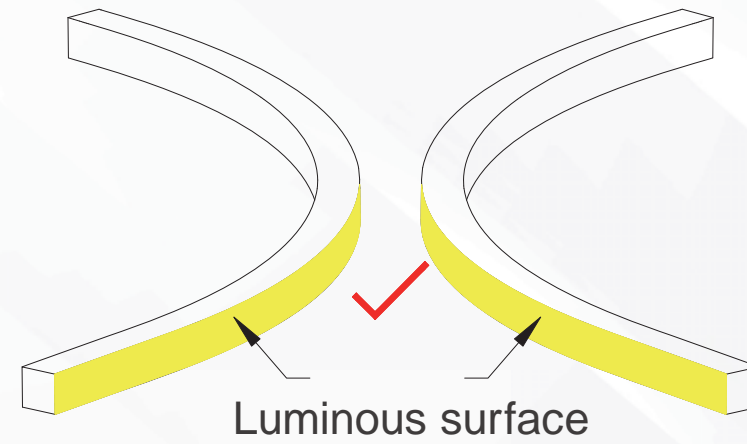
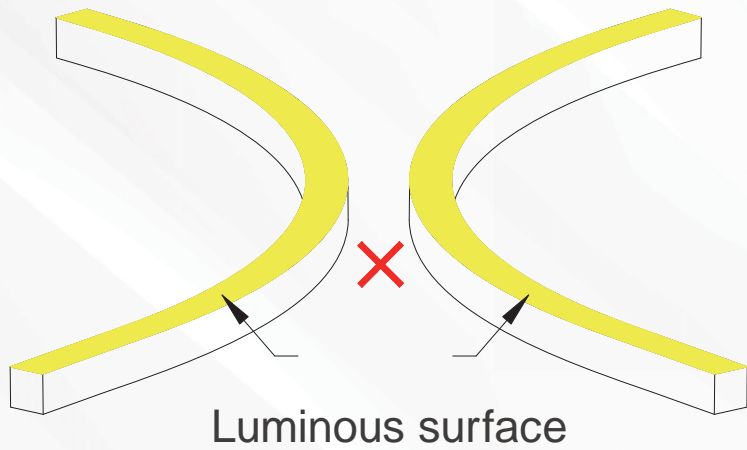
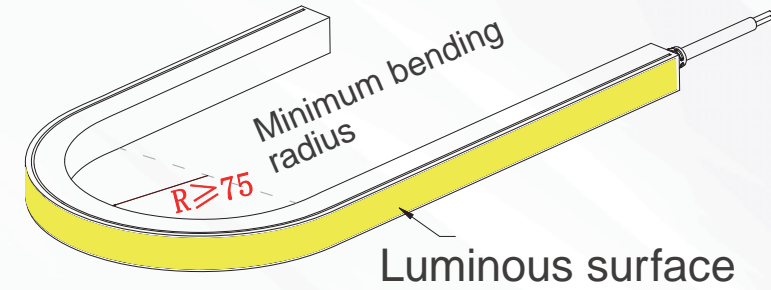
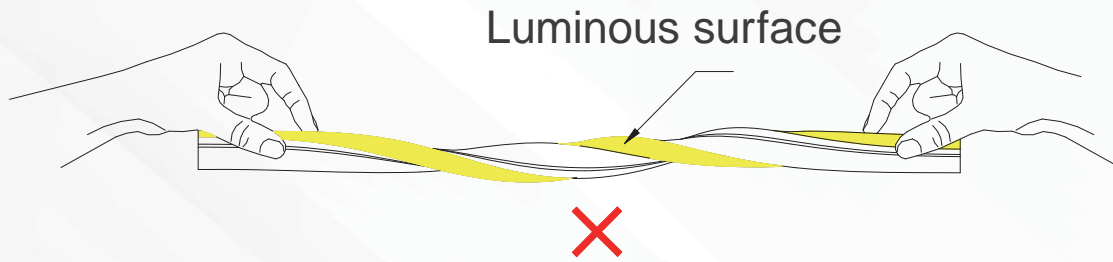

## PACKAGING INFORMATION

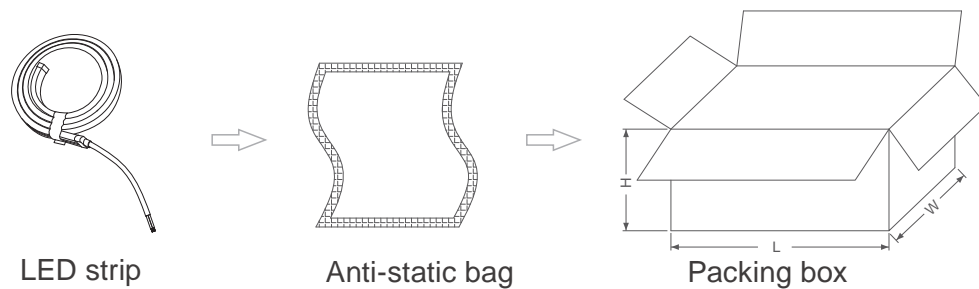

LED Strip		Anti-static Bag		Packing Box	
Part Number	Gross Weight per Reel	QTY per Carton	Gross Weight	Size(cm/inch)	
SC-TSE101028 -128-WW-24V	0.5KG	40	20KG	59cm*32.5cm*21.1cm 23.23"*12.8"*8.31"	

## INSTALLATION REQUIREMENT

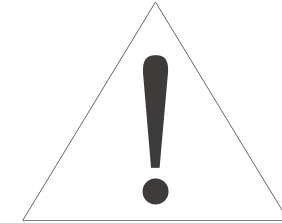

- ◉ The LED strip and accessories can't be squeezed or folded.
- ◉ PCB conductive parts can't be damaged during installation.
- ◉ Installation must conform to electrical safety standard. The LED strip can only be installed by professionals.
- ◉ Ensure power supply transform operating load with transformer.
- ◉ When install on metal or conductor surface, insulation protection need to be provided to the contact area.
- ◉ Observe positive and negative polarity, ensure correct connection to avoid damaging LED strip.
- ◉ When installing, please prevent static electricity.
- ◉ The product need anti-corrosion environment, such as, avoiding damp, water drop or other adverse elements.