

# DOUBLE-SIDED LIGHTING NEON

SC-TSE151528-240-WW-24V

Available colors





## Dual-sided lighting

A silicone tube can emit two kinds of light: up and down, left and right, and can emit different light in two directions at the same time



## Different color temperature

FPC with different color temperature can be placed on both sides

## More Experiences

You can see the strong contrast on both sides of the luminous effect





Good  
flexibility



IP65



Easy  
installation

## Good flexibility and plasticity

High-end vapor phase silicone, strong weather resistance, no yellowing, good softness and plasticity.

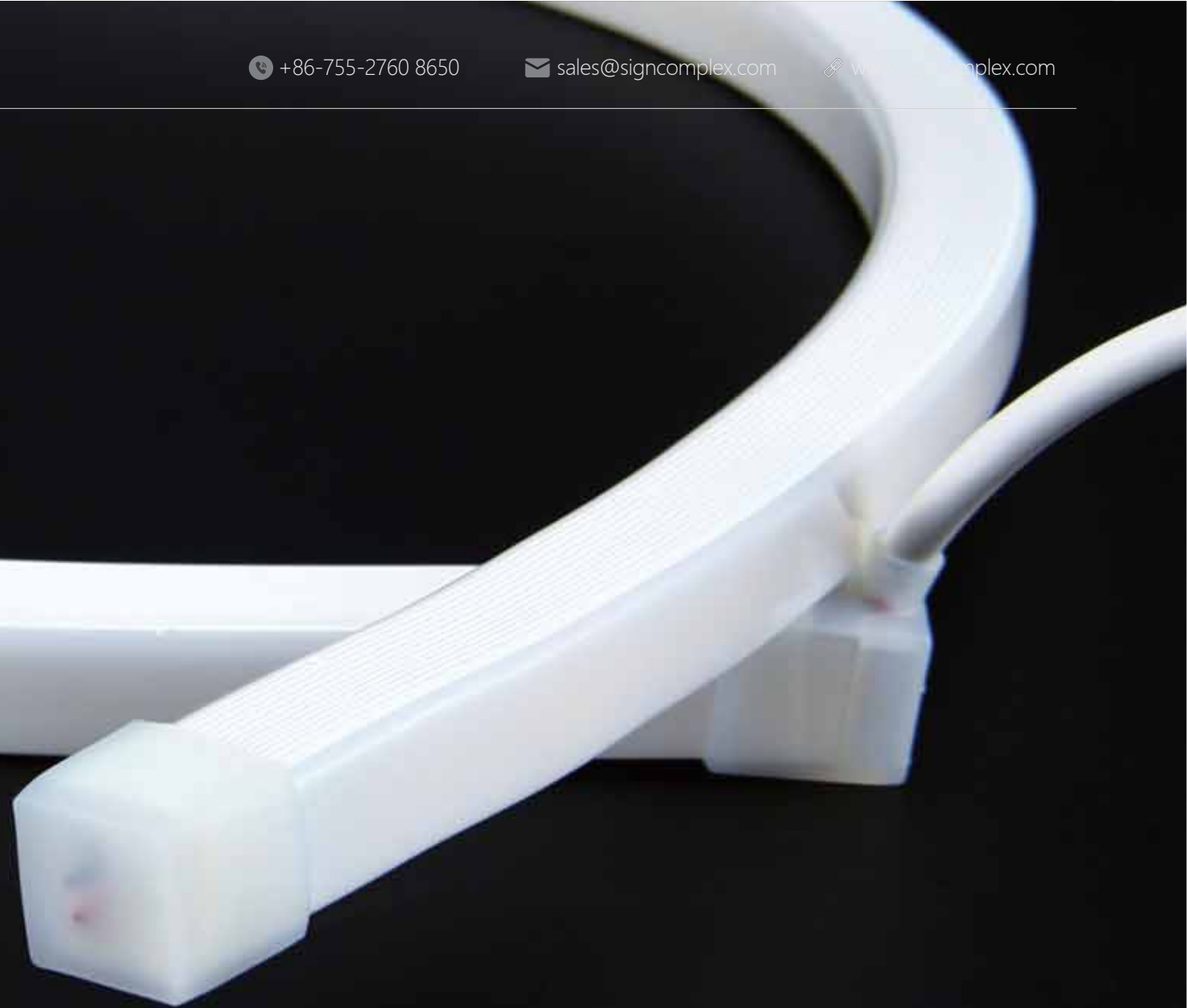



## Application

Widely used in hotels, shopping malls, furniture, cabinets, bookshelves, as decorative lighting, direct lighting or indirect lighting.



# PARAMETER

Model	Wave Length & CCT Range(for LED only)		Luminous Flux (lm/M)	CRI	LED Type	LED Qty. (PCS/M)	Rated Watt (w/m)	DC Voltage (V)	Max. Length (M)	Min. Cut Length (mm)	PCB Width	IP	Beam Angle (degree)
SC-TSE161628-160-NW-24V	WW	2800-3200K	3225	86	2835	240	9.6	24	5	25	10	65	216
	NW	3800-4500K	3265										
	W	6000-6500K	3305										
	R	620-630nm	\	\									
	G	515-530nm											
	B	460-470nm											

## ACCESSORIES

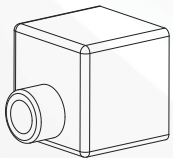

**End cap with hole**  
2pcs/5M

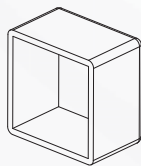

**End cap without hole**  
2pcs/5M

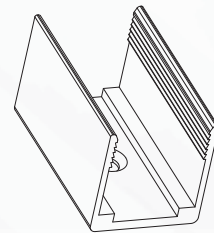

**Mounting clip**  
20pcs/5M



**Mounting channel**  
optional

## DIMENSIONS (unit: mm/ inch)

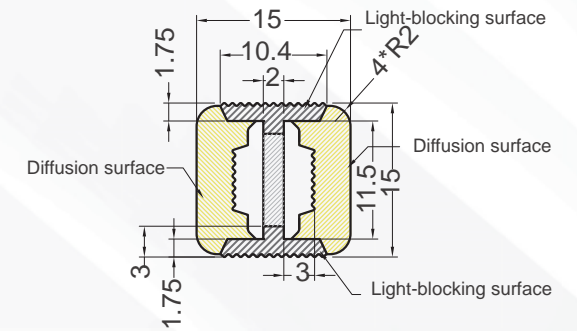
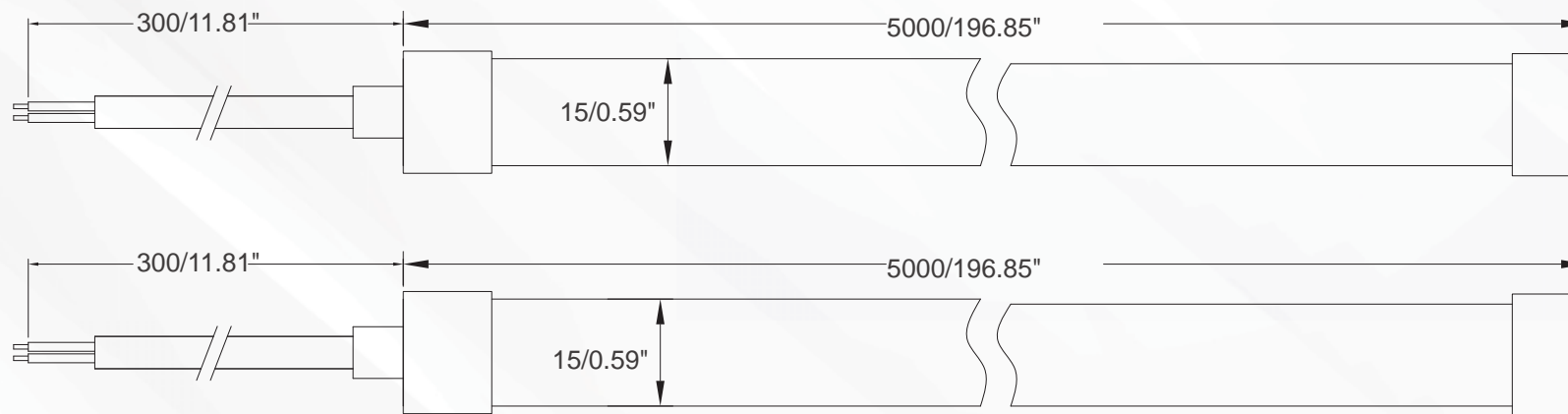



# INSTALLATION DIAGRAM

Step 1: pull a parallel line at the place where the light strip is to be installed, as shown in Figure 1:

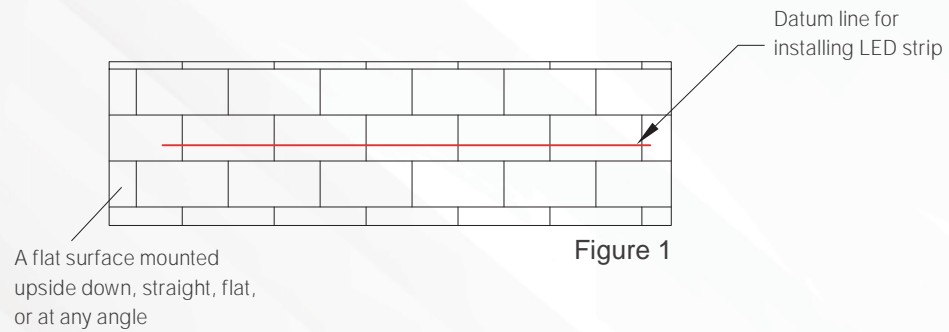

Step 2: Fix the fixed clip on the datum line as shown in Figure 2:

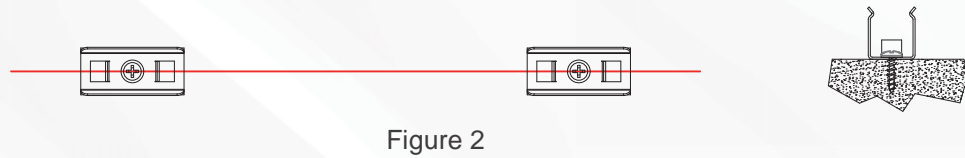

Step 3: Install the light strip into the PC channel, as shown in Figure 3:

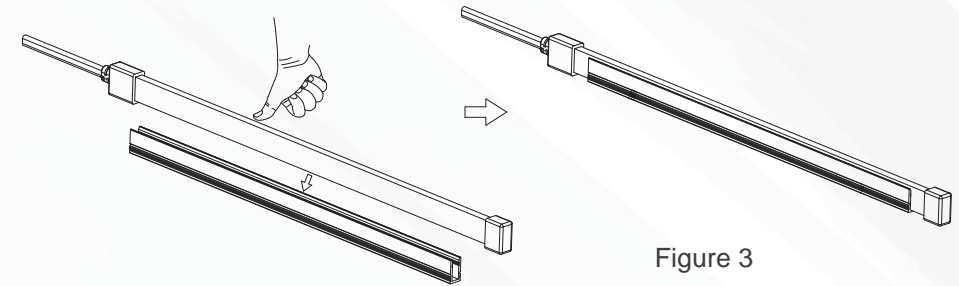

Step 4: Install the light strip into the fixed clip and the installation is completed, as shown in Figure 4:

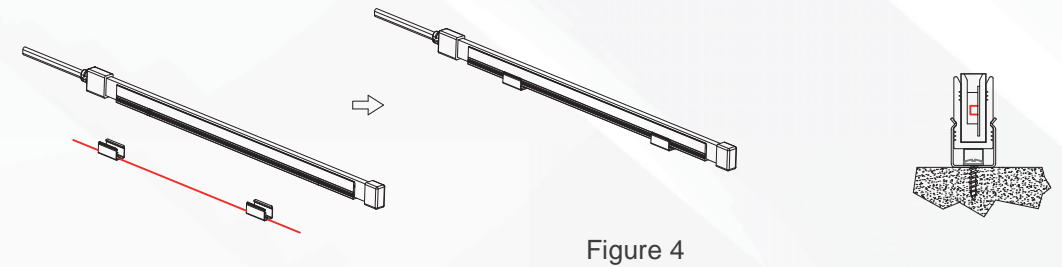

## BENDING DIRECTION AND BENDING RADIUS

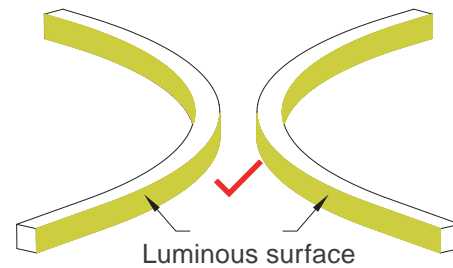
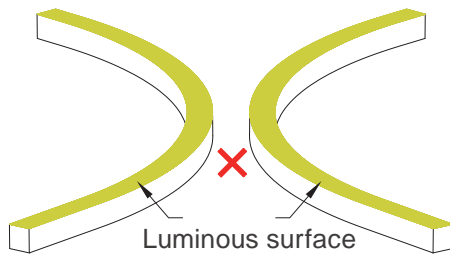
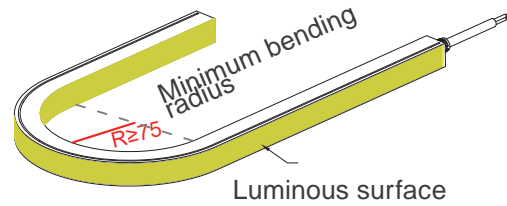
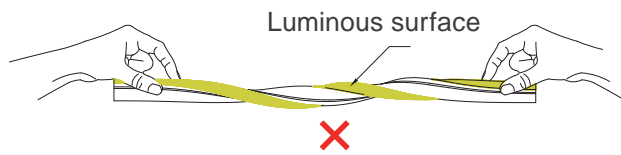

## PACKAGING INFORMATION

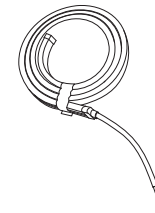

LED strip

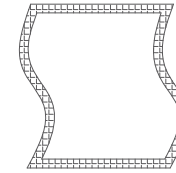

Anti-static bag

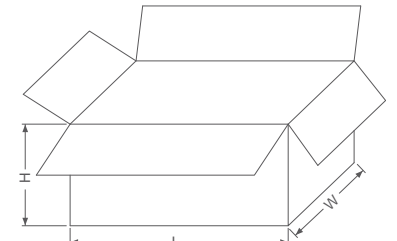

Packing box

LED Strip	Anti-static Bag	Packing Box		
Part Number	Gross Weight per Reel	QTY per Carton	Gross Weight	Size(cm/inch)
SC-TSE151528 -240-WW-24	1.6KG	10	16KG	33cm*33cm*42.5cm 12.99"*12.99"*16.73"