

SC-3014-07-TT0606W-XX-24-210-4-IP65

# ULTRA-NARROW TOP-VIEW NEON



Available colors



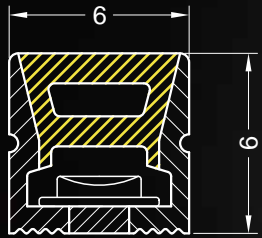

## Ultra-narrow

Dimension: 6×6mm,  
suitable for ultra-narrow spaces





## Soft Light

---

More uniform luminescence. No light dot can be seen even in close distance ,soft light.

## Good flexibility and plasticity

---

High-end vapor phase silicone, strong weather resistance, no yellowing, good softness and plasticity.

## Waterproof and safer application

---

The product has passed CE, RoHS and other certifications, good waterproof effect, safer application.





## Application

—  
Widely used in hotels, shopping malls, furniture, cabinets, bookshelves, as decorative lighting, direct lighting or indirect lighting.

# PARAMETER

Model	Wave Length & CCT Range(for LED only)		Luminous Flux (lm/M)	CRI	LED Type	LED Qty. (PCS/M)	Rated Watt (w/m)	DC Voltage (V)	Max.Length (M)	Min.Length (mm)	PCB Width	IP	Beam angle (degree)
SC-3014-07-TT0606W -XX-24-210-4-IP65	WW	2800-3200K	654	80	3014	210	7.2	24	5	33.4	4	65	113
	NW	3800-4500K	673										
	W	6000-6500K	705										
	R	620-630nm	\	\									
	G	515-530nm											
	B	460-470nm											

## ACCESSORIES

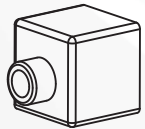

End cap with hole  
2pcs/5M

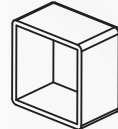

End cap without hole  
2pcs/5M

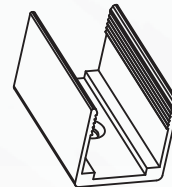

Mounting clip  
20pcs/5M

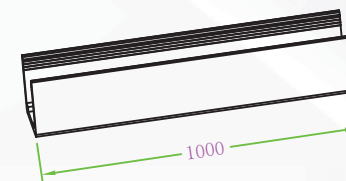

Mounting Channel  
optional

## DIMENSIONS (unit: mm/inch)

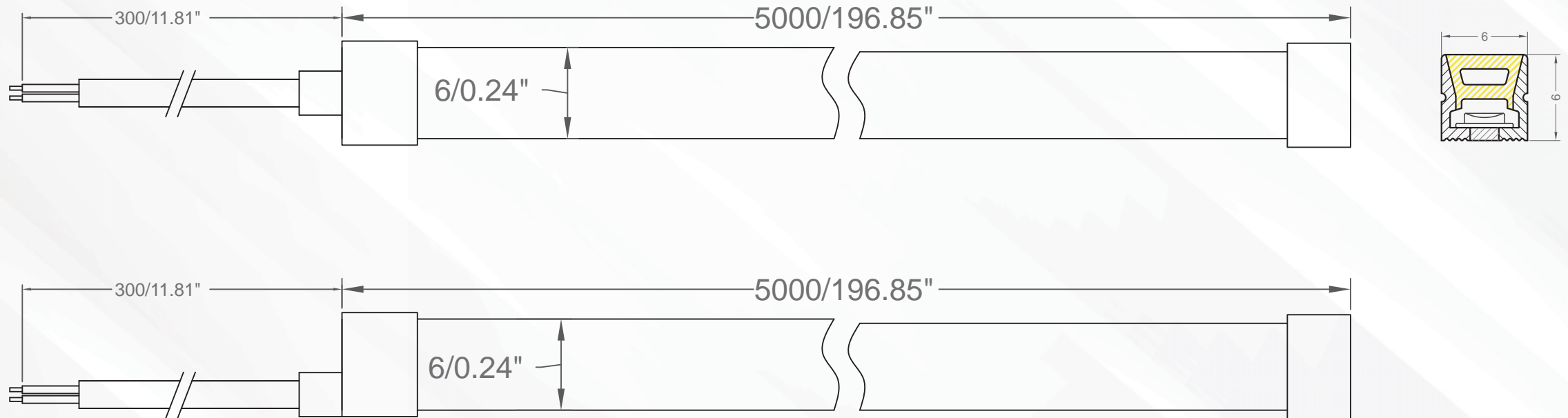

## INSTALLATION OPERATION

1. Cut along the cutting line with scissors, as shown in Figure 3.

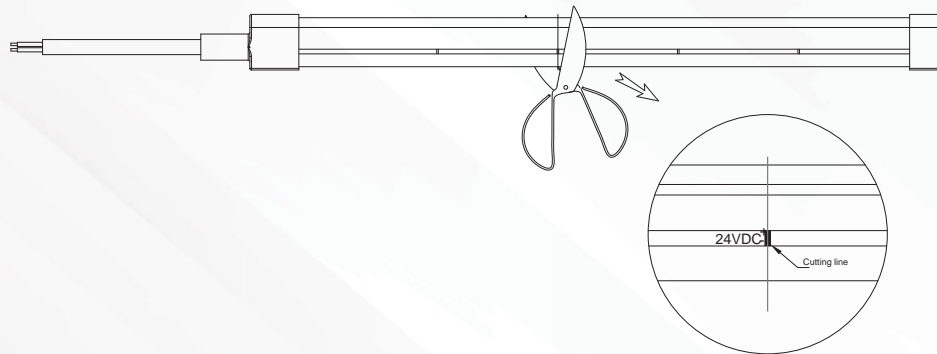

Figure 3

2. The plug will be filled with glue, and put the neon flex into the plug, the installation is complete, as shown in Figure 4.

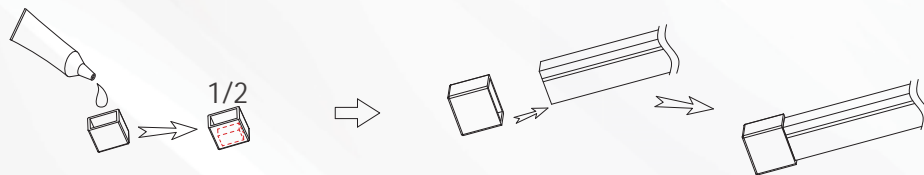

Figure 4

3. Cut off the adhesive on the back of the PCB to reveal the welding points, as shown in Figure 5.



Figure 5

4. Use the soldering iron to solder the wire, as shown in Figure 6.

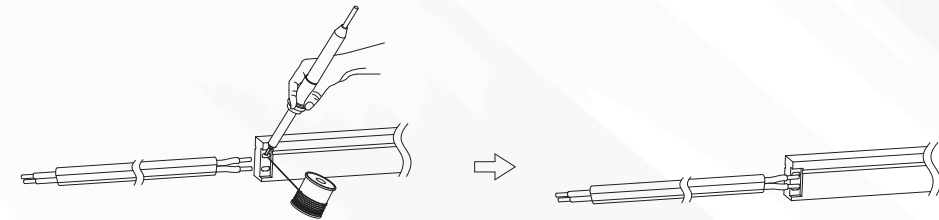

Figure 6

5. Put the plug encased into the line, and repeat Figure 4 gluing steps, and then insert the neon flex into the plug, the installation is complete, as shown in Figure 7.



Figure 7



## BENDING DIRECTION AND BENDING RADIUS

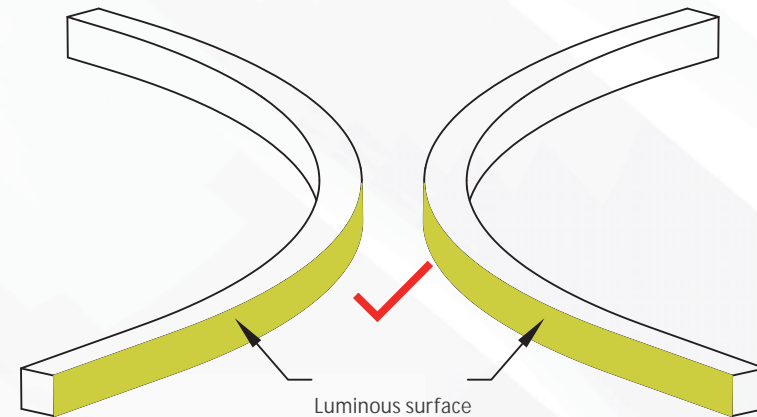
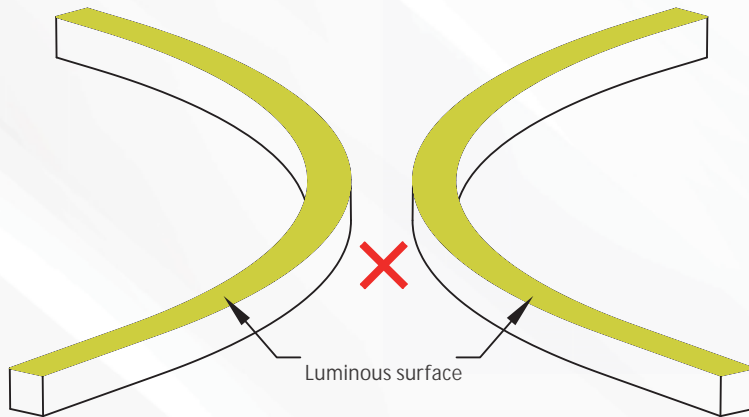
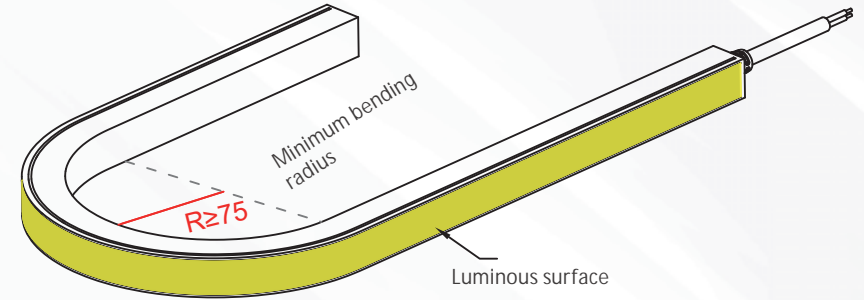
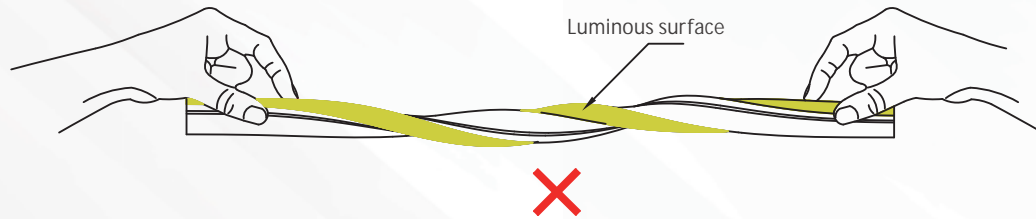

## PACKAGING INFORMATION

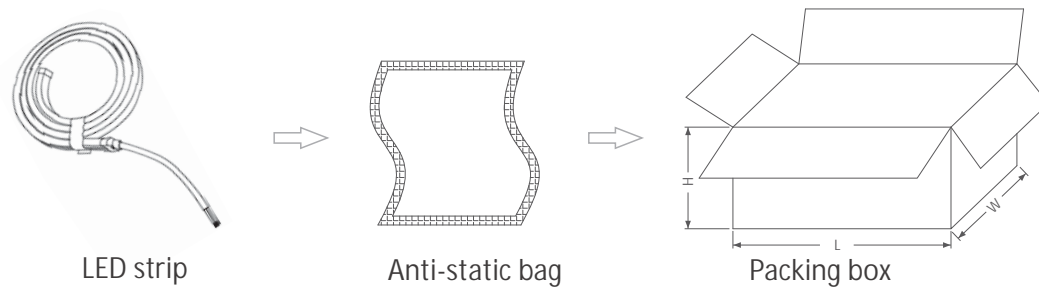

LED strip	Anti-static bag		Packing Box	
Part Number	Gross Weight per Reel	QTY per Carton	Gross Weight	Size(cm/inch)
SC-3014-07- TT0606W-XX -24-210-4-IP65	0.5KG	40	20KG	59cm*32.5cm*21.1cm 23.23"*12.79"*8.31"

## INSTALLATION REQUIREMENT



- The LED strip and accessories can't be squeezed or folded.
- PCB conductive parts can't be damaged when installation.
- Installation must conform to electrical safety standard. The LED strip can only be installed by professionals.
- Ensure power supply transform operating load with transformer.
- When install on metal or conductor surface, insulation protection need to be provided to the contact area.
- Observe positive and negative polarity, ensure correct connection to avoid damaging LED strip.
- When installation, please prevent static electricity.
- The product need anti-corrosion environment, such as, avoiding damp, water drop or other adverse elements.