

Color temperature adjustable

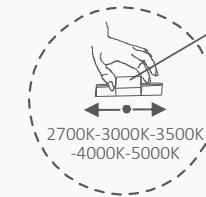

2700K 3000K 3500K 4000K 5000K



Color Adjustable
by dip switch

LED super-slim downlight with baffle trim

-5CCT adjustable version



Application

Suitable for shop, supermarket, shopping mall, hospital, office, house, shopping mall, factory and other indoor places

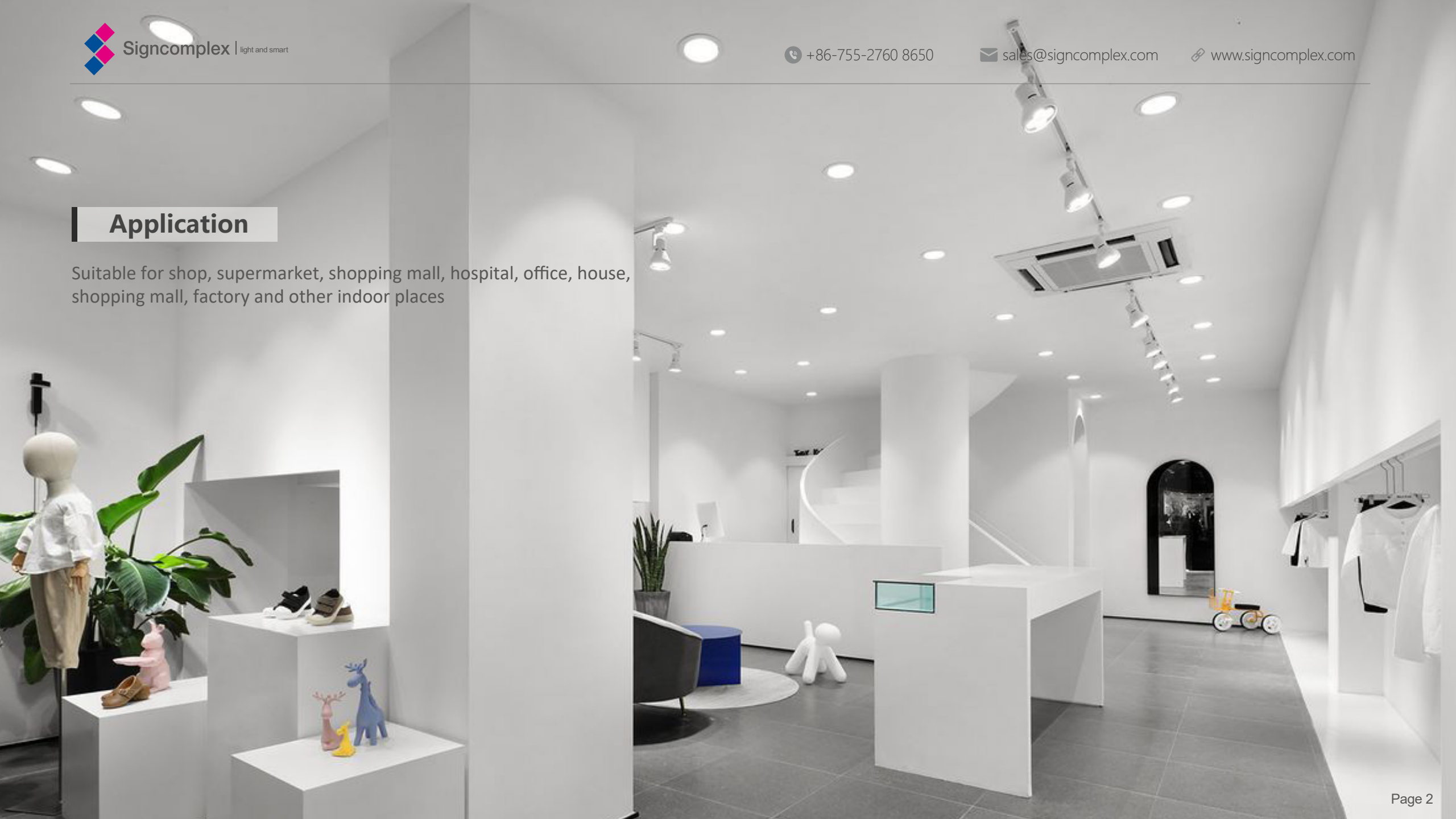

The Design for Lamp

◆ Great spring elasticity, **6N-8N** force.

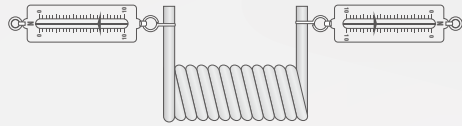

◆ Acrylic light guide, laser dong, **no yellowing, long life span.**

◆ super slim lamp body **0.6 inch** for round version.

◆ Adopt edge-lit tech, visual uniformity, **CRI up to 90.**

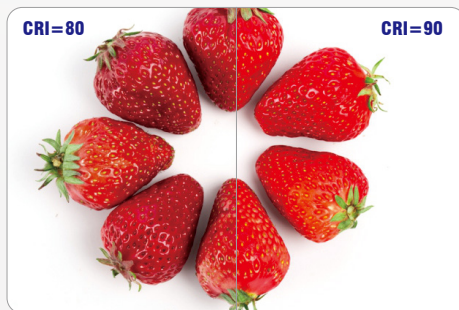

◆ The steaks design reduces glare.

◆ The Cable is High fire rang FT1, temperature resistance up to 105°C.

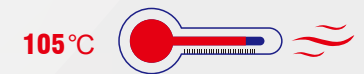

◆ Connector with strain relief design.

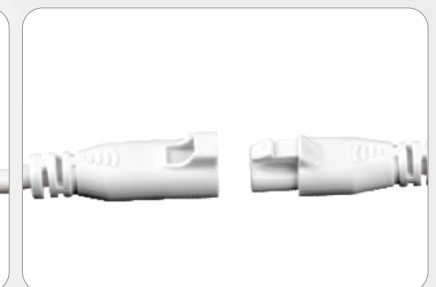
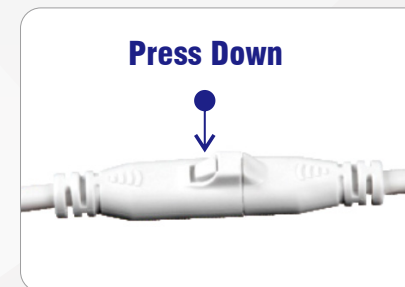

The Design for Power Supply

Buckle design of juncon box, easy to open.

Strain relief design at outlet.

5 optional color temperatures adjustable.

Reserve screw holes for easy fixing on any ceiling.

Big wiring space, J-box VOL **7.6 in³** maximum of (5)NO 12 AWG or (7) NO 14 AWG Conductors.

3 connectors available each lamp for AWG 12to AWG 20 Cable.

Black Wire White Wire Yellow Wire

2700K
3000K
3500K
4000K
5000K

Features

- ◆ Super slim lamp body, 0.6 inch high for round version.
- ◆ The diffuser plate adopt double-sided frosted plate, more uniform light;
- ◆ The frame adopt ADC 12, beer cooling effect; adopt low-power large LEDs, and LEDs work in low temperature;
- ◆ The back cover adopt bending, powder spraying; consistent whole effect, and prevent light-leaking;
- ◆ The driver is designed with high PF(PF >0.9) and is dimmable with most regular dimmers, dimming range up to 10%-100%.

Specifications

Model	POWER	LED type	LED quantity (PCS)	lumen(lm) +10%	Cutout size	Opening size	voitage	CRI	CCT	Input current	PF
SC-DL09-D04-A1-07RE	9W	2835	72	500	φ4.8"	φ4"1/4	100-130V AC	>90	2700K	0.1	>0.9
				537					3000K		
				556					3500K		
				580					4000K		
				567					5000K		
SC-DL12-D06-A1-08RE	12W	2835	96	725	φ6.77"	φ6"3/8	100-130V AC	>90	2700K	0.15	>0.9
				800					3000K		
				805					3500K		
				855					4000K		
				800					5000K		

Dimensions (unit: inch)

Round 4 inch

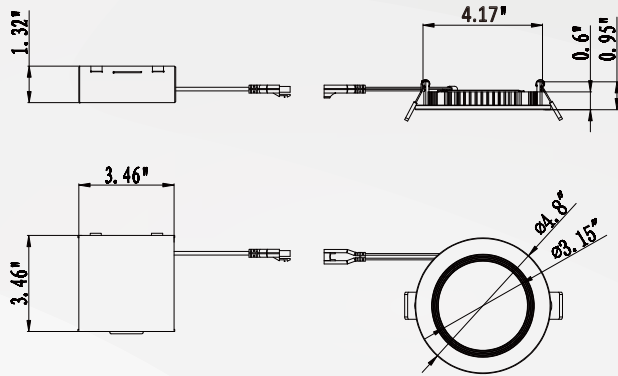

Round 6 inch

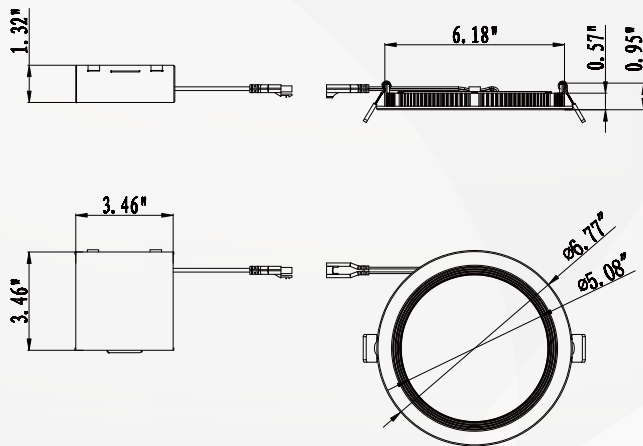

Installation drawing

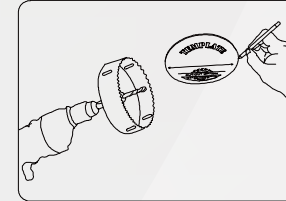

1. Drill holes in the ceiling according to the hole size

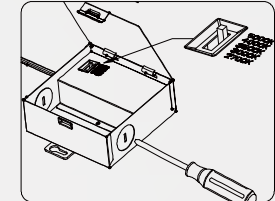

2. Use a screwdriver to pry open the wiring hole Adjust the color temperature dip switch to the desired color temperature

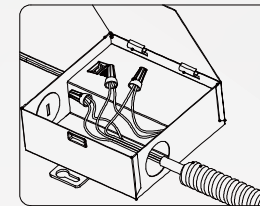

3. Connect the AC wire
Black wire connecting to L, white wire to N, green wire to ground wire

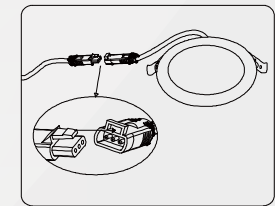

4. Connect the DC male and female plug cords

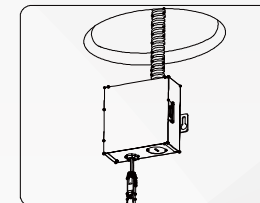

5. Place the power supply into the ceiling

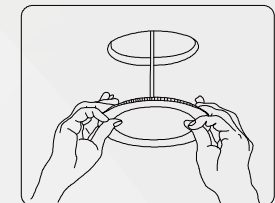

6. Embed the lamp body into the ceiling

Installation requirements

1. Power off before installation;
2. Drill proper hole into the ceiling according to product model;
3. Connect AC wire;
4. Embed the light into ceiling hole;
5. Light up and test, installation finish.

Packaging information

Information \ Size	4 Inch Round	6 Inch Round
Net weight/CTN	0.34kg	0.5kg
Gross weight/CTN	17.5kg	13.4kg
Inner size/Inch	5.9*5.9*2.76"	7.87*7.87*2.76"
Carton size/Inch	28.5*12.6*12.6"	16.54*14.76*16.54"
	1pcs/inner box, 40 pcs/carton	1pcs/inner box, 20 pcs/carton

Notice



- ◆ Please read the specification first, to make sure the service environment matches the condition in the specification before using.
- ◆ Please confirm the applicable power supply before using.
- ◆ Make sure the switch of product is off before connect to the power supply to prevent electric shock.
- ◆ Operation against rules may damage your property even harm to your personal safety.
- ◆ Preliminarily estimate required quantity of LED panel lights, then according to the power range of single panel light to figure out the total power and design power supply plan.
- ◆ Dangerous high voltage, Non-professionals are not allowed to maintain the products.
- ◆ If the exterior flexible cable or wire is damaged, it must exchange by the supplier, its agent or other similar qualified personnels to avoid dangers.