

Version A
(slim aluminum frame)

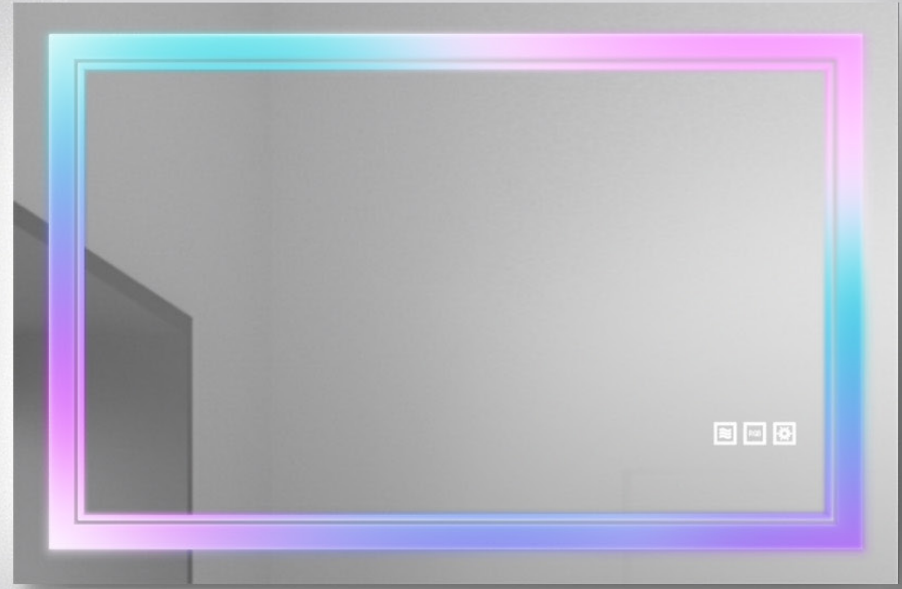

Version B
(frameless)

3-in-1 Smart Mirror

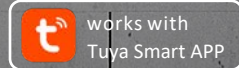
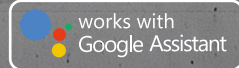

Function

1 Three-in-one control

Smart control 
 Mobile phone APP Bluetooth/ WIFI double modes



Touch switch



Remote control



2 Smart settings

Download the Tuya app to enjoy a smarter home life



16 Million colors



Warm white to daylight



Scene simulation



Music, lighting and rhythm function

3 Music, lighting and rhythm function

Under the RGB mode, the lighting will change as the music changes

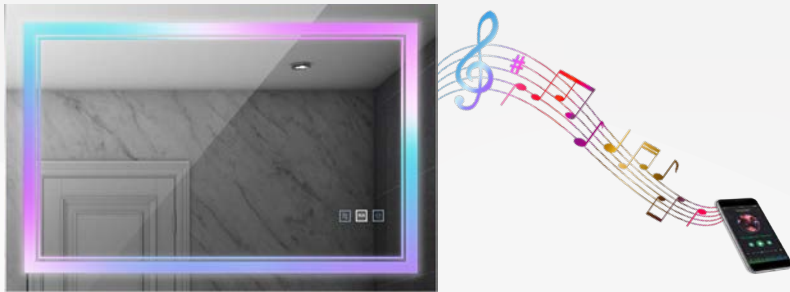

4 Color Settings

RGB Color Settings



3 Color Settings: 6000K-4000K-3000K

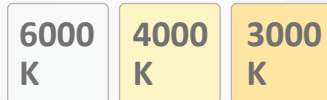

RGB



3 Color Settings:6000K-4000K-3000K

6000K



4000K



3000K

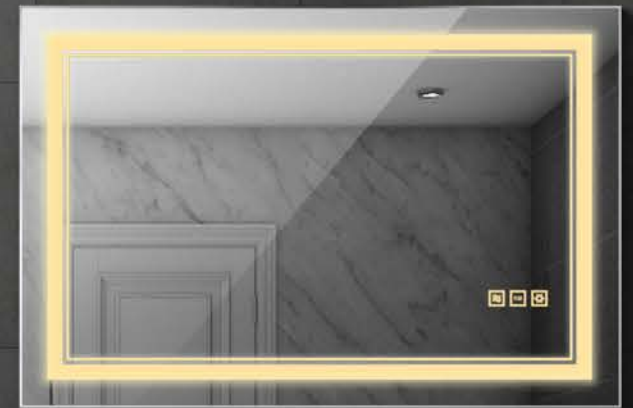

5 Intelligent one-button defogging function

Turn on the one-button defogging function, immediately get a clear vision, no need to wait for dressing

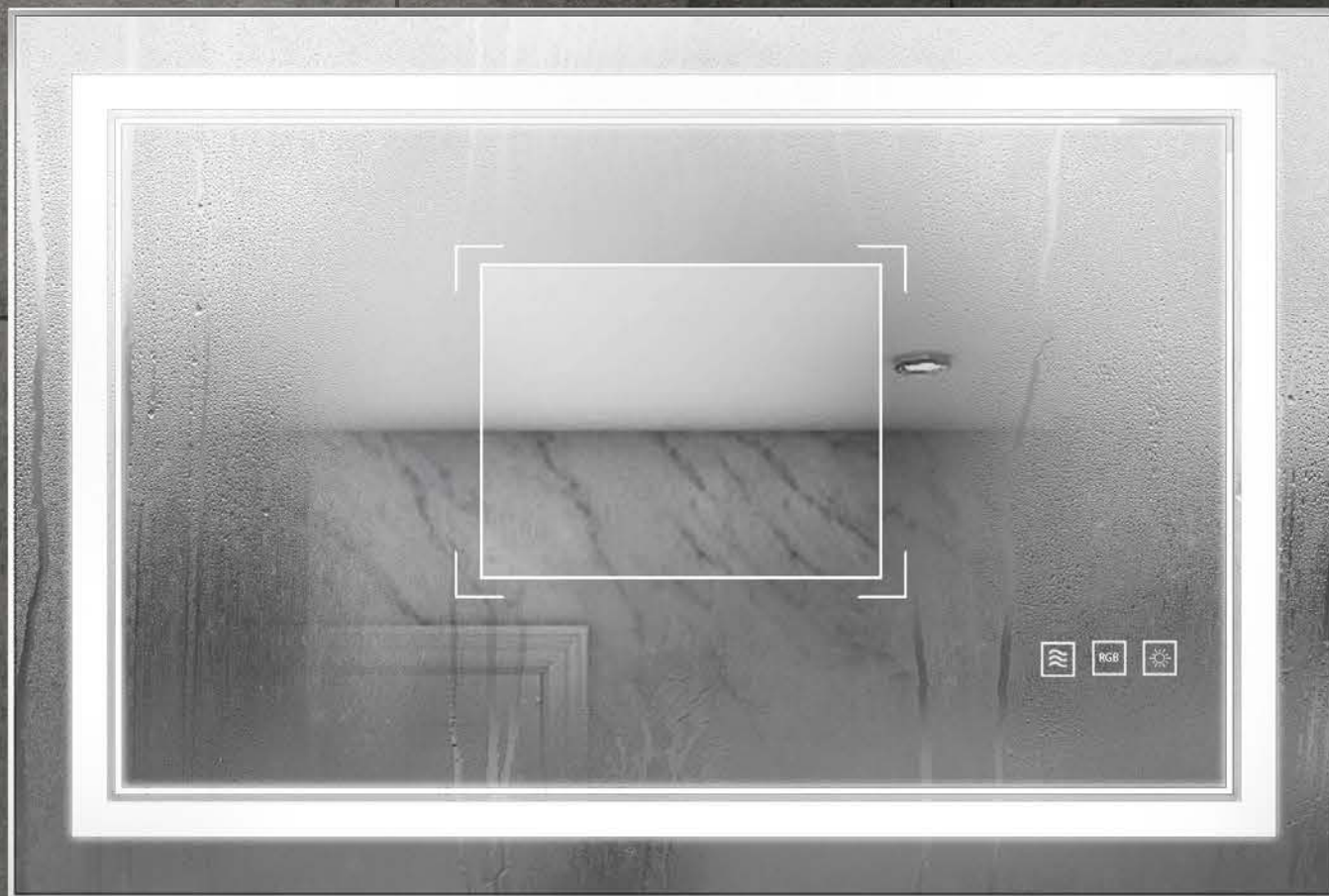

Electric heating
partial defogging function

6 Stepless Dimming

Intelligent touch switch, adjust color and brightness as you like



100% Brightness 75% Brightness 50% Brightness 25% Brightness 5% Brightness

7 High Definition Imaging

5MM HD environment-friendly silver mirror, no deformation, high distortion, clear imaging, anti-corrosion, fast fog dispersion



8 5MM High Definition No Bronze Silver Mirror

More Durable /High Definition /Anti-Oxidation /Multi-Layers Protection

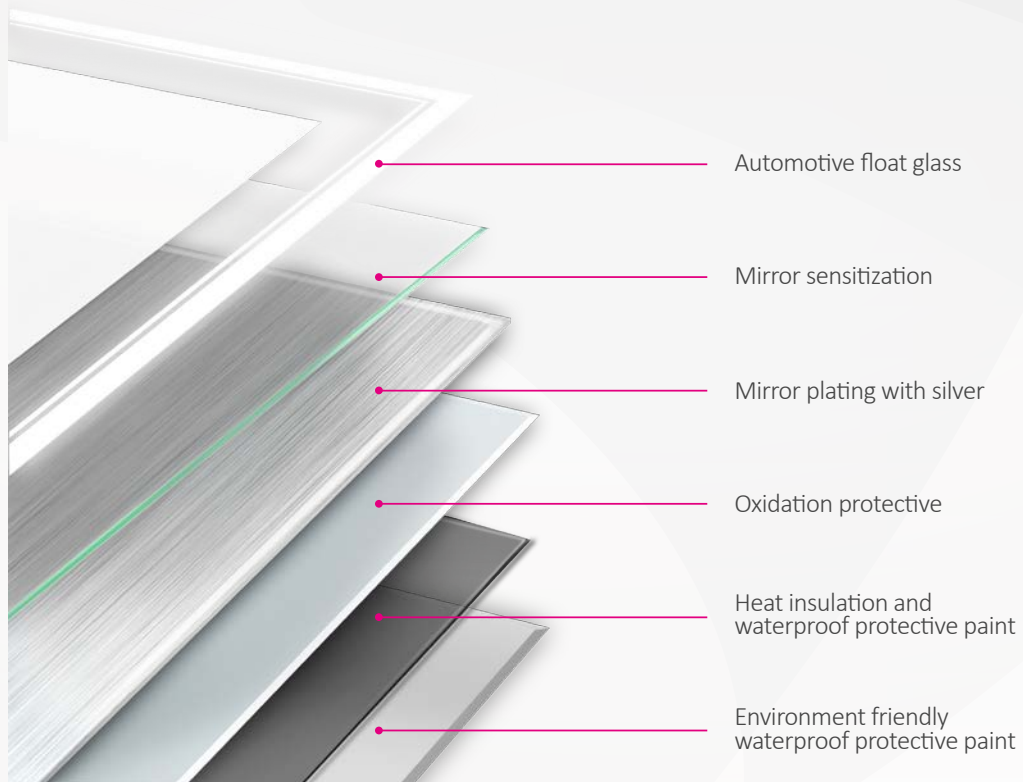

9 Safe explosion-proof

High viscosity protective film with explosion-proof glass, broken without splash, to keep you and your family safe



10 Support horizontal and vertical hanging

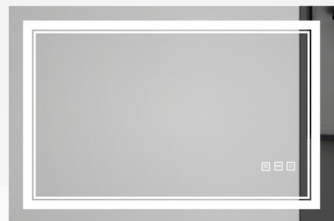

The mirror hangs horizontally



The mirror hangs vertically

11 Support hardy hole and hook, two quick installations

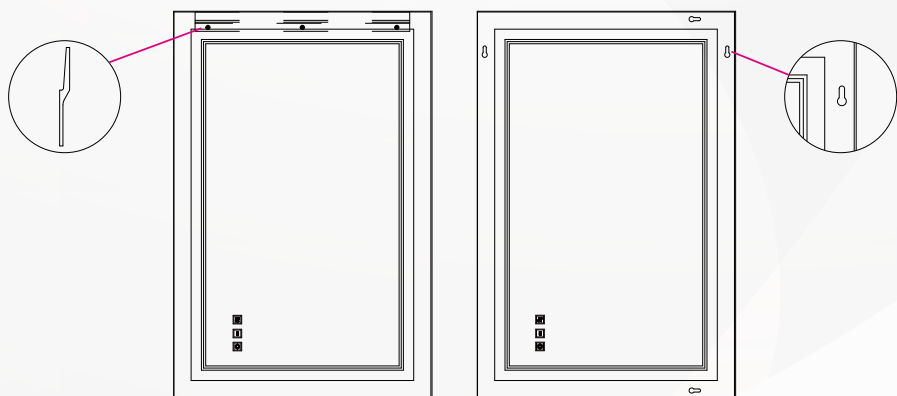

12 The mirror fits seamlessly into the wall

Product specifications

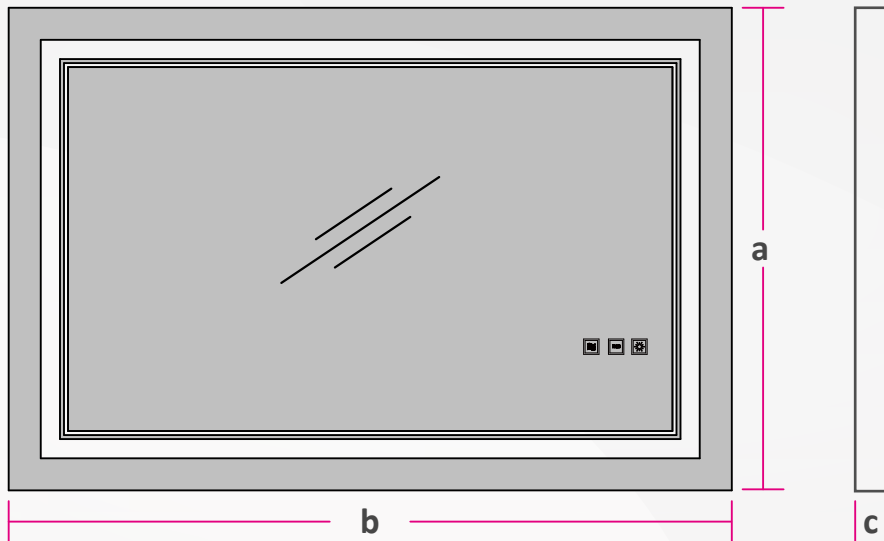

Product specifications

Model	Width (a)	Length (b)	Thickness (c)	Color temperature (K)	RGB Power (W)		RGB total power (W)	Power (W)	Defogger Power (W)						
					Red	Blue									
SC-SM2028-24W-R01-A-RGB	20"	28"	1.6"	3000K - 6000K RGB	Red	10	26	24	15						
SC-SM2432-28W-R01-A-RGB	24"	32"			Green	10									
					Blue	10									
SC-SM2436-30W-R01-A-RGB	24"	36"			Red	11.5	27	28	30						
					Green	11.5									
Blue	11.5														
SC-SM2836-32W-R01-A-RGB	28"	36"			Red	12.5	28	30	30						
					Green	12.5									
Blue	12.5														
SC-SM2028-24W-R01-B-RGB	20"	28"			1.6"	3000K - 6000K RGB	Red	13.5	29	32	30				
							Green	13.5							
Blue	13.5														
SC-SM2432-28W-R01-B-RGB	24"	32"	1.6"	3000K - 6000K RGB			Red	10	26	24	15				
							Green	10							
Blue	10														
SC-SM2436-30W-R01-B-RGB	24"	36"					1.6"	3000K - 6000K RGB	Red	11.5	27	28	30		
									Green	11.5					
Blue	11.5														
SC-SM2836-32W-R01-B-RGB	28"	36"							1.6"	3000K - 6000K RGB	Red	12.5	28	30	30
											Green	12.5			
Blue	12.5														
SC-SM2028-24W-R01-B-RGB	20"	28"			1.6"	3000K - 6000K RGB					Red	13.5	29	32	30
											Green	13.5			
Blue	13.5														

CRI	Input voltage (V)	PF
≥90	100-130V	>0.9



Defogging touch switch

RGB Lighting switch

Lighting switch

User guide of LED smart mirror

- ◆ The switch button is a light touch switch with high sensitivity
- ☑ Defogging touch switch
Button showing blue for standby, click touch button once showing white for work, long press touch button 5-8S to enter the mobile phone connection state (flash lightings)
- ☑ RGB touch button
Click touch button once to turn on the function, double-click the touch button to close, single touch to change 8 colors, long press the touch button 3S to adjust the brightness (brightness is infinitely switched from 5%-100%)
- ☑ Color temperature touch button
Click the touch button once to open, double-click the touch button to close, single touch to change 3000K- 6000K, long press the touch button 3S to adjust the brightness (steplessly switching brightness from 5%-100%)

Installation tools

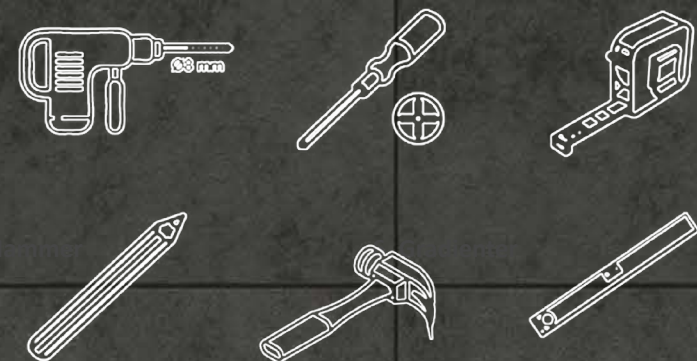

◆ Installation (hook)



1. Draw a 0.5 meter horizontal line on the wall with the gradienter

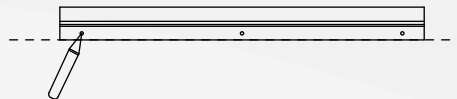

2. Use the hook to attach the horizontal line, use the pencil to draw 3 points through the screw hole

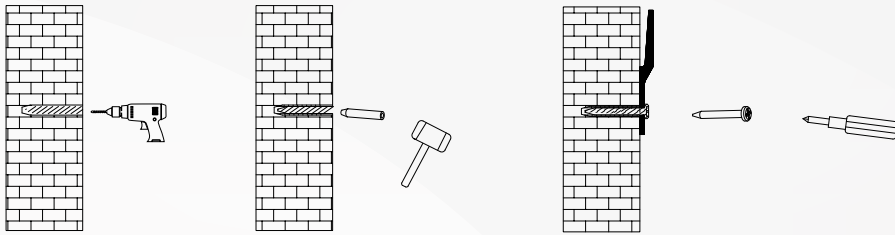

3. Drill 3 holes on the 3 points with percussion drill, and insert rubber plugs, stick the hooks on the wall and screw in the screws.

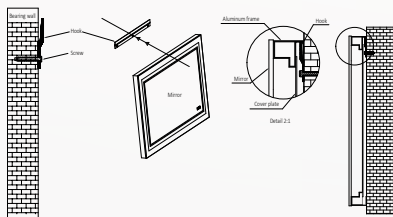

4. Hang up the mirror and two people is suggested to operate

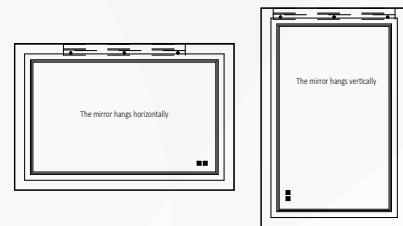

5. The mirror is close to the wall and the installation is completed

◆ Installation (hardy hole)

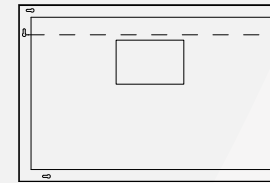

1. Measure the center distance of the two hardy holes in the frame with the measuring tape



2. According to the measured distance, use the pencil to draw 2 points on the wall

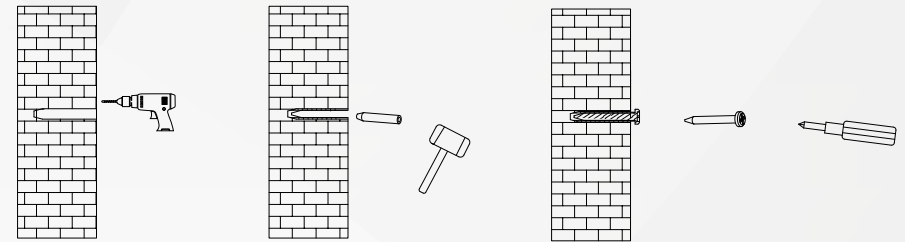

3. Drill 2 holes on the 2 points with percussion drill, and insert rubber plugs, screw in the screws.

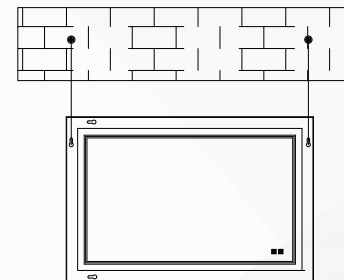

4. Hang up the mirror and two people is suggested to operate

Stick the mirror to the wall so that the frame slides into the hanging strip

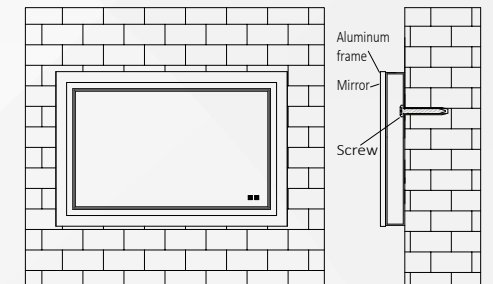

5. The mirror is close to the wall and the installation is completed



Application

Widely used in home, hotel, office, shopping mall, and other places

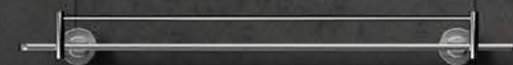



Application

Widely used in home, hotel, office, shopping mall,
and other places



Packaging diagram

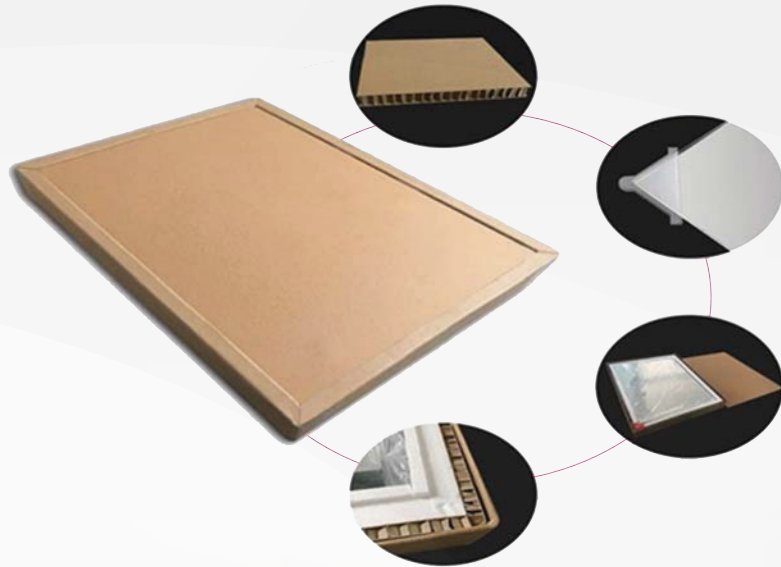

Notice



- ◆ Please read the specification first, to make sure the service environment matches the condition in the specification before using.
- ◆ Please confirm the applicable power supply before using.
- ◆ Make sure the switch of product is off before connect to the power supply to prevent electric shock.
- ◆ Operation against rules may damage your property even harm to your personal safety
- ◆ Preliminarily estimate required quantity of LED panel lights, then according to the power rating of single panel light to figure out the total power and design power supply plan.
- ◆ Dangerous high voltage, non-professionals are not allowed to maintain the products.
- ◆ If the exterior flexible cable or wire is damaged, it must exchange by the supplier, its agent or other similar qualified personnels to avoid dangers.

Model	Size (W*L*H)	Weight (G.W.)	Weight (N.W.)
SC-SM2028-24W-R01-A-RGB	23.6*31.5*4.5inch	19.21LB	13.2LB
SC-SM2432-28W-R01-A-RGB	27.5*35.4*4.5inch	25.4LB	17.6LB
SC-SM2436-30W-R01-A-RGB	27.5*39.4*4.5inch	28.7LB	19.8LB
SC-SM2836-32W-R01-A-RGB	31.5*39.4*4.5inch	33.5LB	23.2LB
SC-SM2028-24W-R01-B-RGB	23.6*31.5*4.5inch	19.21LB	13.2LB
SC-SM2432-28W-R01-B-RGB	27.5*35.4*4.5inch	25.4LB	17.6LB
SC-SM2436-30W-R01-B-RGB	27.5*39.4*4.5inch	28.7LB	19.8LB
SC-SM2836-32W-R01-B-RGB	31.5*39.4*4.5inch	33.5LB	23.2LB