

TOP-VIEW NEON

SC-TSE161628-160-NW-24V

Available colors

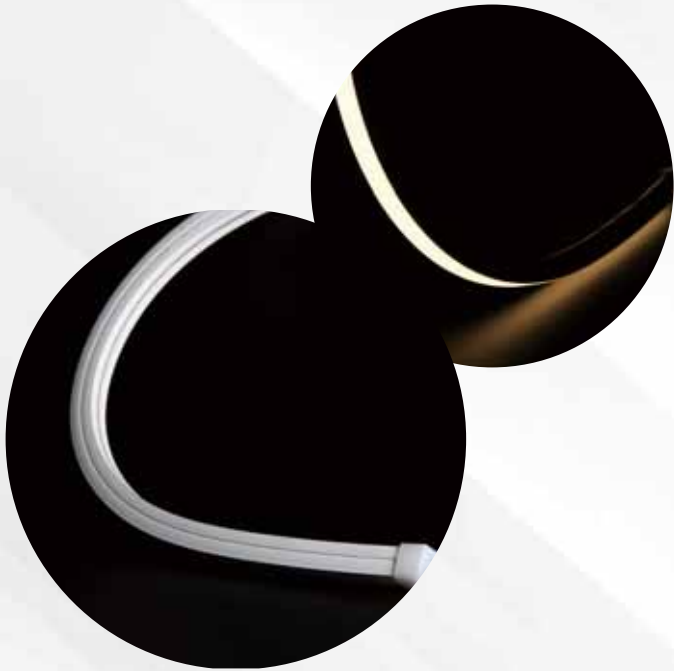



High flexibility

High flexibility, minimum bending radius can be 75MM.



Top-view

Top-view design makes dot free illumination,
uniform and soft light.

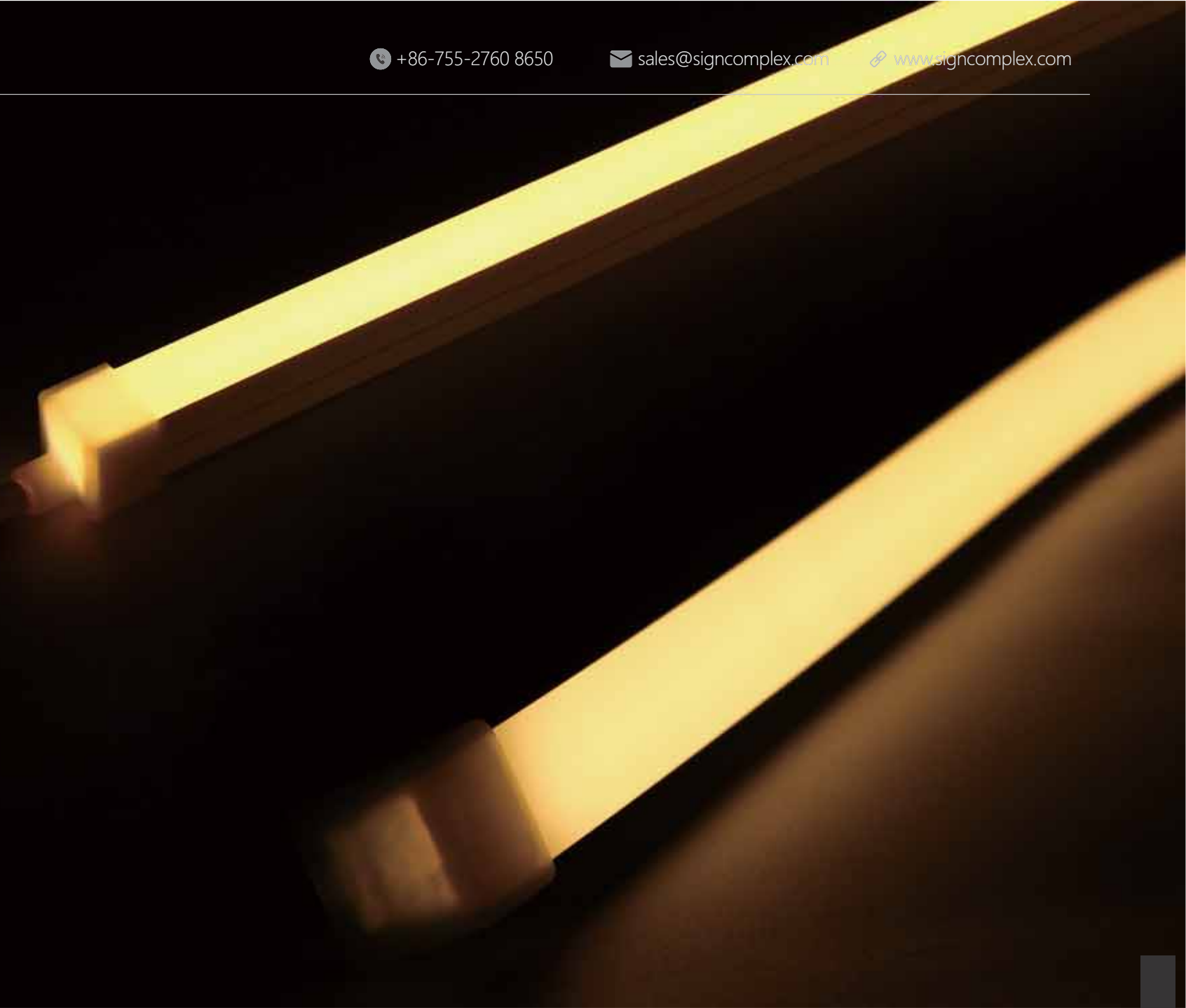

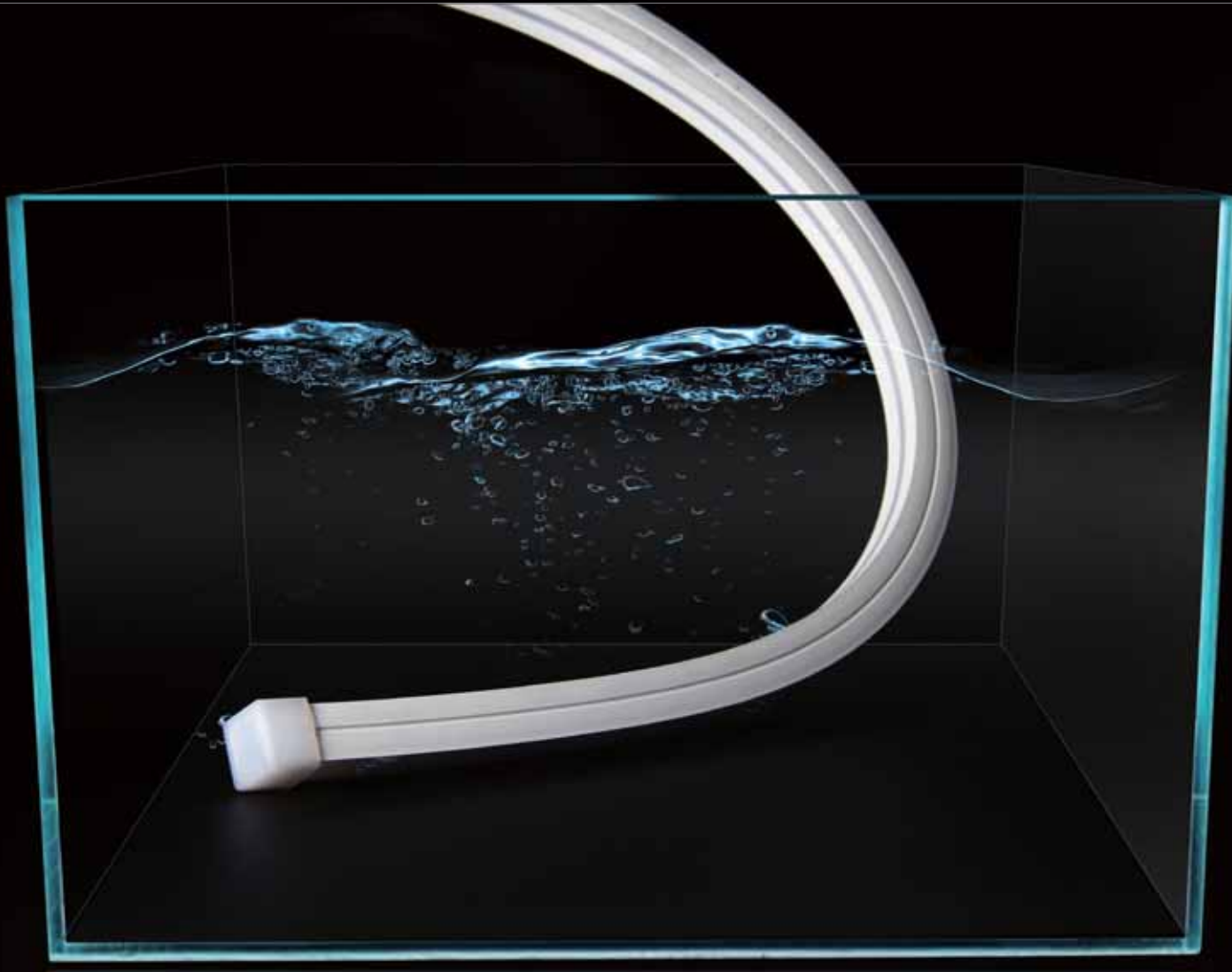

Waterproof and safer application

The product has passed CE, RoHS and other certifications, good waterproof effect, safer application.



Application

Widely used in hotels, shopping malls, furniture, cabinets, bookshelves, as decorative lighting, direct lighting or indirect lighting.



PARAMETER

Model	Wave Length & CCT Range(for LED only)		Luminous Flux (lm/M)	CRI	LED Type	LED Qty. (PCS/M)	Rated Watt (w/m)	DC Voltage (V)	Max. Length (M)	Min. Cut Length (mm)	PCB Width	IP	Beam Angle (degree)
SC-TSE161628-160 -NW-24V	WW	2800-3200K	738	83	2835	160	9.6	24	5	50	10	65	120
	NW	3800-4500K	770										
	W	6000-6500K	784										
	R	620-630nm	\	\									
	G	515-530nm											
	B	460-470nm											

ACCESSORIES

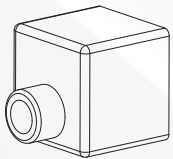

End cap with hole
2pcs/5M

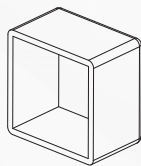

End cap without hole
2pcs/5M

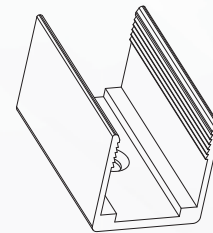

Mounting clip
20pcs/5M

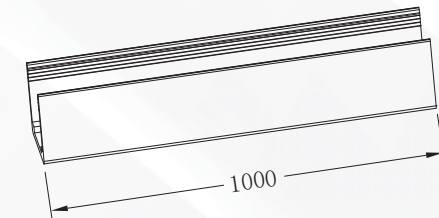

Mounting channel
optional

DIMENSIONS (unit: mm)

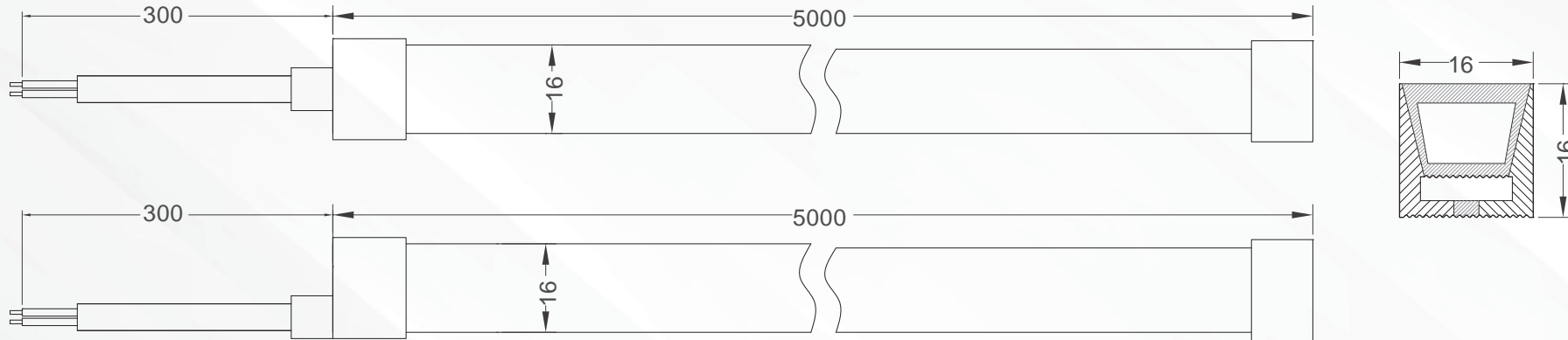

INSTALLATION DIAGRAM

Installation operation

1. Fix the clip in the place where the neon flex installed, as shown in Figure 1.

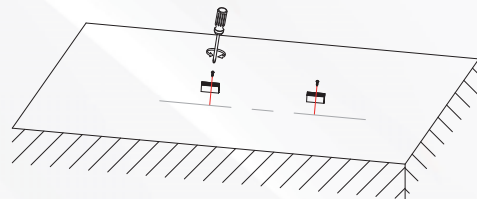

Figure 1

2. Install the neon flex into the clip, the installation is complete, as shown in Figure 2.

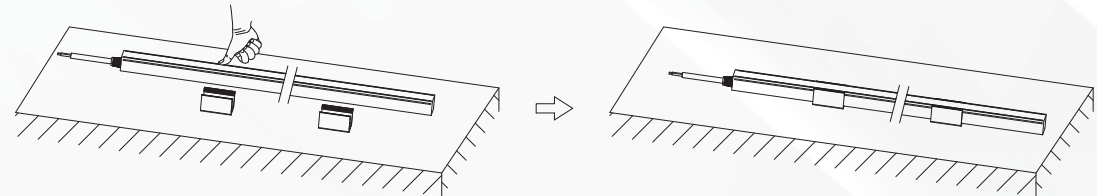
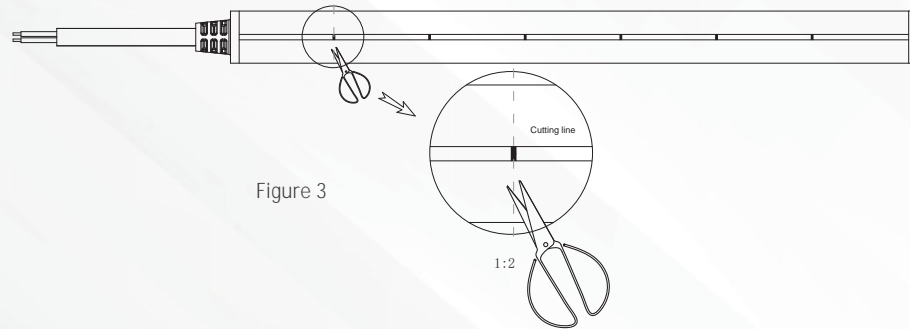

Figure 2

Installation operation

1. Cut along the cutting line with scissors, as shown in Figure 3.



2. The plug will be filled with glue, and put the neon flex into the plug, the installation is complete, as shown in Figure 4.

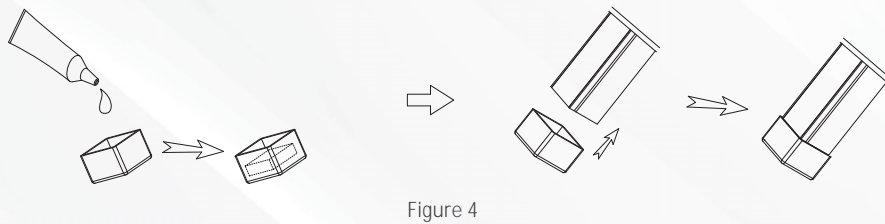

3. Cut off the adhesive on the back of the PCB to reveal the welding points, as shown in Figure 5.

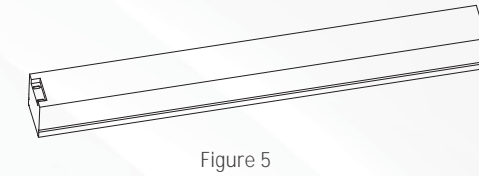

4. Use the soldering iron to solder the wire, as shown in Figure 6.

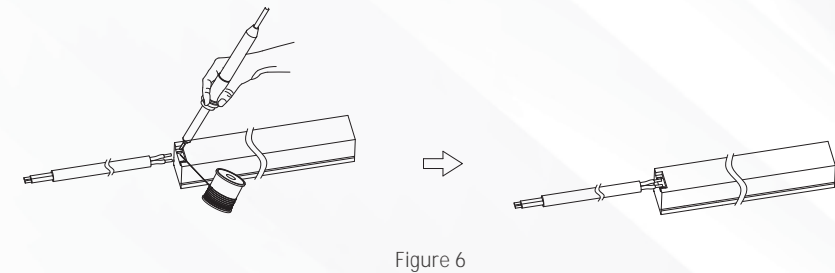

5. Put the plug encased into the line, and repeat Figure 4 gluing steps, and then insert the neon flex into the plug, the installation is complete, as shown in Figure 7.

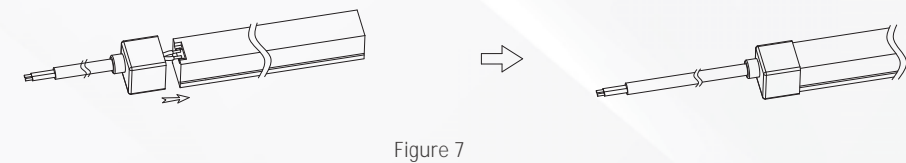

Bending direction and bending radius

SC-TSE161628-128-XX-24/SC-TSE161628-120-RGB-24:

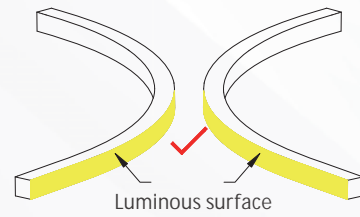
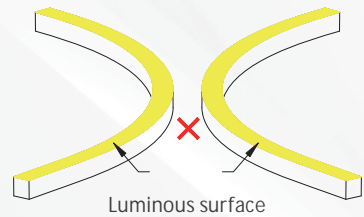
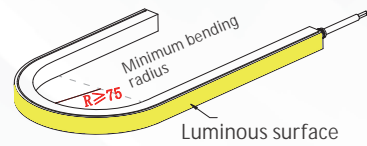
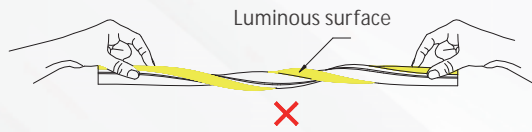

SC-TSE161628-3D-96-XX-24:

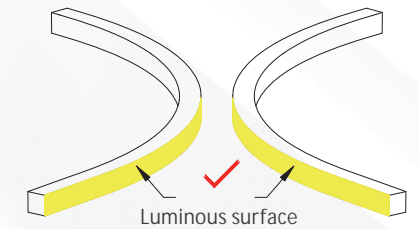
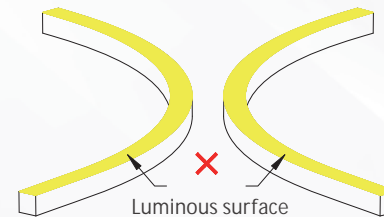
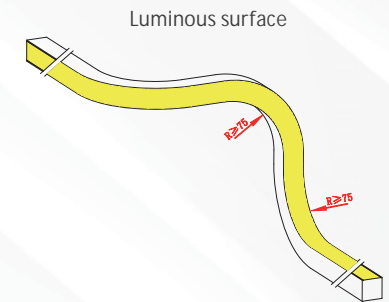
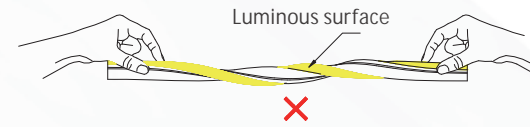

PACKAGING INFORMATION

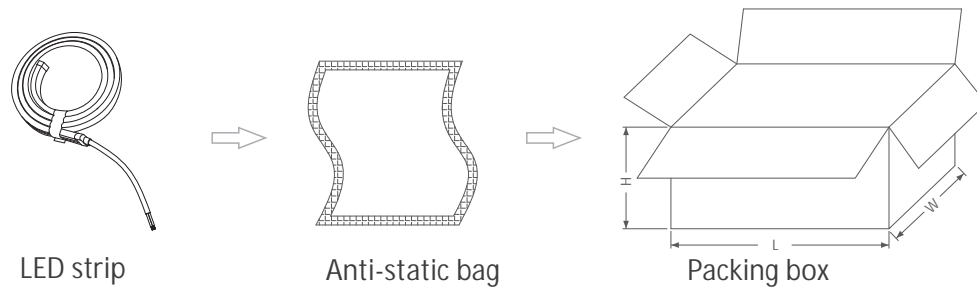

LED Strip		Anti-static Bag		Packing Box	
Part Number	Gross Weight per Reel	QTY per Carton	Gross Weight	Size(cm/inch)	
SC-TSE161628-160-WW-24	1.1KG	20	23.5KG	33cm*33cm*42.5cm 12.99"*12.99"*16.73"	

INSTALLATION REQUIREMENT



- The LED strip and accessories can't be squeezed or folded.
- PCB conductive parts can't be damaged when installation.
- Installation must conform to electrical safety standard. The LED strip can only be installed by professionals.
- Ensure power supply transform operating load with transformer.
- When install on metal or conductor surface, insulation protection need to be provided to the contact area.
- Observe positive and negative polarity, ensure correct connection to avoid damaging LED strip.
- When installing, please prevent static electricity.
- The product need anti-corrosion environment, such as, avoiding damp, water drop or other adverse elements.