

15*15mm IP67 Top-View Silicon Neon Flex

SC-TSE1528-3D-96-XX-24

SC-TSE1528-128-XX-24

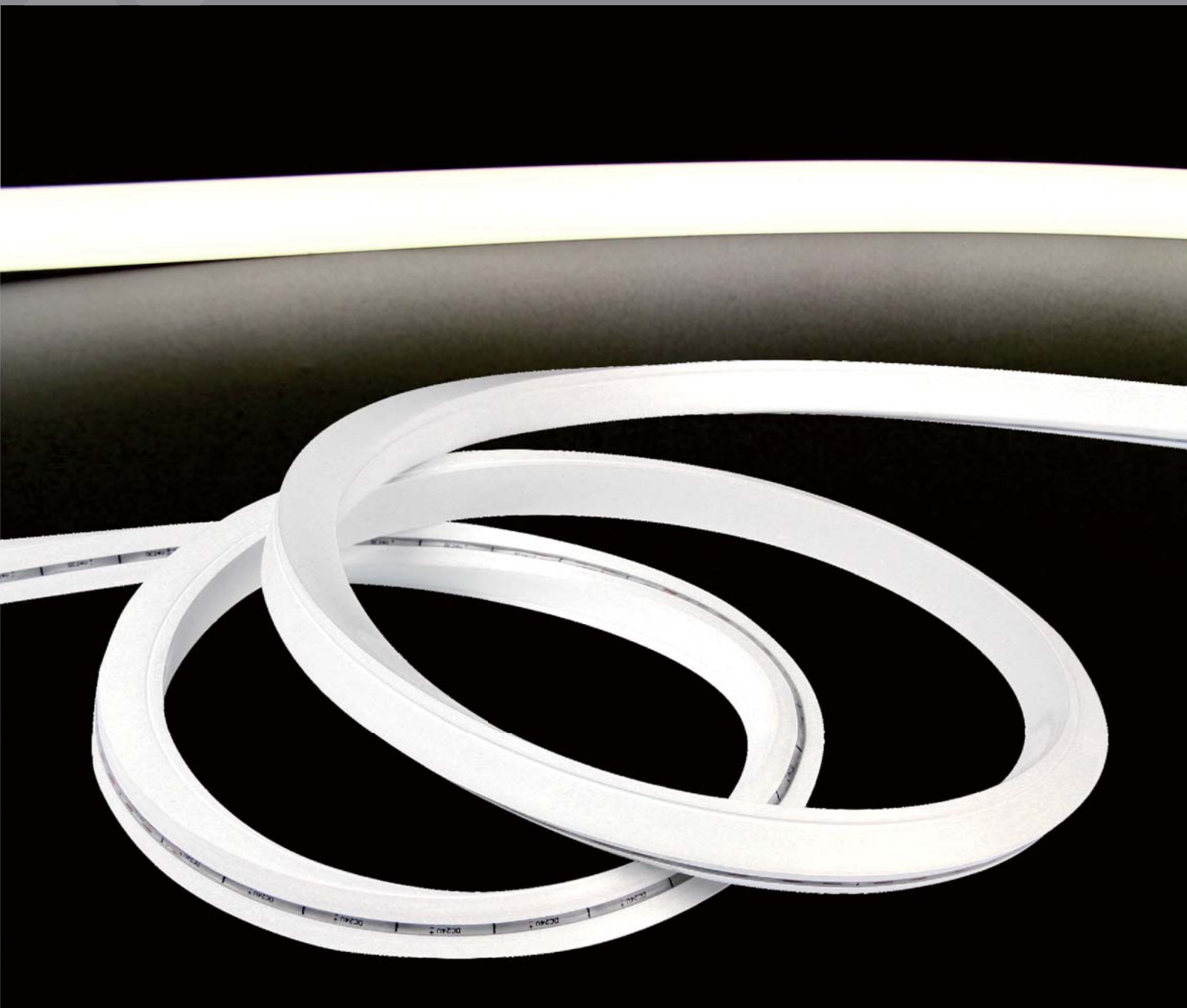

Available colors



Features

- High brightness 2835 SMD LED (single color & RGB color)
- CRI80 or CRI90
- 15*15mm Dimension & Minimum bending radius can be 75mm
- Top-View/ Dot-free illumination and high uniformity
- UV-resistant high quality silicon material
- Extrusion process & injection moulding for end cap make IP67
- Special window-design makes cutting convenient and easy
- Providing accessories for cutting and installation

Technical parameters

Model	Wave length&CCT Range(for LED only)	Luminous Flux (lm/M)	PCB Width (mm)	Max.Length (M)	Min.Length (mm)	LED Type	DC Voltage (V)	LED Qty. (PCS/M)	Rated Watt (W/M)	CRI	IP
SC-TSE1528-3D-96 (3-direction bent)	WW 2800-3200K	936	8	5	20.83	2835	24	96	14.4	80	67
	NW 3800-4500K	1001									
	W 6000-6500K	1003									
SC-TSE1528-128-XX	WW 2800-3200K	845	8	5	62.5	2835	24	128	9.6	80	67
	NW 3800-4500K	890									
	W 6000-6500K	875									
	R 620-630nm	225	8	5	62.5	2835	24	128	9.6	80	67
	G 520-530nm	783									
	B 465-475nm	142									
SC-TSE1528-120-RGB	RGB N/A	287	8	5	50	2835RGB	24	120	14.4	80	67
	R 620-630nm	73									
	G 515-530nm	198									
	B 460-470nm	32									

Note:

1. The above data is the testing result of 1M standard product;
2. The power and lumens of output data can be vary up to ±10%;
3. The above parameters are all typical values

*Note: There will be CCT deviation for white color after the silicon extrusion, below is the table for your reference.

Part number	Color	CCT for LEDs(real tested data)	CCT for IP65(real tested data)
SC-TSE1528-3D-128-24V	Warm White	2983	2845
	Natural White	4100	3739
	White	6801	6070

Light Distribution

Single Color

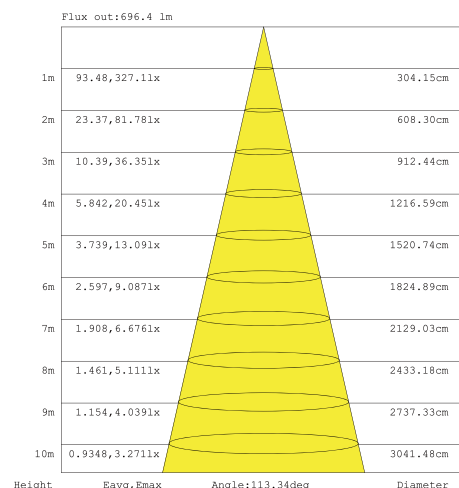
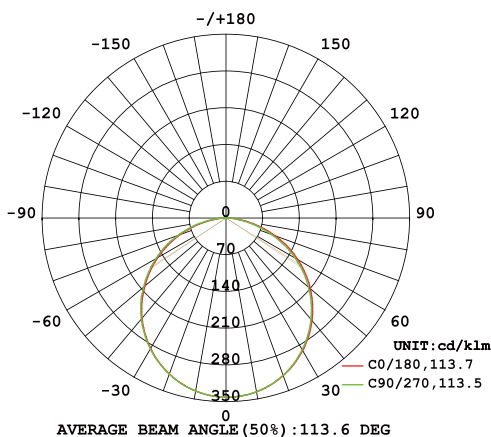

Circuit Schematic(DC 24V)
Single Color

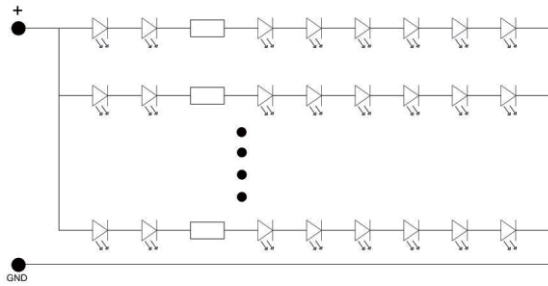

RGB

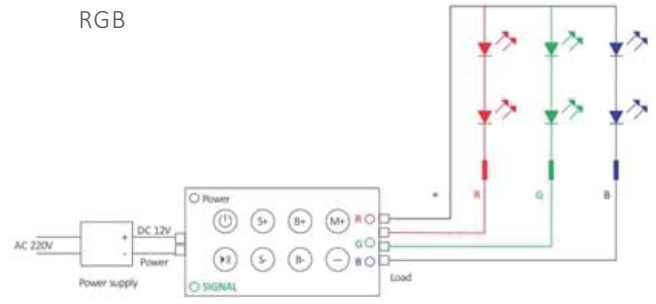

Connection diagram for RGB: as figure 1, use power cabinet(waterproof, moisture proof, dust proof)the cabinet can hold one or more control powers.

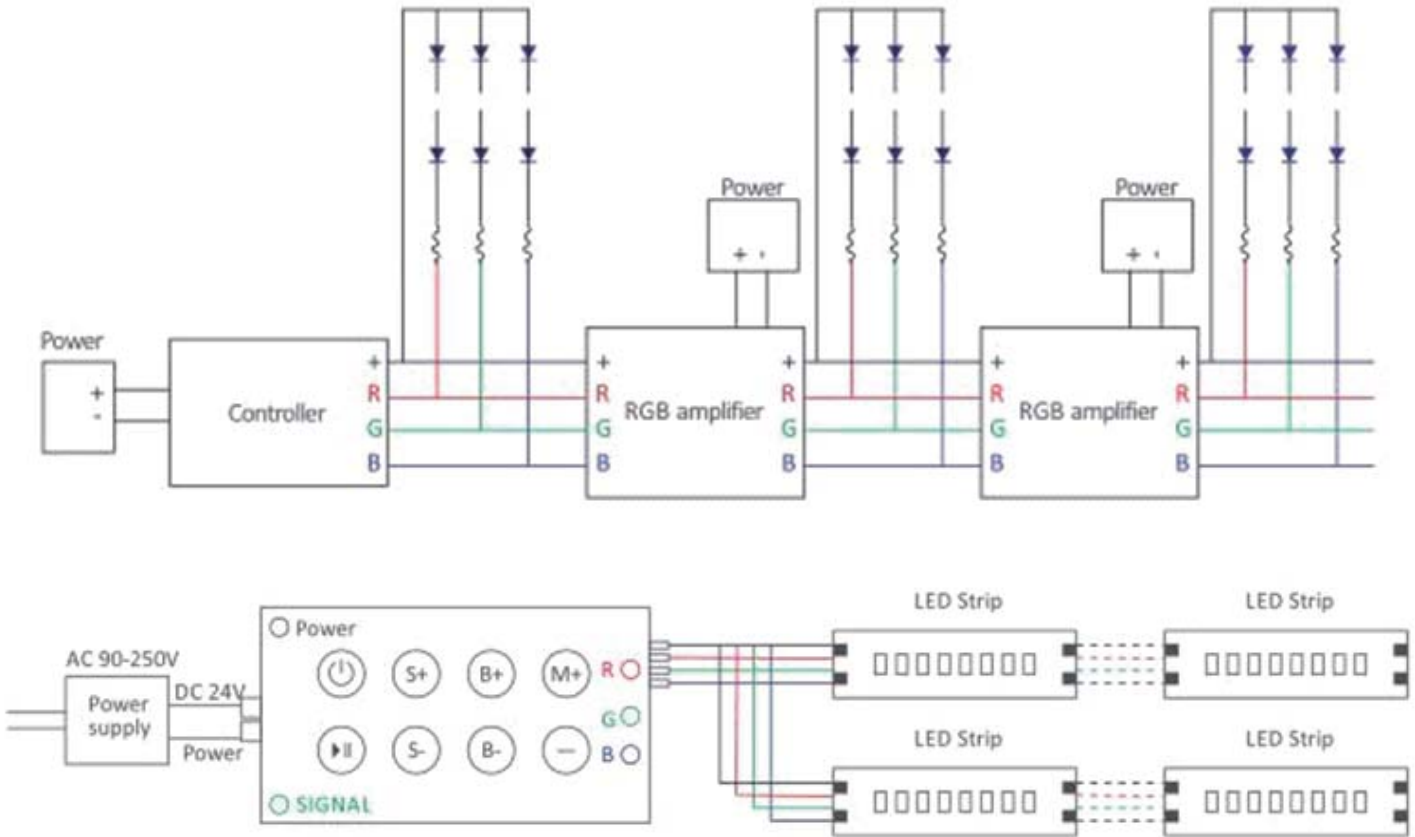

Dimensions (unit: mm/inch)

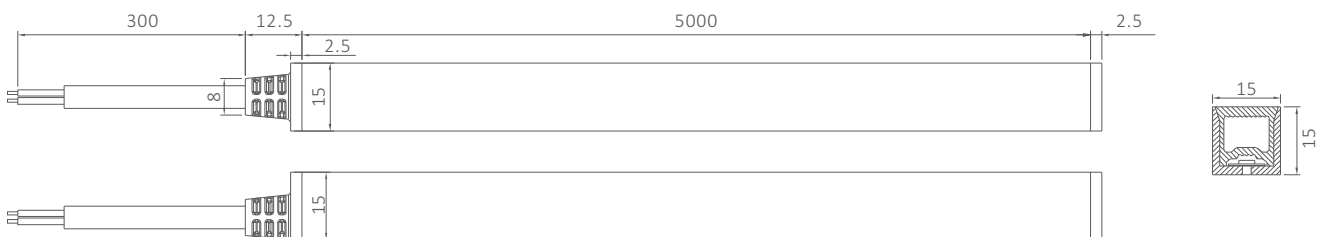

Accessories

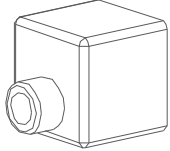
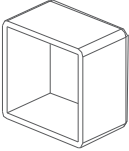
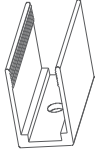
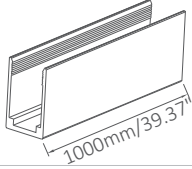
Name	End cap with hole	End cap without hole	Mounting Clip	Mounting Channel(1M)
Picture				
Quantity	2pcs/5M	2pcs/5M	20pcs/5M	optional

Installation diagram

Installation operation

1. Fixed the clip in the place where the neon flex installed, as shown in Figure 1

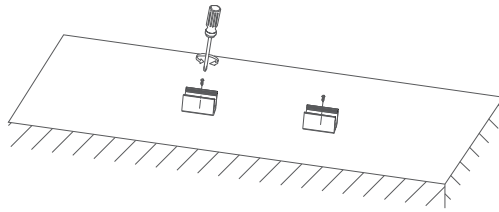

Figure 1

2. Install the neon flex into the clip, the installation is complete, as shown in Figure2

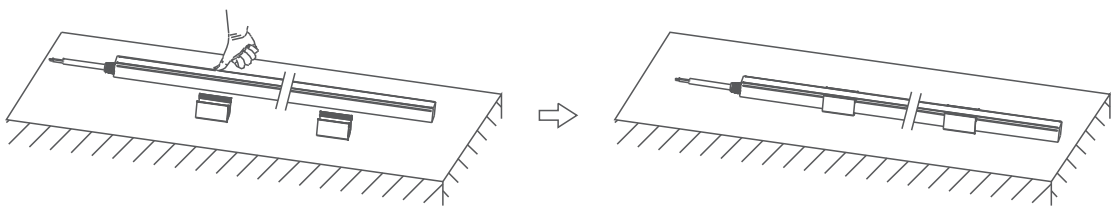

Figure 2

Cutting operation

1. Cut along the cutting line with scissors, as shown in Figure 3.

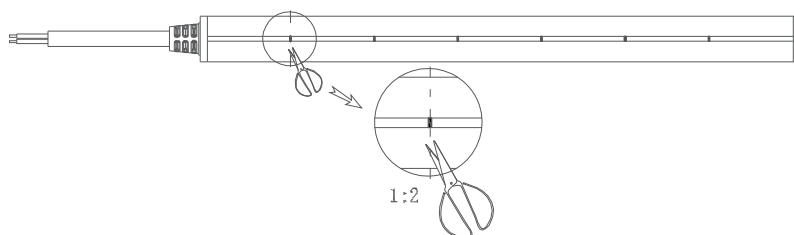

Figure 3

2. The plug will be filled with glue, and put the neon flex into the plug, the installation is complete, as shown in Figure 4:

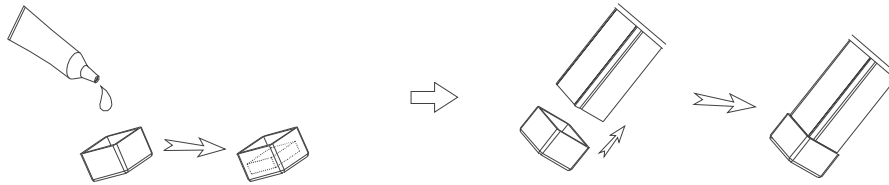

Figure 4

3. Cut off the adhesive on the back of the PCB to reveal the welding points, as shown in Figure 5

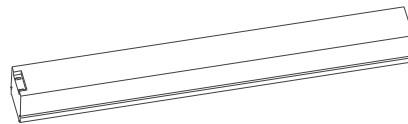

Figure 5

4. Use the soldering iron to solder the wire, as shown in Figure 6

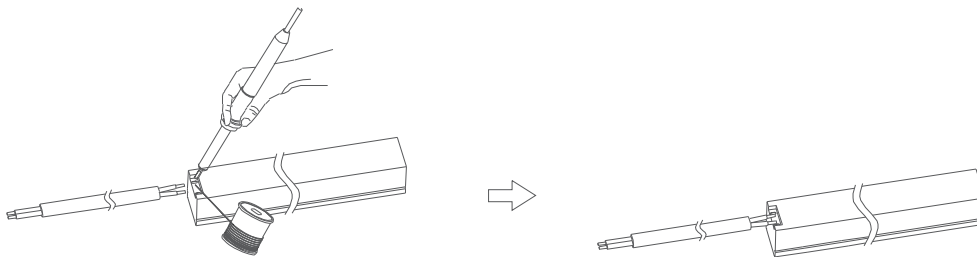

Figure 6

4. Put the plug encased into the line, and repeat Figure 4 gluing steps, and then insert the neon flex into the plug, the installation is complete, as shown in Figure 7

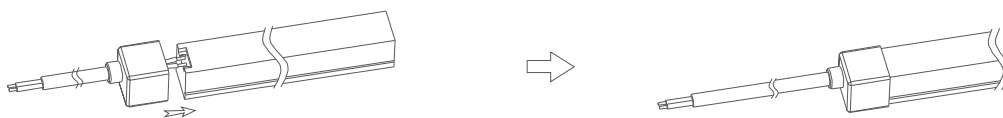
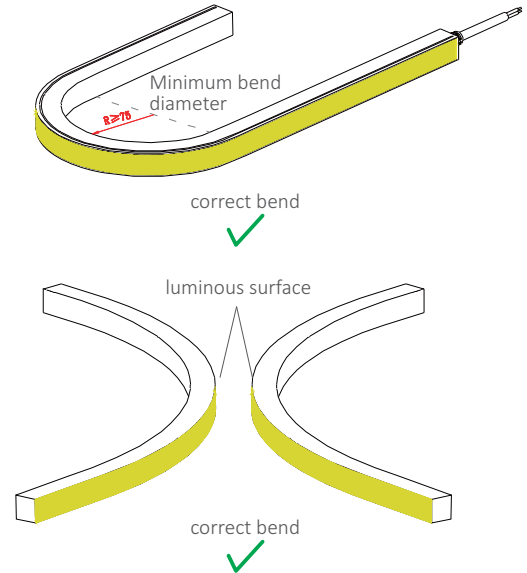
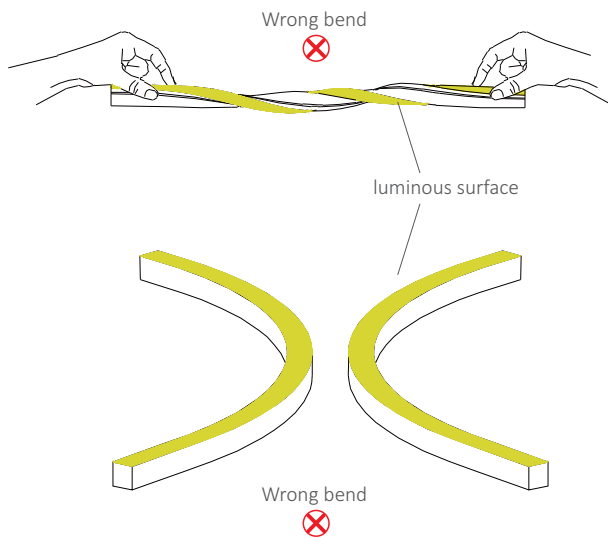

Figure 7

Bending direction and bending radius

SC-TSE1528-128-XX-24/SC-TSE1528-120-RGB-24



SC-TSE1528-3D-96-XX-24

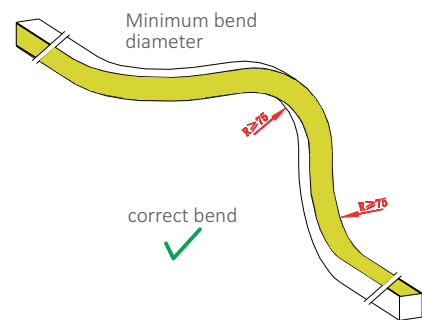
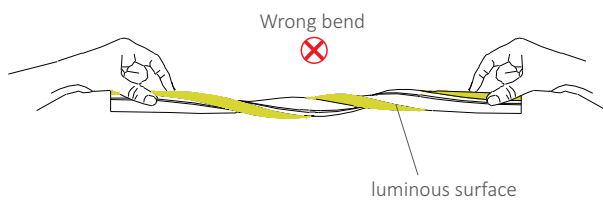

SC-TSE1528-3D-96-XX-24 Meet two types of bending

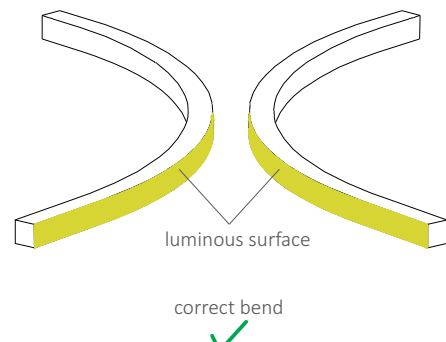
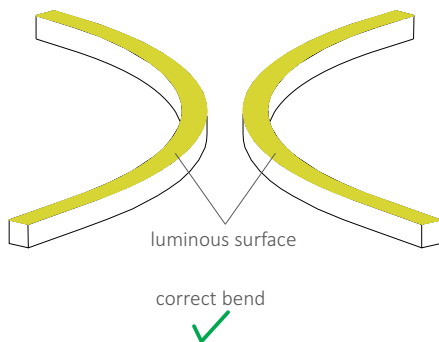

Packaging information

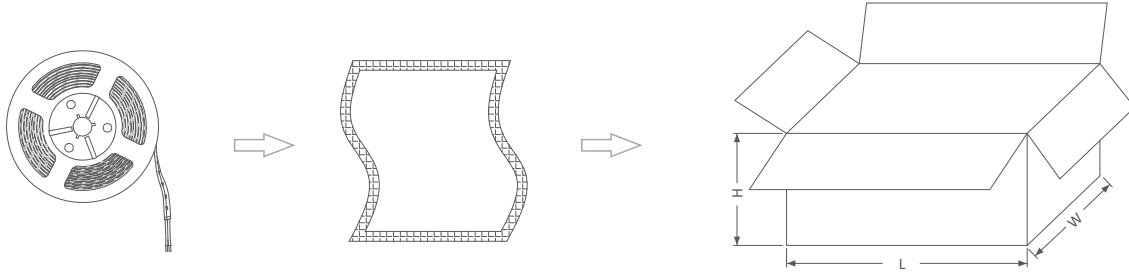

LED strip+accessories	Anti-static bag	Packing Box		
Part Number	Gross Weight per Reel	QTY per Carton	Size(cm/inch)	Gross Weight
SC-TSE1528-3D-96-XX-24V	1.55Kg	10 Reels	59cm*32.5cm*21.1cm 23.33"*12.79"*8.3"	16.22Kg
SC-TSE1528-128-XX-24V	1.55Kg	10 Reels	59cm*32.5cm*21.1cm 23.33"*12.79"*8.3"	16.22Kg
SC-TSE1528-120-RGB-24V	1.55Kg	10 Reels	59cm*32.5cm*21.1cm 23.33"*12.79"*8.3"	16.22Kg

Application

1. Outdoor contour/boundary lighting

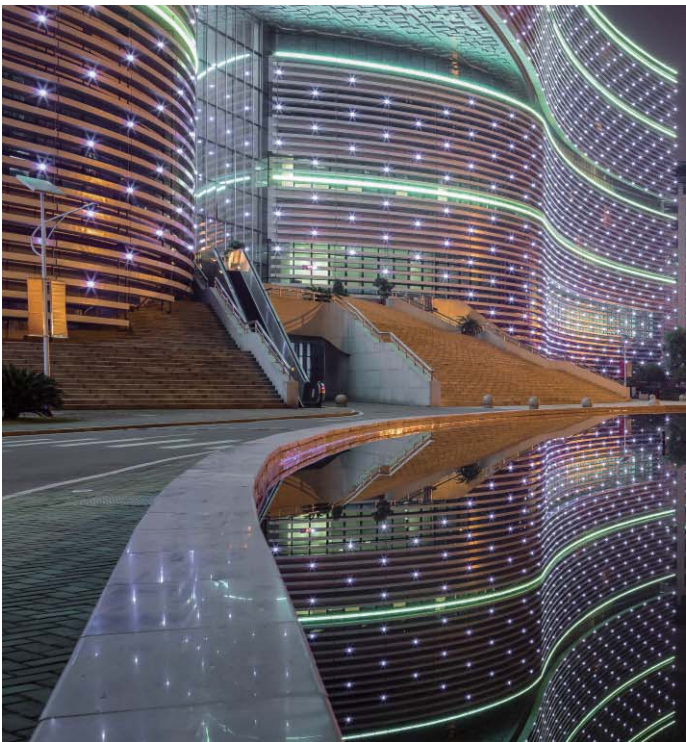

2. Building contour decoration lighting



Yijia Industrial Park, Fuqian Road, Guanlan Town, LongHua, Shenzhen, Guangdong, China

Tel:+86-755-27608650
 Fax:+86-755-27608651
www.signcomplex.com
sales@signcomplex.com