

SC-SSE0628-128-XX-24V SC-SSE0628-120-RGB-24V



Available colors



Features

- White color version adopt 2835 high brightness LED, CRI 80 and CRI 90 both available
- RGB version adopt sideview 2835RGB LED for perfect color mixing and lighting effect
- Mini size 6mm*11mm with high flexibility, Minimum bending radius can be 30MM
- Side-view design makes dot-free illumination and high uniformity
- High quality silicon material, extrusion process makes IP67
- Special window-design makes cutting convenient and easy
- Providing accessories for cutting and installation

Technical parameters

Model	Wave Length & CCT Range(for LED only)	Luminous Flux (lm/M)	CRI	LED Type	LED Qty. (PCS/M)	Rated Watt (W/M)	DC Voltage (V)	Max. Length (M)	PCB Width (MM)	IP	
SC-SSE0628-128-XX-24	WW	2800-3200K	525	80	2835	128	9.6	24	5	8	67
	NW	3800-4500K	540								
	W	6000-6500K	550								
	R	620-630nm	/	/							
	G	515-530nm	/	/							
B	460-470nm	/	/								
SC-SSE0628-120-RGB-24	RGB	N/A	/	/	2835	120	14.4	24	5	8	67

* Note: There will be CCT deviation for white color after the silicon extrusion, below is the table for your reference.

Part number	Color	CCT for LEDs(real tested data)	CCT for IP65(real tested data)
SC-SSE0628-128-WW-24V	WW	2974K	2707K
SC-SSE0628-128-NW-24V	NW	4065K	3631K
SC-SSE0628-128-W-24V	W	6354K	5238K

Dimensions (unit: mm)

SC-SSE0628-128-XX-24

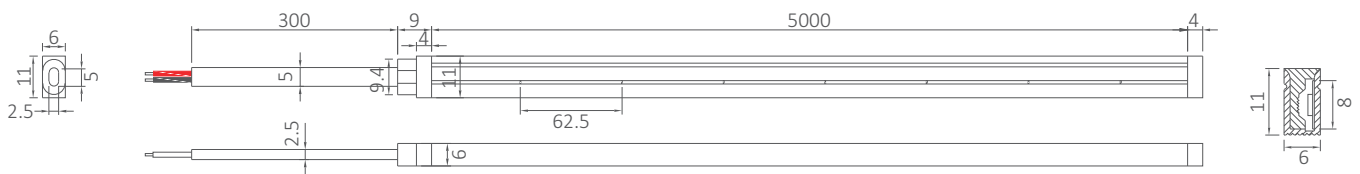

SC-SSE0647-120-RGB-24

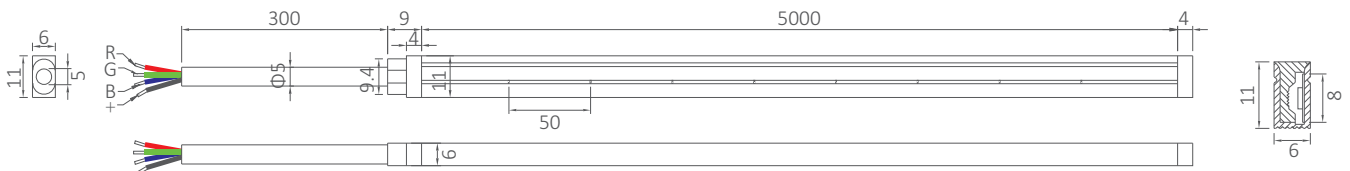

Accessories

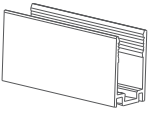
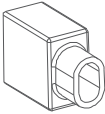
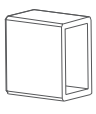
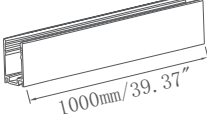
Name	Mounting Clip	End cap with hole	End cap without hole	Mounting Channel
Picture				
Quantity	20pcs per 5M	2pcs per 5M	2pcs per 5M	optional

Installation diagram

- First fix the fixing booth to the place where you are going to install the led strip, as shown in Figure 1.

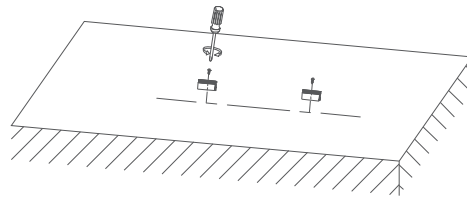

figure 1

- Install the led strip into the fixing booth, the installation is complete, as shown in Figure 2

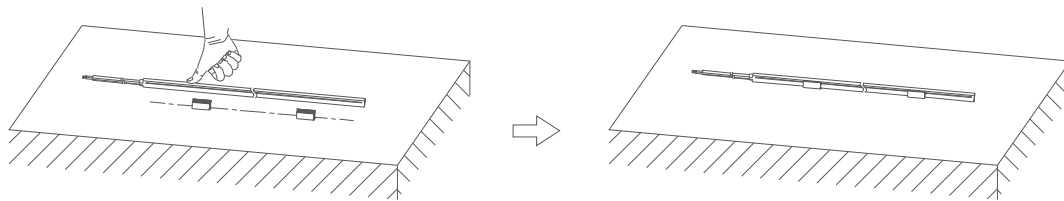

figure 2

Operation editing

- Use scissors to cut along the cut line, as shown in Figure 3.

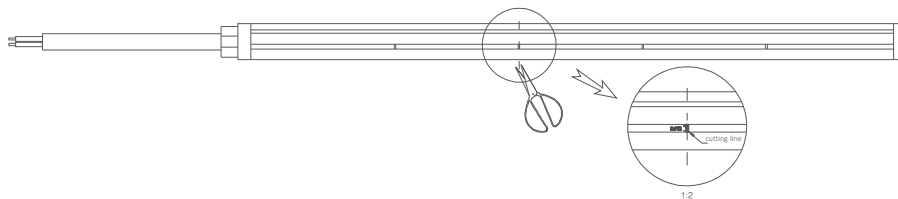

figure 3

- Infuse the plug with glue and insert the led strip into the plug, the installation is complete, as shown in Figure 4.

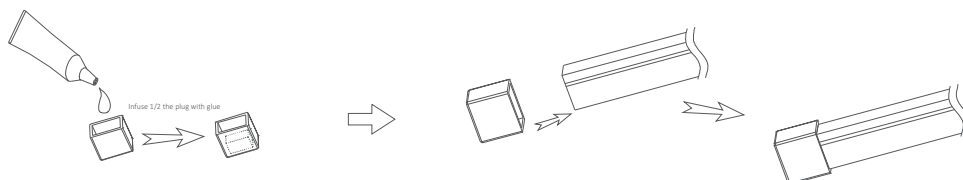

figure 4

- First cut off the glue on the back of the PCB to expose the bonding pad, as shown in Figure 5.



figure 5

- Use the soldering iron to weld the wire to the led strip bonding pad, as shown in Figure 6.

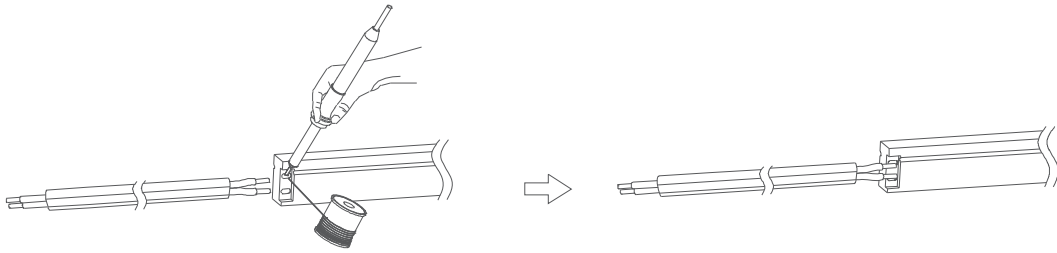

figure 6

- Put the plug on the line, and repeat the step of glue in Figure 4, then foist the led strip into the plug, finally the installation is complete, as shown in Figure 7

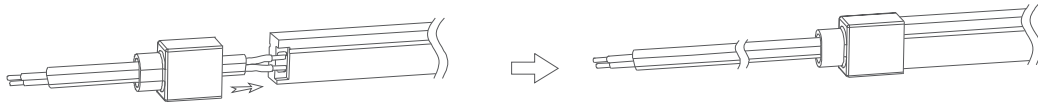
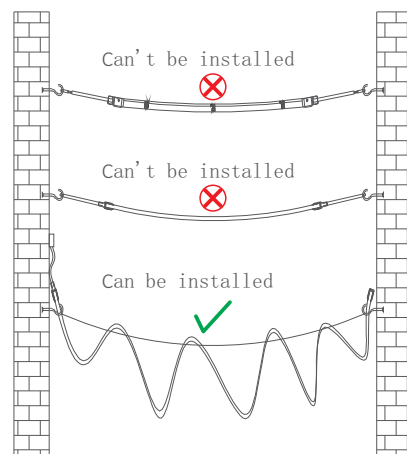
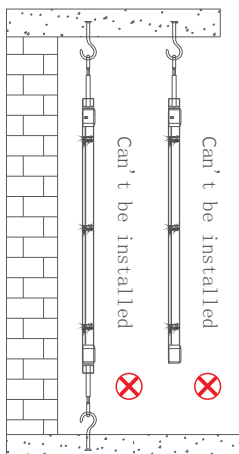
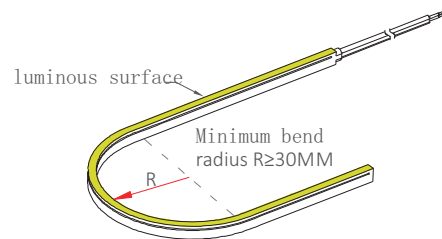
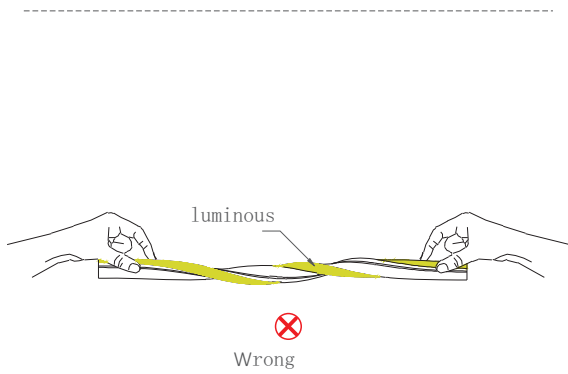
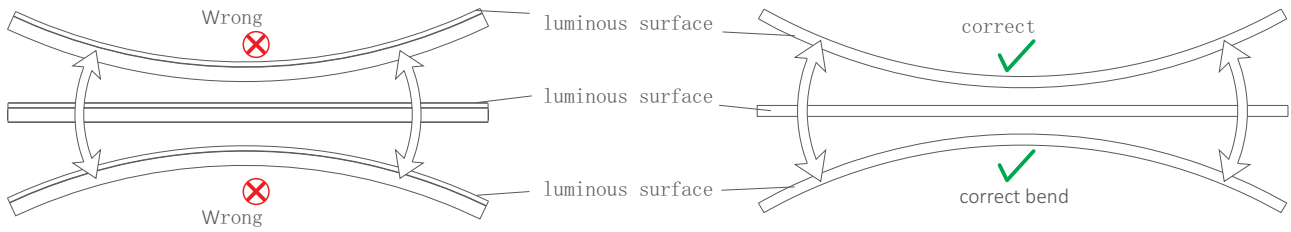

figure 7

Installation Precautions





Packaging information

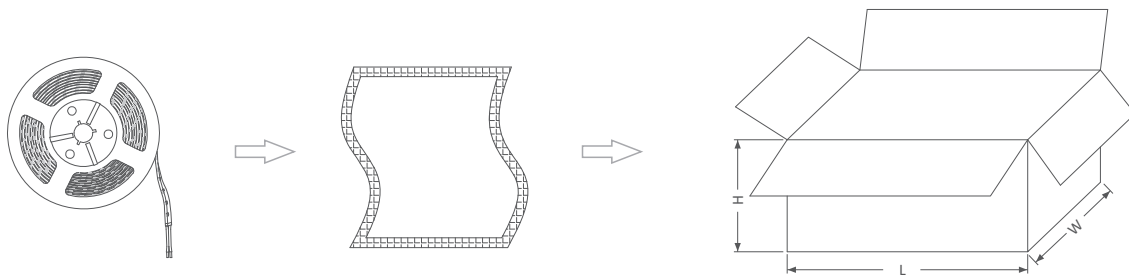

LED strip+accessories	Anti-static bag	Packing Box		
Part Number	Gross Weight per Reel	QTY per Carton	Gross Weight	Size(cm/inch)
SC-SSE0628-128-XX-24V	0.470Kg	40 Reels	19.6Kg	59cm*32.5cm*21.1cm
SC-SSE0628-120-RGB-24V	0.507Kg	40 Reels	21.08Kg	23.33"*12.79"*8.3"

Installation requirement

- Install the LED strip on flame-retardant surface, thickness of wood and material exceed 2mm;
- Please read the specification first, to make sure the service environment matches the conditions in the specification before using;
- The LED strip and other accessories can't be extruded and folded;
- The conducting components of PCB can't be damaged;
- Installation of LED strip must comply with electrical safety standard. Only professionals can install the LED strip;
- Install the strip according to correct positive and negative polarity, otherwise the strip will be damaged;
- For safety, recommend parallel connection; ensure power supply operate load with transformer;
- Cut LED strip according to Logo on the LED strip;
- When install on the metallic surface or conductive surface, deal the touch area with insulation;
- Please pay attention to preventing electrostatic during installation. The product can only be used in corrosion-proof environment, which avoid damp, water drop or other disadvantage elements.
- Serial connection can't exceed the max. length;
- Cut LED strip according to the mark logo.



Yijia Industrial Park, Fuqian Road, Guanlan Town, LongHua, Shenzhen, Guangdong, China

Tel:+86-755-27608650
 Fax:+86-755-27608651
www.signcomplex.com
sales@signcomplex.com

Application

- Stage lighting
- Lighting for festivals, events, exhibitions
- Signboard backlight
- Path contour lighting
- Landscape decoration lighting, etc